

TECHNOLOGY IN MOTION

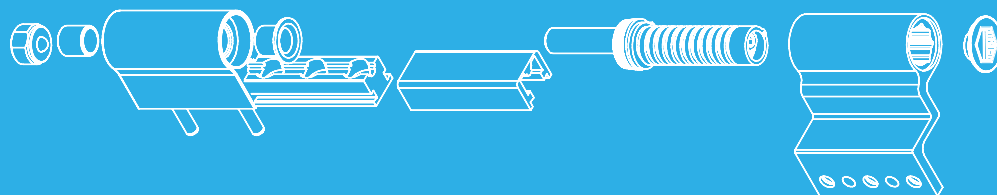

# MACO PRO-DOOR

DOOR HINGES

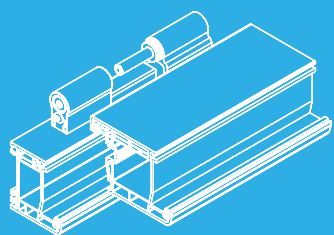

Door hinge T100 R



## Installation instructions for T100 R door hinge

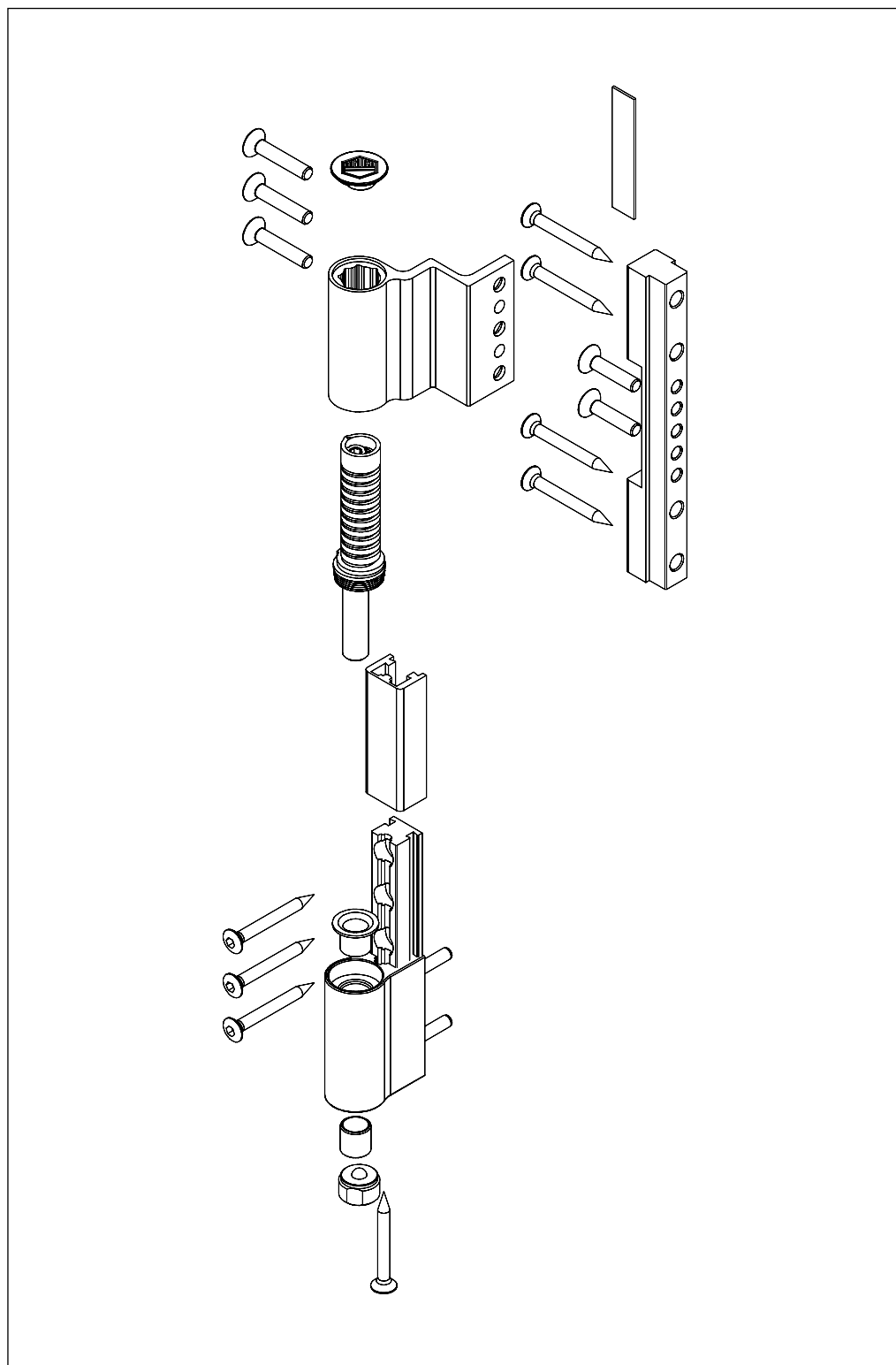



## Setting the drilling jig

Select the correct distance for positioning the cylinder pins from the table at the end of the installation instructions according to the profile used. Press the cylinder pins in from below at both sides of the drilling jig.

Make sure that the correct screw-on strip is fastened to the drilling jig (cf. item 13 butt hinge plate) for inserting into the Eurogroove - 16 or 20 mm.

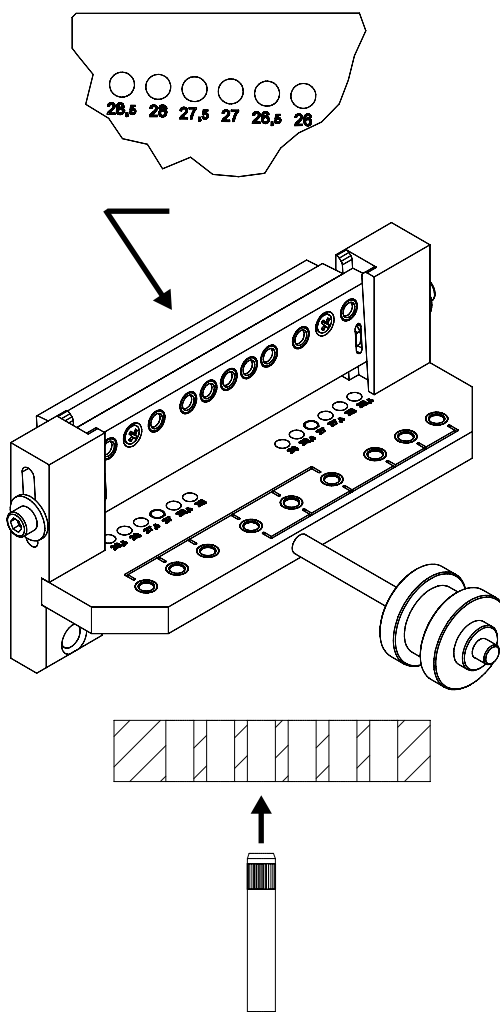



## Installing the drilling jig

Align the frame sash combination; lift the sash (1) and place the drilling jig into the hardware groove (2); adjust the height of the drilling jig to the correct axis dimension (3); place both down onto the cover frame (4) and clamp the drilling jig firmly (5).

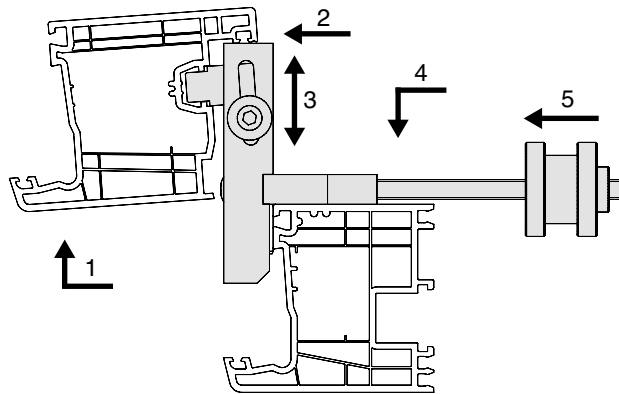

2

Drill  $\varnothing 5.5$  holes (pay attention to left or right stop, drill only 6 holes on the frame).

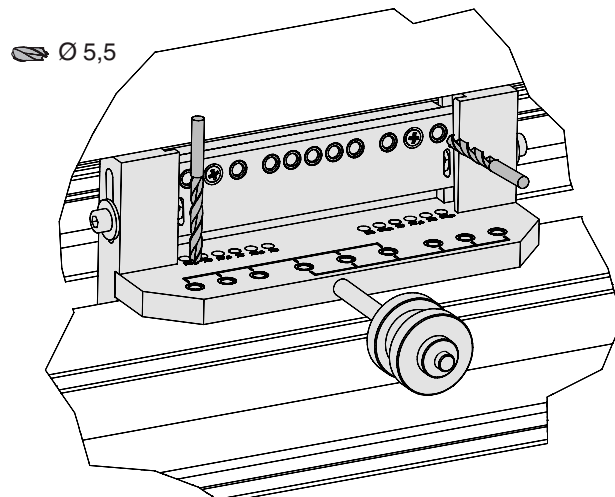

3



## Installing the sash component

Cut the overlap gasket at the sash below the hinge.

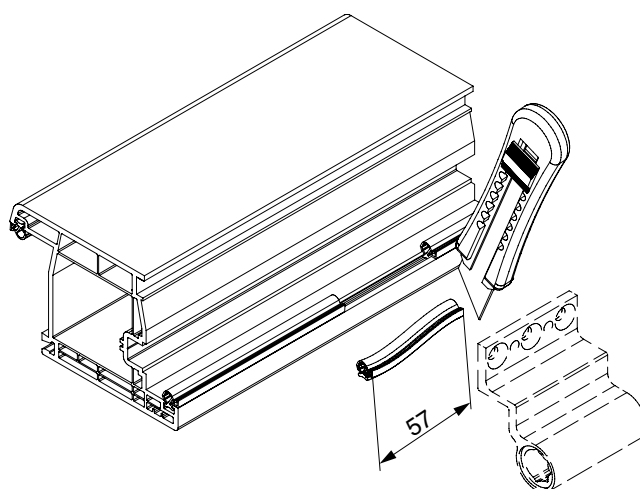

4

Insert the sash component and fasten using 4 mm Allen key (3-7 Nm depending on profile structure). Apply seal to the sash component where the seal is interrupted.

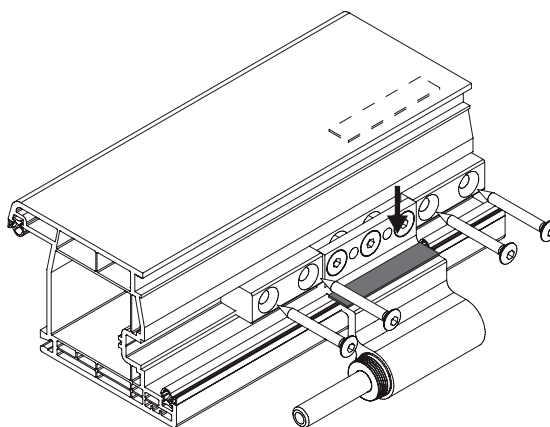

5



## Installing the axis pin

Use a rubber hammer to insert the eccentric bushing with pre-mounted support ring and axis into the sash component.

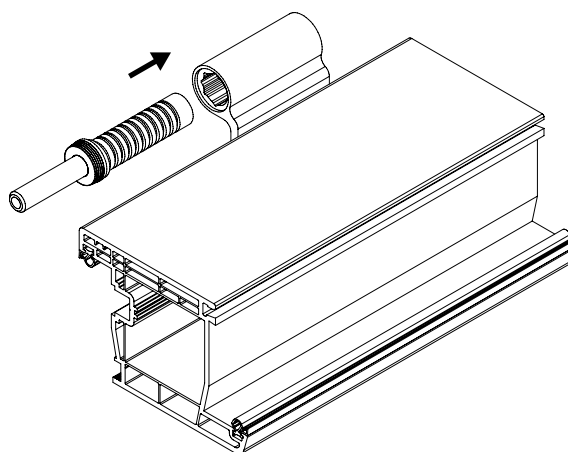

6

Eccentric bushing at zero position (4 mm Allen key)

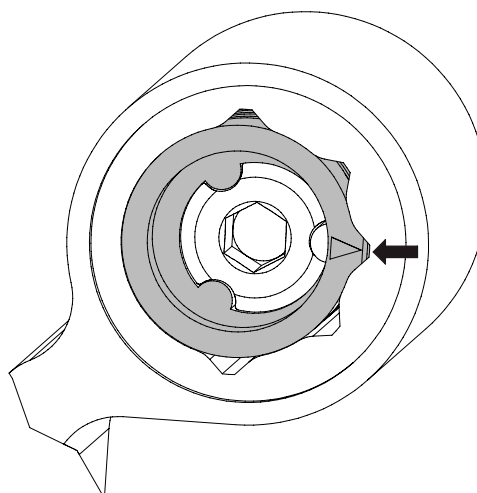

7



## Installing the frame component

Clip in the cover plug.

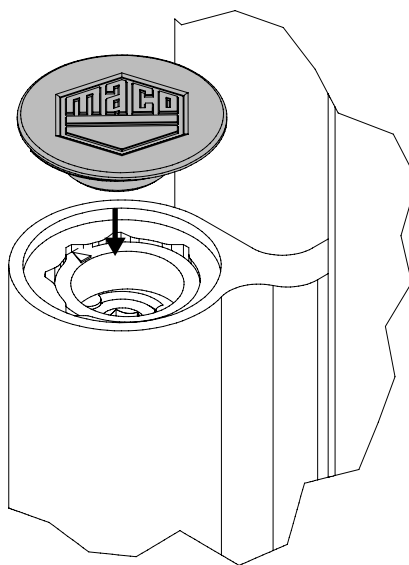

8

Insert the frame component and fasten using 4 mm Allen key (3-7 Nm depending on profile structure).

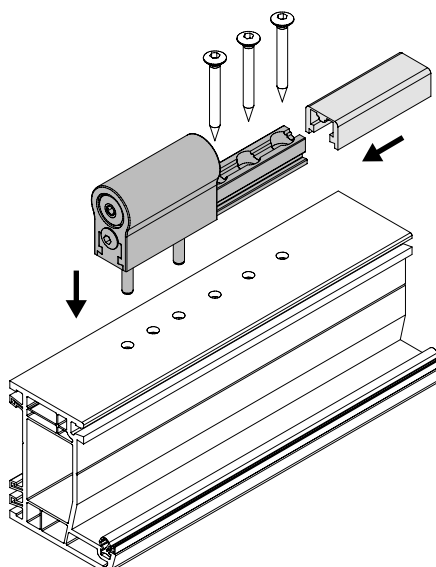

9



## Sash installation

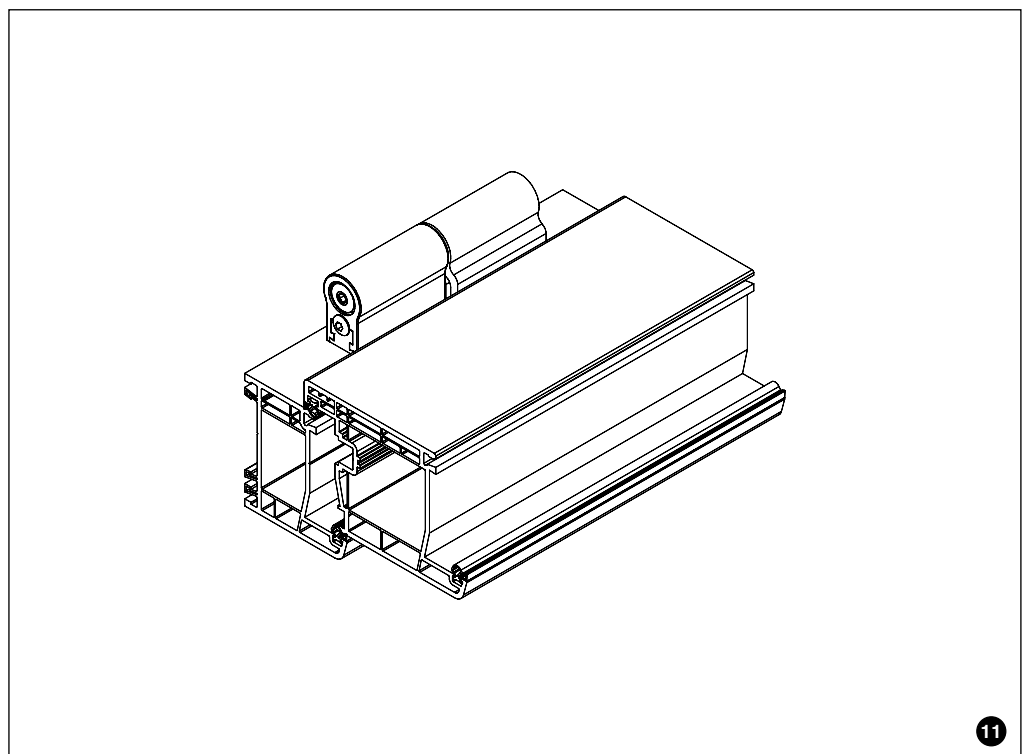
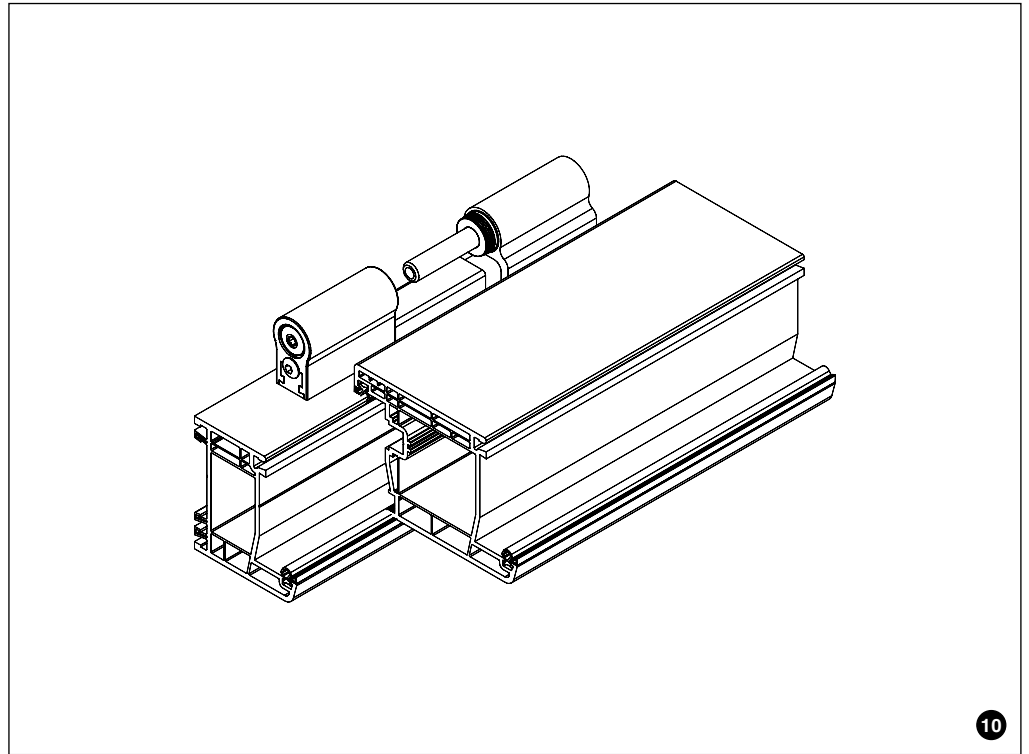





## Sash installation and disassembly (one-man installation)

To facilitate insertion of the door sash under difficult conditions:  
Simply insert the door sash with conical support ring into the frame component without  
the axis pin. Push the pin in from below and adjust at support position using the threaded  
stopper.

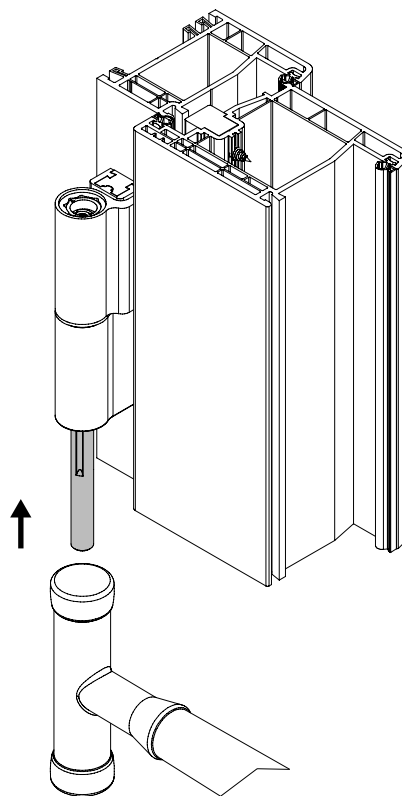

1



## Sash installation and disassembly (one-man installation)

To unhinge the sash (e.g. for low-lintel variants), unscrew the threaded plug downwards, remove the cover stopper and push the axis pin out from the top. The door sash is retained in the cone of the frame component and can be lifted out at ease.

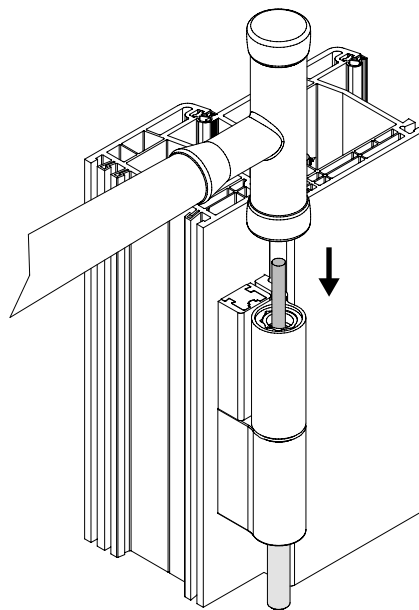



## Settings

### Height adjustment

Use a 4 mm Allen key to adjust the threaded plug at the bottom of the butt hinge plate.

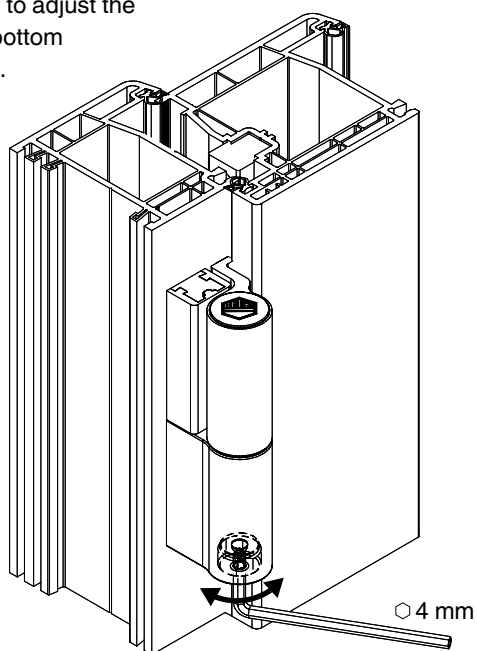

1

Starting at the basic setting, it is possible to raise the sash 5 mm and lower it 1 mm.

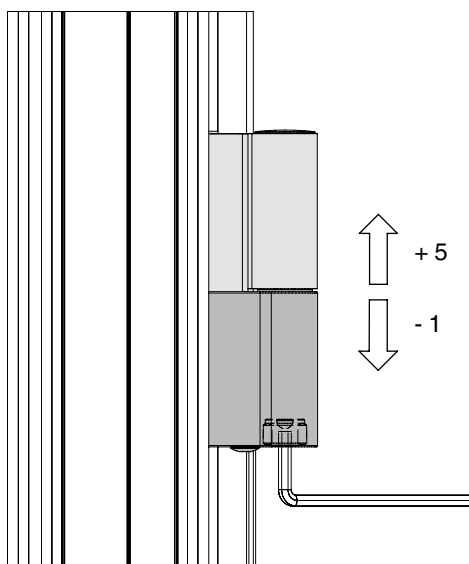

2



## Settings

### Adjusting the gasket compression

Remove the cover stopper.

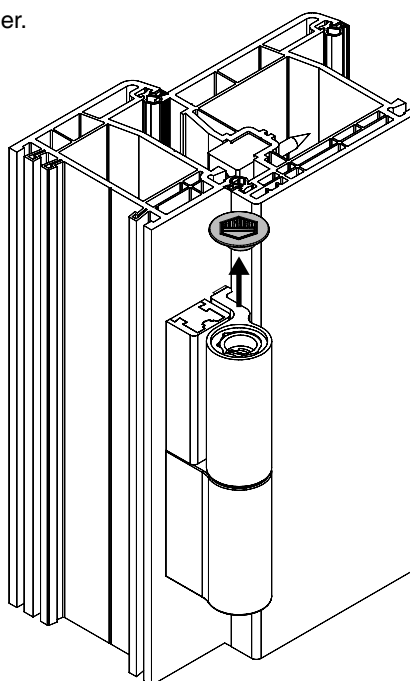

1

Set the gasket compression with 4 mm Allen key

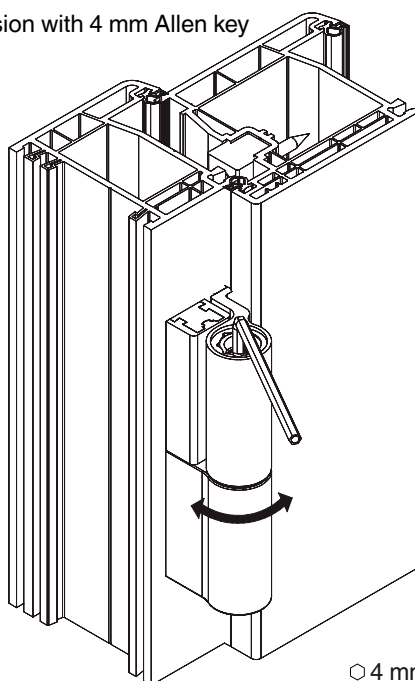

○4 mm

2



## Settings

### Adjusting the gasket compression

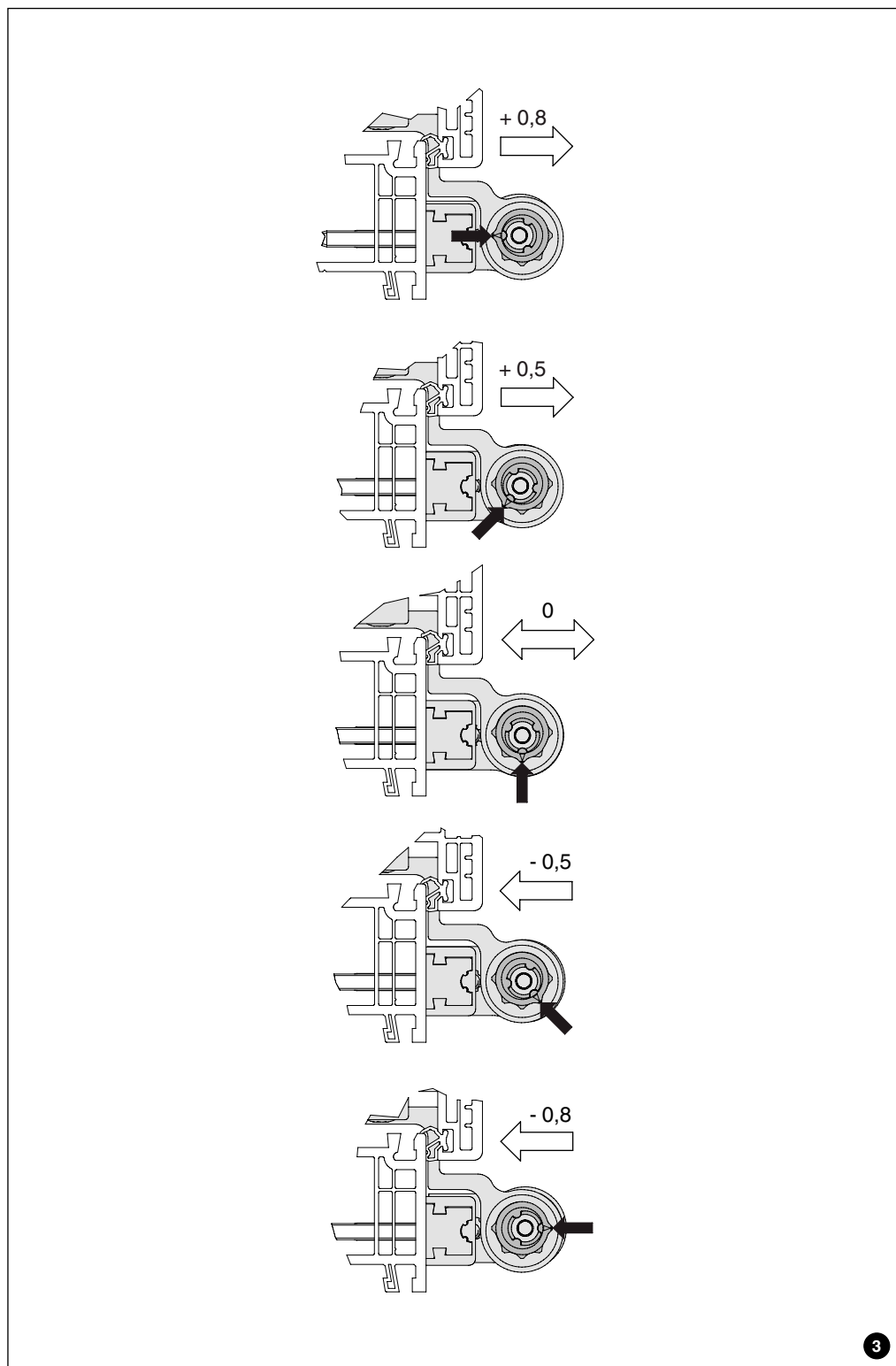



## Settings

### Lateral adjustment

Open the sash and loosen the outer screws using a 4 mm Allen key.

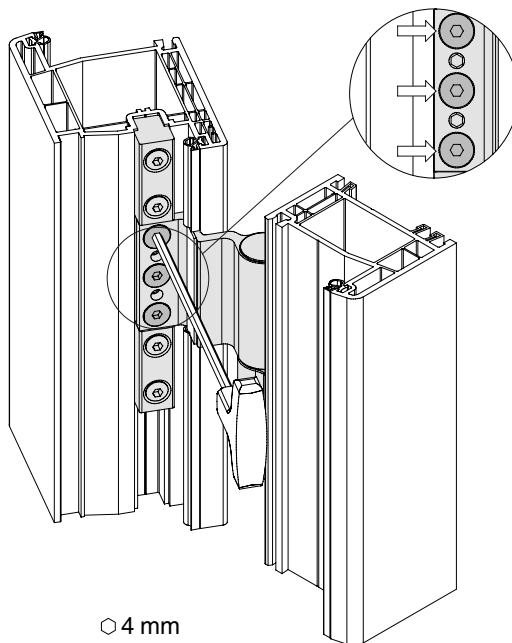

Adjust the two inner screws (4 mm) equally in the range +3 / -3 and then fasten the three outer screws again.

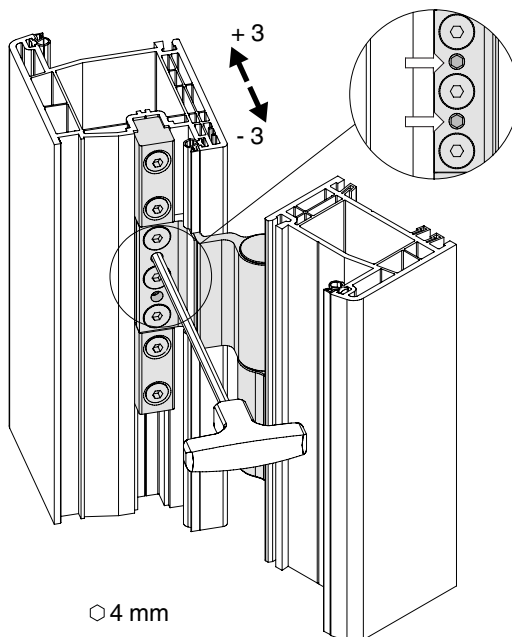



## Table for positioning the cylinder pins

Profile	Pos. cylinder pins	Profile	Pos. cylinder pins
Actual carat	26.5	Kömmerling Gold 70	27
Alphacan 70	26.5	LB Profile PCD Concept	27
Aluplast 2000	26.5	LB Profile PCD Contur	27
Aluplast 4000	27	Rehau Geneo	27
Aluplast 6000	27	Salamander	27
Aluplast 7000	26	Salamander 2D	27
Aluplast 8000	27	Salamander 3D	27
Brüggmann MD	27	Salamander Streamline	26
Gealan S7000	27	Schüco Corona AS	27
Gealan S8000	27	Schüco Corona CT 70	26.5
Inoutic Prestige	27	Schüco S182	27
KBE 88+	26.5	Trocal 88+	27
KBE AD 58	26.5	Trocal Innonova A5	27
KBE AD 70	27	Trocal Innonova M5	27
Kömmerling 88+	26.5	Tryba	26.5
Kömmerling Classic	27	Tryba H84	26
Kömmerling Eurpdur 3S	27	Veka Alphaline	27
Kömmerling Futur	27	Veka SL82	27
Kömmerling Gold 58	26.5	Veka Topline	27

**MACO  
PRO-DOOR**



**MAYER & CO BESCHLÄGE GMBH**

ALPENSTRASSE 173  
A-5020 SALZBURG  
TEL +43 662 6196-0  
FAX +43 662 6196-1449  
maco@maco.at  
www.maco.at

**MACO DOOR & WINDOW  
HARDWARE(U.K.) LTD**

EUROLINK INDUSTRIAL  
CENTRE CASTLE ROAD;  
SITTINGBOURNE KENT ME10 3LY  
TEL +44 1795 433900  
FAX +44 1795 433902  
enquiry@macouk.net  
www.macouk.net

