



TECHNOLOGY IN MOTION

MACO RAIL-SYSTEMS

SLIDING HARDWARE



ASSEMBLY INSTRUCTIONS

HS COMFORT CLOSE / COMFORT STOP
concealed with reinforcement VS9620
Salamander evolutionDrive HST 82

Table of contents

Important instructions	3
<hr/>	
Function	3
<hr/>	
Fittings overview	4 - 5
<hr/>	
Preparation frame - Example: scheme A and C	6
<hr/>	
Preparation sash	7
<hr/>	
Mounting Comfort Close/Comfort Stop	8
<hr/>	
Mounting sash and frame	9
<hr/>	
Reference dimension	9
<hr/>	
Adjustment options	10
<hr/>	
Mounting cover frame piece	10
<hr/>	
Limit opening width	11
<hr/>	
Technical data	11

Important instructions

Target group

This documentation is intended exclusively for specialist companies and certified specialists. The work described herein must only be carried out by certified specialists.

Usage and safety information

In addition to this information, the profile-dependent assembly instructions for HS-Hardware Salamander evolution Drive 82 PVC, Order No. 758545EN, must be complied with. In the Comfort Close assembly instructions, only the differences from the above document are described. Mount all hardware parts professionally as described in this manual and observe all safety instructions.

Function

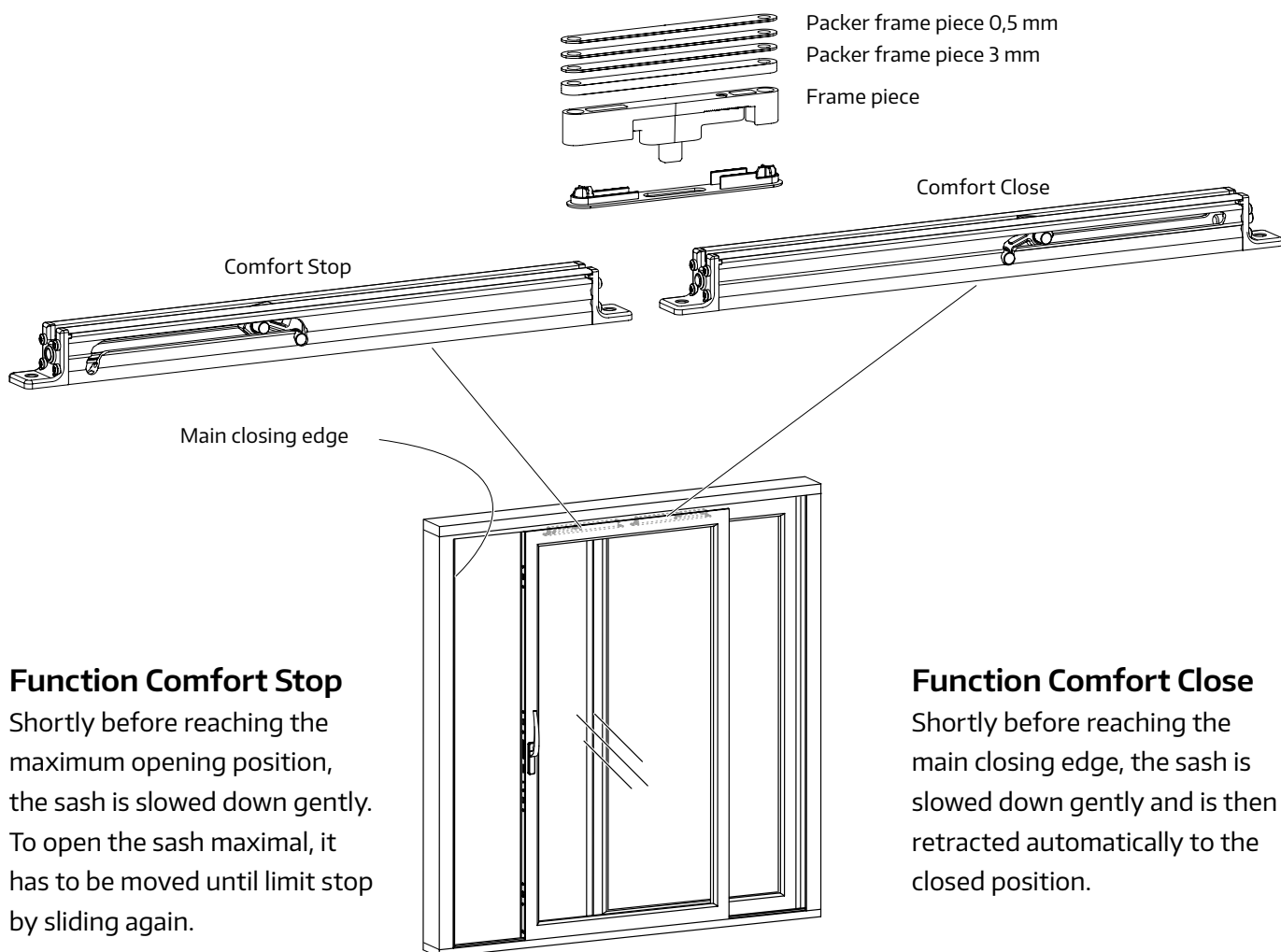

Fittings overview

Pos.	Description
15.1	Comfort Close
15.2	Comfort Stop
16.1	Packer housing
16.2	Frame piece
16.3	Cover frame piece
16.4	Packer frame piece
16.5	Packer frame piece (3 mm)

Note: All measurements in this document are indicated in millimetres.

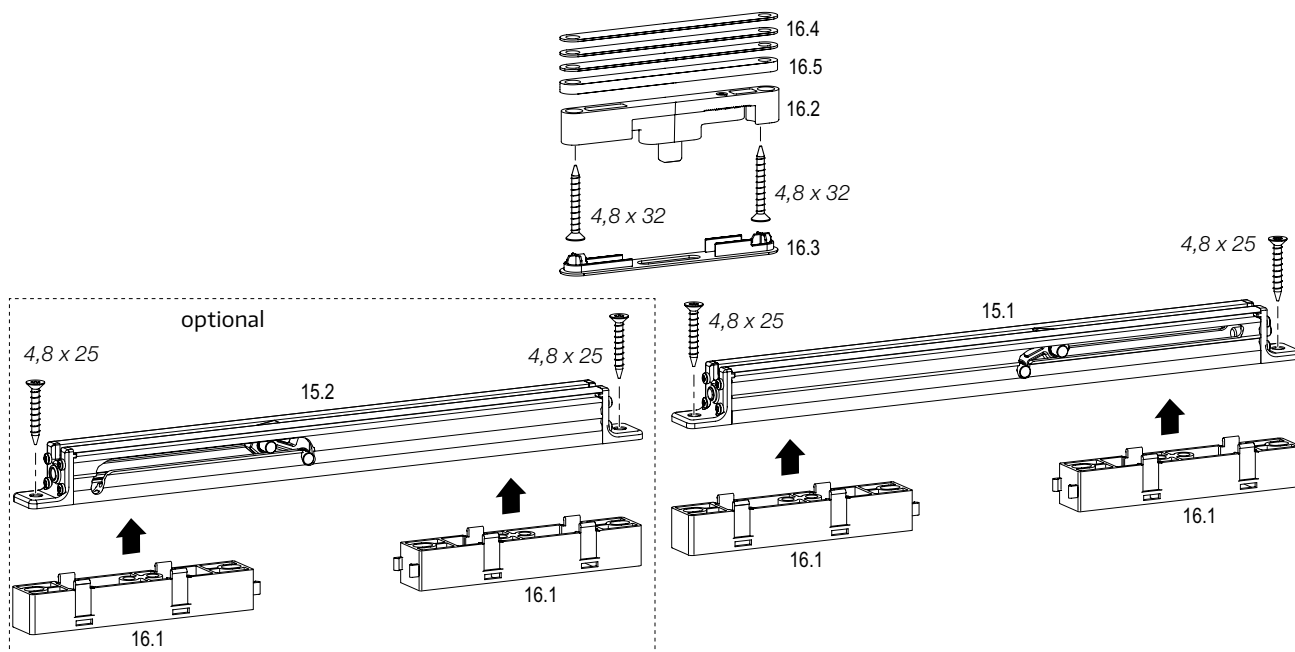

Screws are not included in scope of delivery.
Respective specifications represent a recommendation, only.



Fittings overview

Items per sliding sash

	Article description			Item Code	
1	Comfort Close 15.1 ²⁾	size 1	≤ 200 kg ≤ 30 N	sash weight Sliding force	300359
		size 2	> 200 ... 300 kg ≤ 50 N	sash weight Sliding force	300360
1 ^{x)}	Comfort Stop 15.2 ²⁾	size 1	≤ 200 kg ≤ 30 N	sash weight Sliding force	304052
		size 2	> 200 ... 300 kg ≤ 50 N	sash weight Sliding force	304053
	Accessories 501 Comfort Close + Comfort Stop 16.1, 16.4, 16.5			305132	
1	Accessories 501 Comfort Close + Comfort Stop 16.1, 16.4, 16.5			305132	
1	Frame piece, adjustable 16.2			305134	
1	Cover frame piece 16.3			304816	

^{x)} optional ²⁾ Colour of damper: size 1 - black, size 2 - silver-grey

Preparation frame - Example: scheme A and C

Scheme A

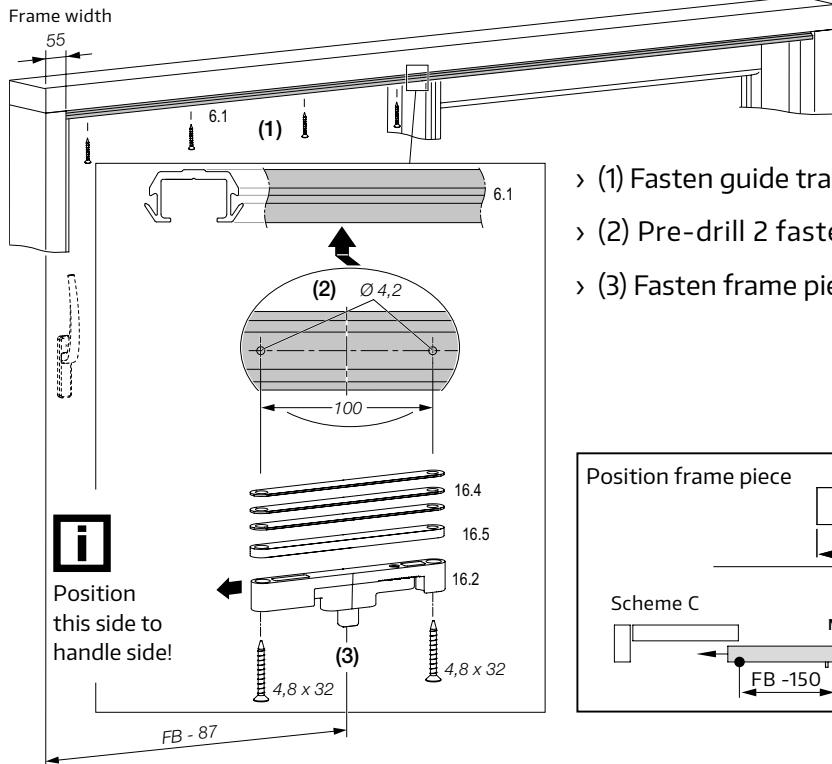
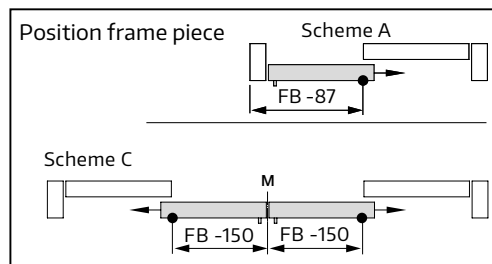
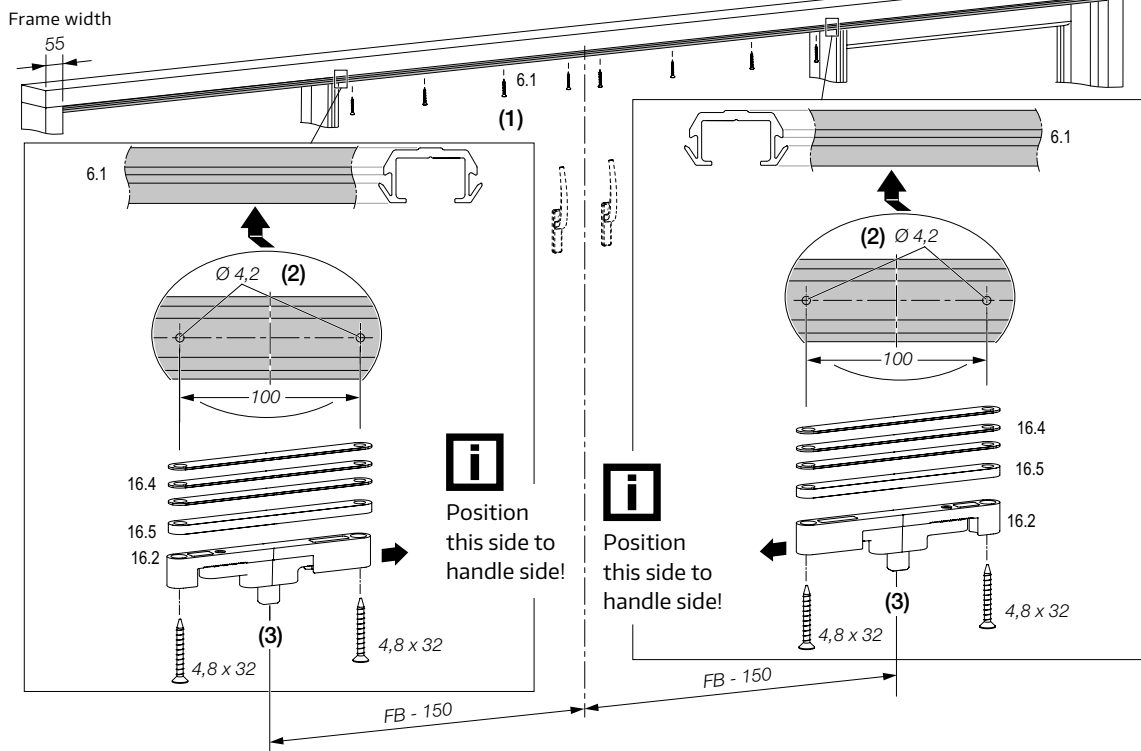

Illustration with dividing of the guide track; However, for this profile system dividing is not mandatory.

- > (1) Fasten guide track.
- > (2) Pre-drill 2 fastening holes $\varnothing 4.2$.
- > (3) Fasten frame piece (16.2) with packers 3x (16.4) / 1x (16.5).



Scheme C



i Position this side to handle side!

Preparation sash

› Carry out sash milling for comfort close on non-handle side and/ or for comfort stop on handle side..



The reinforcement „VS9620“ has to be within the area of comfort close respectively comfort stop (slide in max. 105 mm to outer edge of sash).

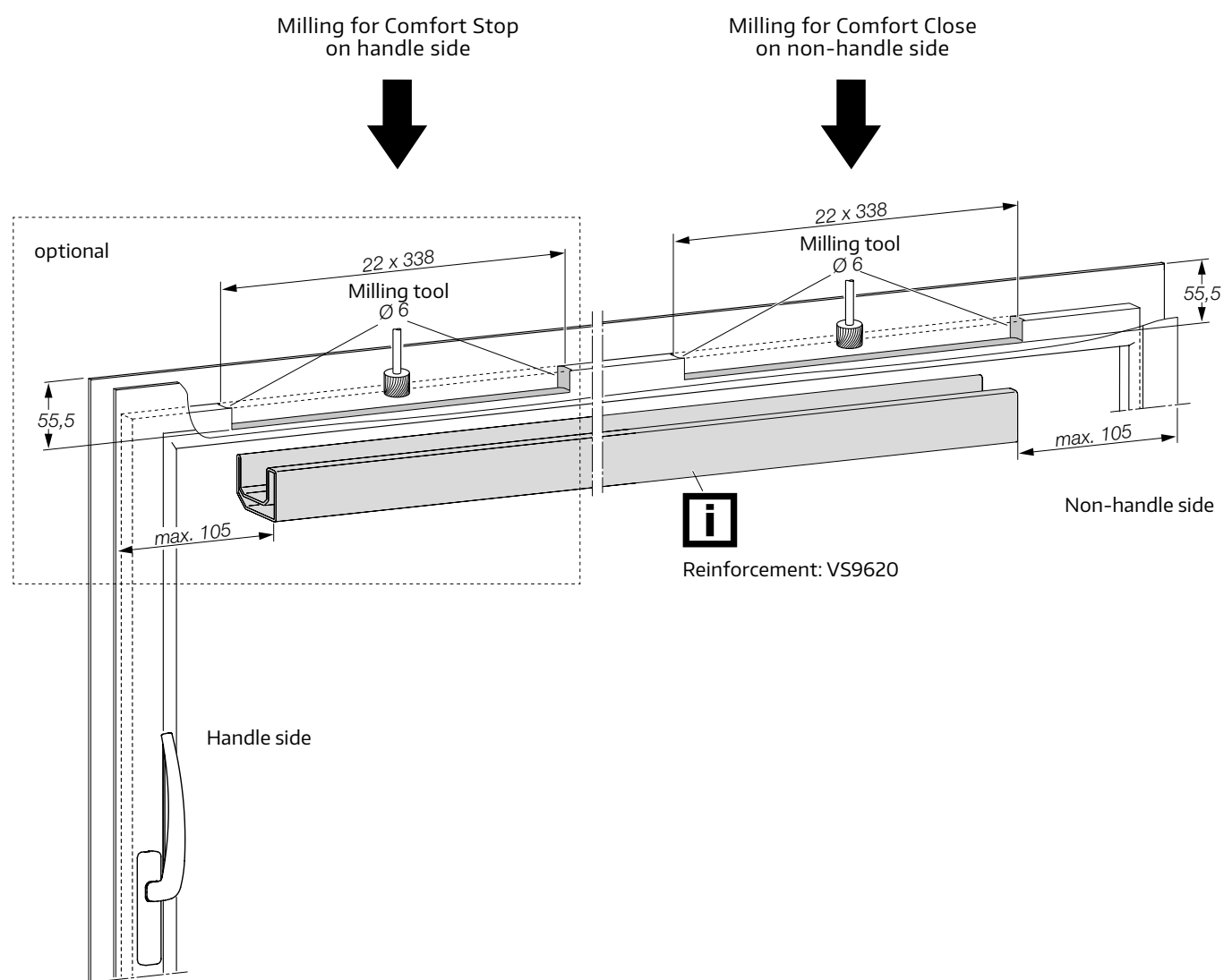

Mounting Comfort Close/Comfort Stop

- > (1) Comfort Close respectively Comfort Stop has to be pretensioned.
- > (2) Clip packer onto the housing of the Comfort Close and/or onto the housing of the Comfort Stop.
- > (3) Mount the Comfort Close respectively Comfort Stop with 2 screws 4.8 x 25 each at the sash.

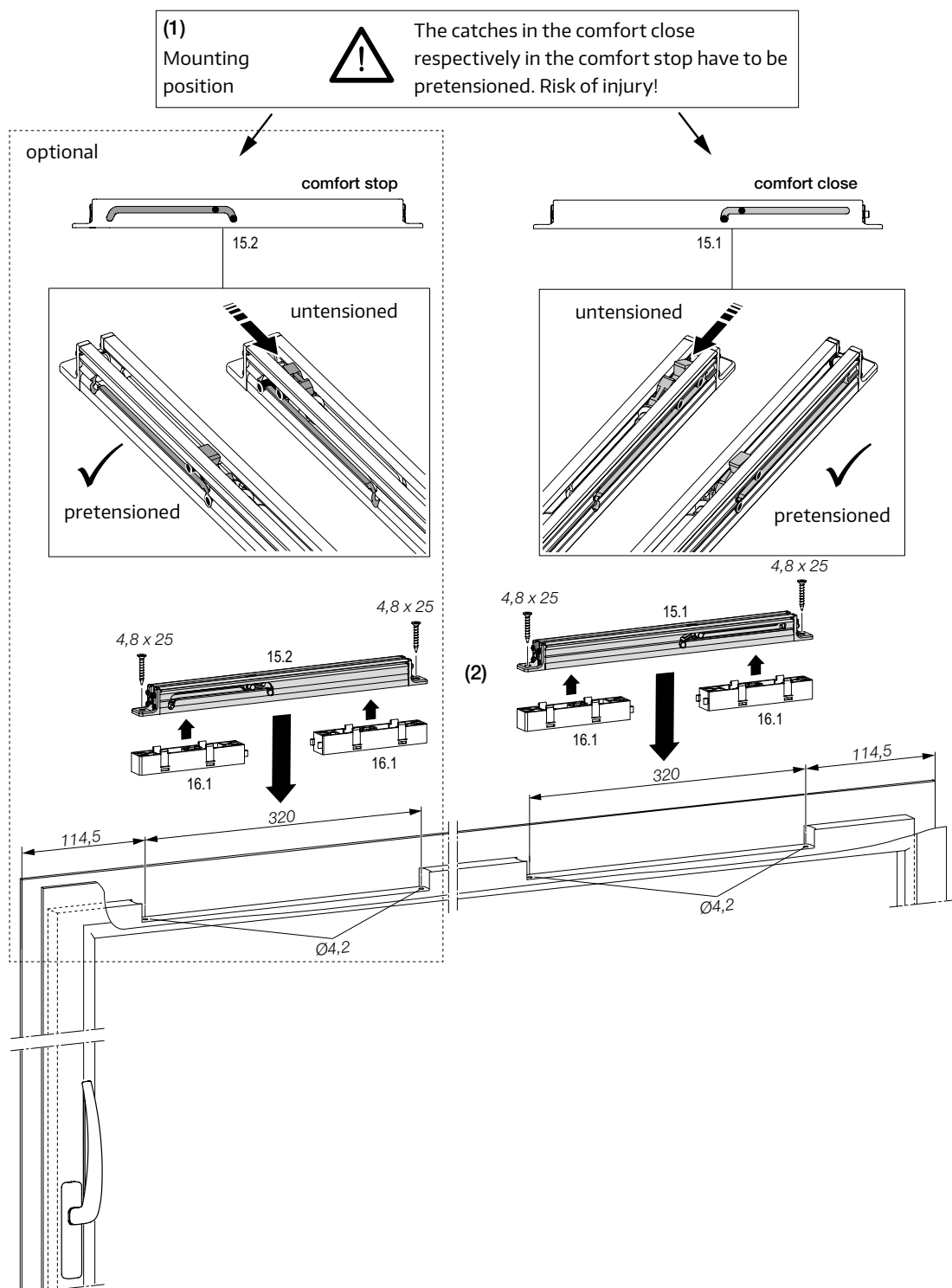

Mounting sash and frame



Attention: Risk of injury due to fallen sash!

To avoid the risk of injury, perform the following steps with two workers.

Example: scheme A; scheme C accordingly

- › (1) Set sash into frame as shown.
- › (2) Put both guides (4.10) onto the slider (4.12) and fasten by means of screws 4.8 x 45 into the dowels.

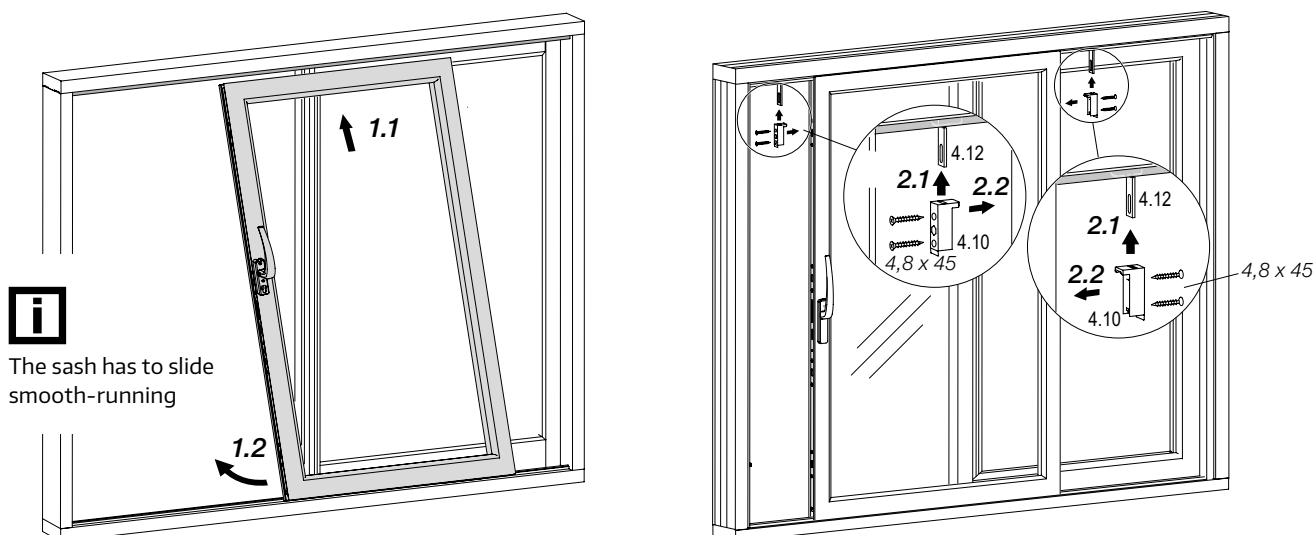

Reference dimension

- › To check the height of the frame piece, swivel in the sash, lift it and slide into closing position.
- › Measure reference dimension within the range of the comfort close respectively comfort stop (desired value = 9 mm).
- › If necessary, slide the sash aside and compensate deviation to the reference dimension by adjustment of the frame piece (refer to „Adjustment options“).
- › Fasten guide track on fixed sash side.

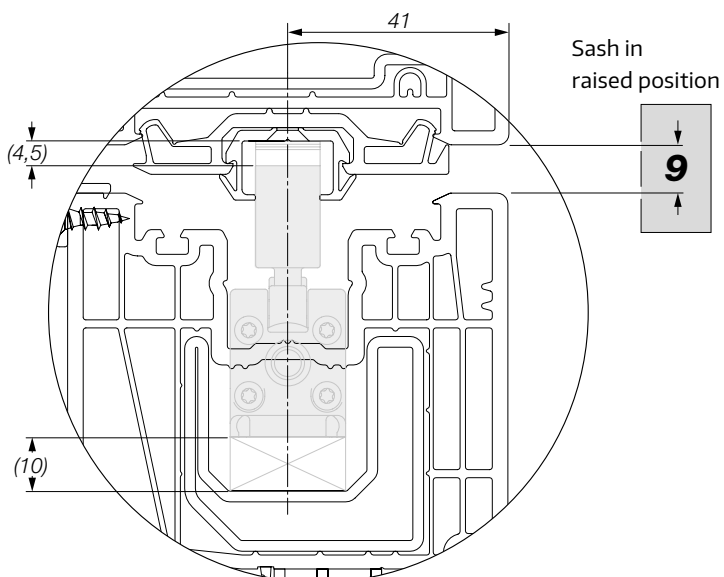

Adjustment options

In case of inaccuracy concerning position of the frame piece, the reference dimension concerning the height of the frame piece and the end position of the sash related to the frame can be adjusted. To do this, the sash has to be opened.

- > (1) Correction of the lateral position (+/- 5 mm):
 - (1.1) Loosen screw by means of Torx 25,
 - (1.2) Slide frame piece into the desired direction:
 - 0 – 5 mm: closing of sash will be shifted in direction of handle side;
 - 0 + 5 mm: closing of sash will be shifted in direction of non-handle side.
 - (1.3) Fasten screw with max. 3 Nm.
- > (2) Correction of the height of the frame piece (+ 3 mm) with Torx 15.

Adjustment at closing edge

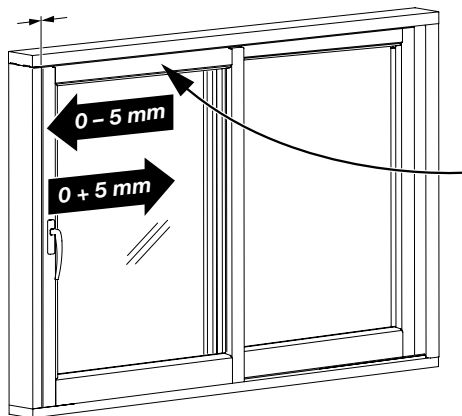

(Sash opened)

0 – 5 mm: towards closing position (frame)
0 + 5 mm: off the closing position (frame)

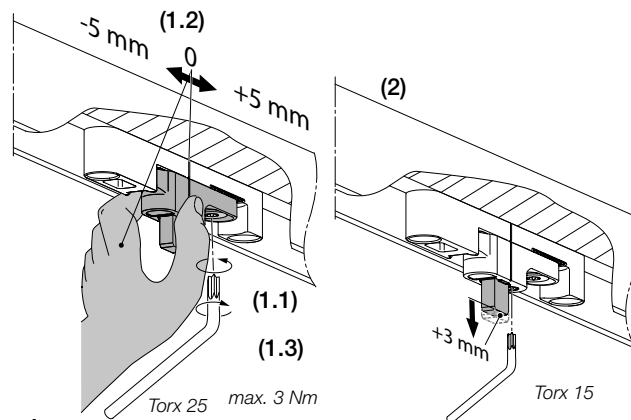

Note: Adjustments may be changed after glazing the sash and mounting the frame!

Mounting cover frame piece

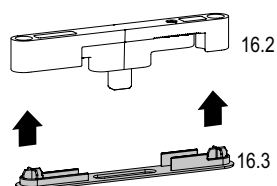

Limit opening width

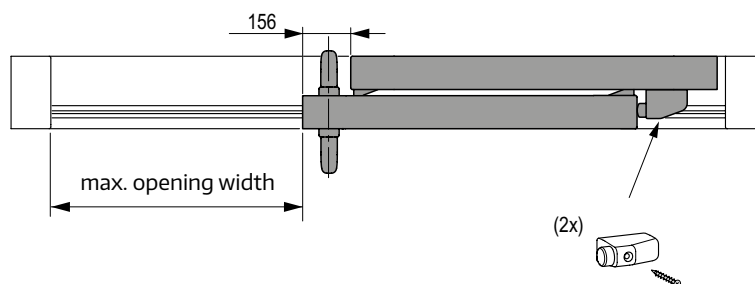

Technical data

Range of application scheme A:

Sash width (FB)	740 – 3330 mm
FB _{min.} for 2x Comfort Close	890 mm
Sash height (FH)	755/765 – 2870/2880 mm
Outer frame width (RAB)	acc. to profile manufacturer's specifications
Sash weight or sliding force without Comfort Close and Comfort Stop	size 1: max. 200 kg or max. 30 N size 2: max. 300 kg or max. 50 N (further sizes on request)

Depending on version of the profile sealing to be used, it can happen, that the sash cannot close completely.

Dimensions (W x H x D)	
Comfort Close	336 mm x 27.5 mm x 22 mm
Comfort Stop	336 mm x 27.5 mm x 22 mm
Soft move-in	starting approx. 100 mm off the closing edge
Increase of sliding force with Comfort Close or Comfort Stop	size 1: by 25 N (black) size 2: by 45 N (silver-grey)

Range of application is depending on used profile systems. Specifications of profile manufacturers to be observed.

You want everything from a single source?

We provide you with complete solutions for sliding doors, windows and doors – for timber, PVC and aluminium. Experience our versatile system offer, comprehensive service included. Discover more of this on our website www.maco.eu or contact your MACO representative.

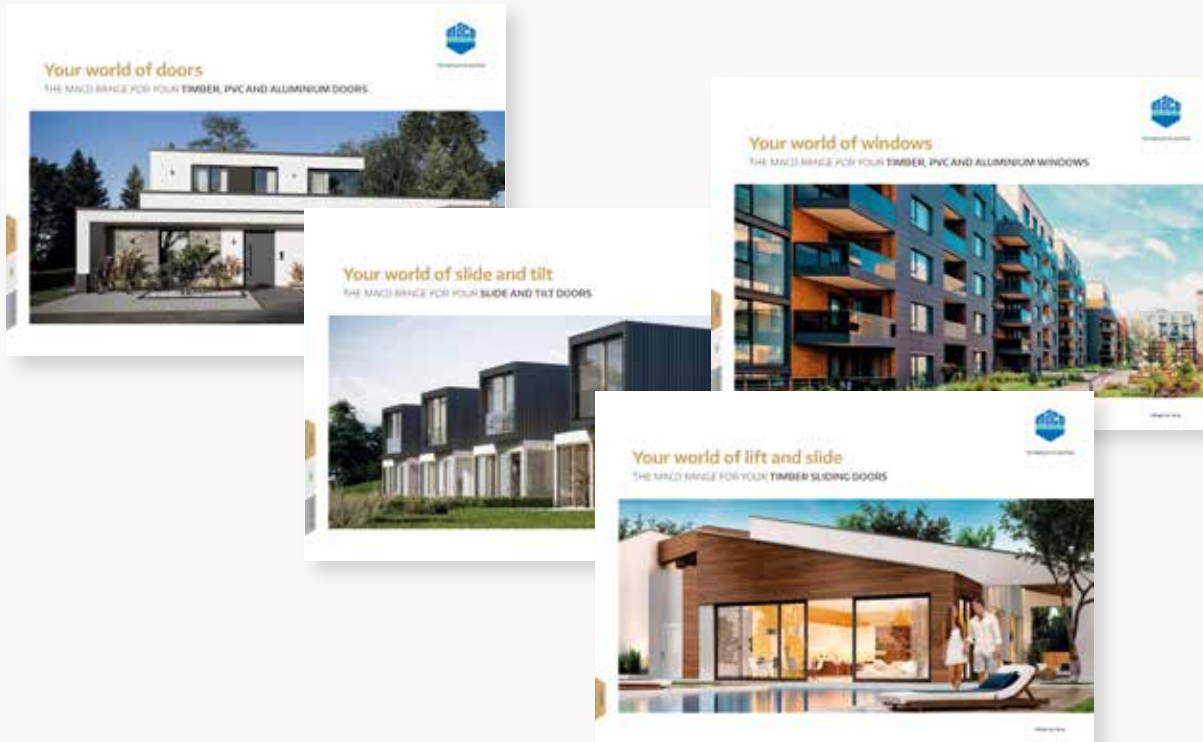

MACO near you:
www.maco.eu/contact



TECHNOLOGY IN MOTION



This print document is revised regularly.
The latest version is available at <https://www.maco.eu/assets/757738>
or by scanning the QR code.

Created: 01/2019 - Changed: 12.03.2020
Order no. 757738
All rights reserved and subject to change.