

ASSEMBLY INSTRUCTIONS

# Push Handle with Finger Scan



Use  
**only for certified specialists!**



## Table of Contents

<b>Item</b>	<b>Page</b>
Important Information	3 - 4
Key	4
Overview of Push Handle Components	5
Assembly of Push Handle on Door	6 - 10
Drilling patterns	6 - 7
Assemble supports on the Push Handle	8 - 10
Cabling	11 - 13
Motor	14



## Important Information

### Target Group

This documentation is intended exclusively for specialist companies and certified specialists. The work-steps described here in may only be carried out by certified specialists.

### Instructions for use

- Unless otherwise indicated, measurements are made in millimetres.
- Assemble all hardware parts professionally as described in these instructions and observe all safety instructions.
- All diagrams are only symbolic.
- With the spacer-block setting, observe the technical guideline No. 3 of the glazier trade “Blocking of glazing units”.
- Observe the “Guidelines and Instructions for Product and Liability (GIPL)”.
- Inform the end-user about the contents of the “Guidelines and Instructions for End Users (GIEU)”.
- Printing errors, mistakes and changes are reserved.
- Failure to comply with these assembly instructions eliminates any warranty claim against the hardware manufacturer.

## Important Information

### Safety information



This information covers a situation which may lead to death when these instructions are not followed correctly.



This information covers a situation which may lead to death or serious injury when these instructions are not followed correctly.



This information covers a situation which may lead to minor injuries when these instructions are not followed correctly.

### Informative Note



This information covers important additional information which are important for error-free assembly of the product.

### Key



Handle Height HH

## Overview of Push Handle Components

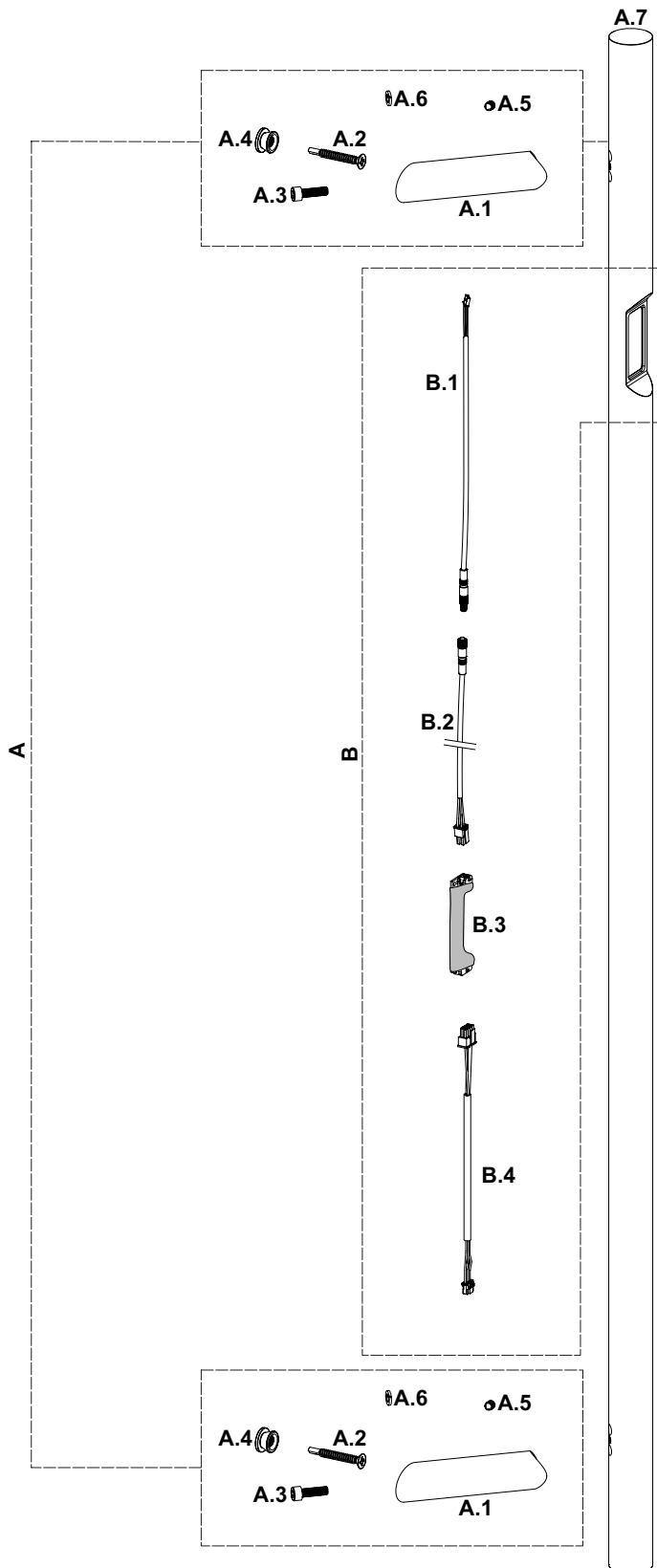

<b>A</b>	<b>Push Handle with Touchkey BT</b>
	478093 straight supports L = 1200 stainless steel
	478094 pitched supports right L = 1200 stainless steel
	478095 pitched supports left L = 1200 stainless steel
<b>B</b>	<b>Finger scan with control unit</b>
	478065 openDoor Touchkey BT for Push Handle

## Assembly of Push Handle on door

Drilling pattern pitched support

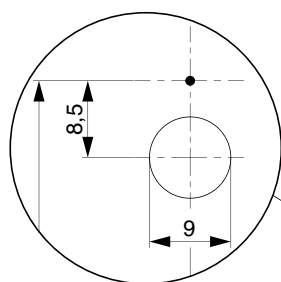

Centre of the support =  
Position of the  
self-tapping screw

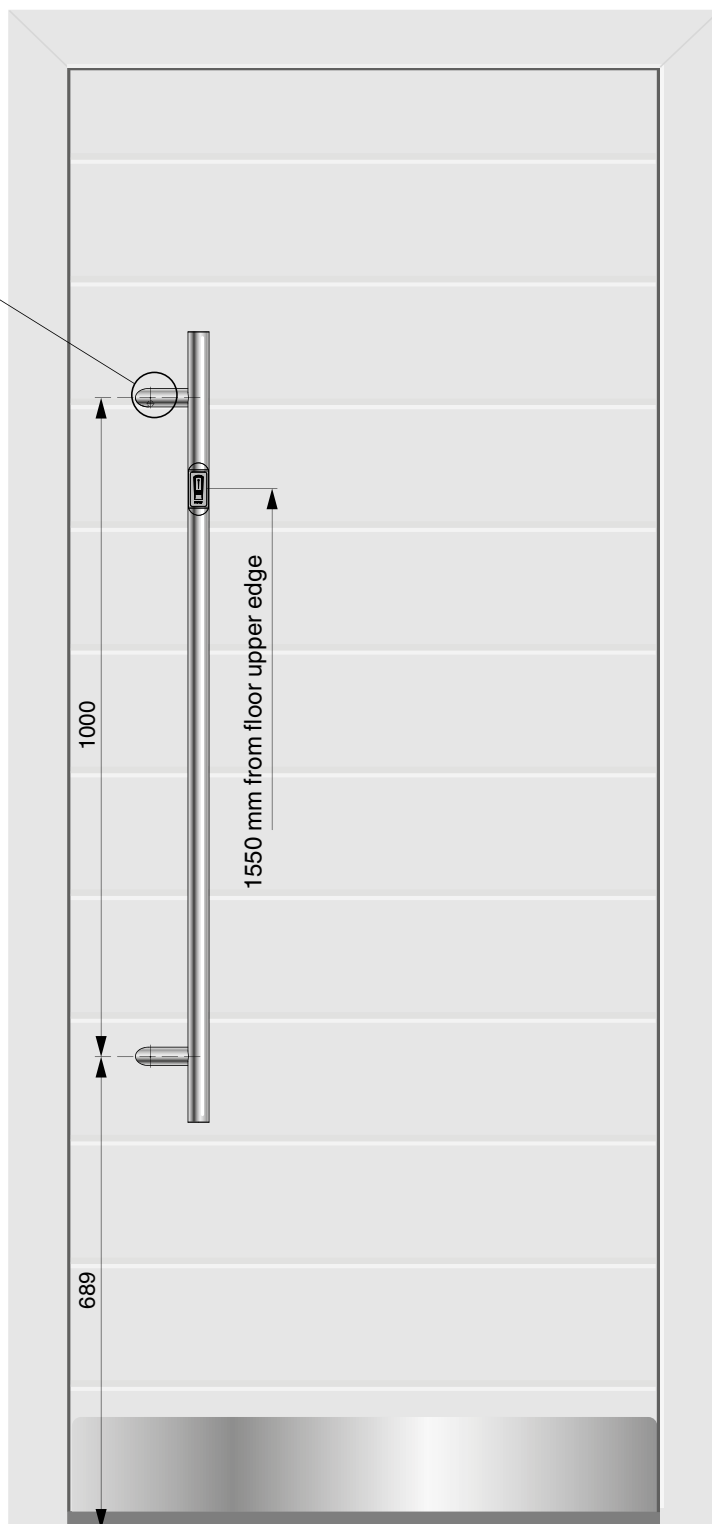

# Assembly of Push Handle on door

## Drilling pattern straight support

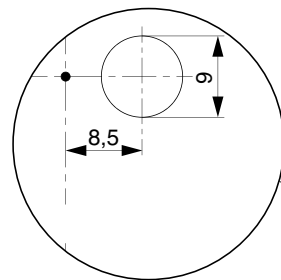

Centre of the support =  
Position of the  
self-tapping screw

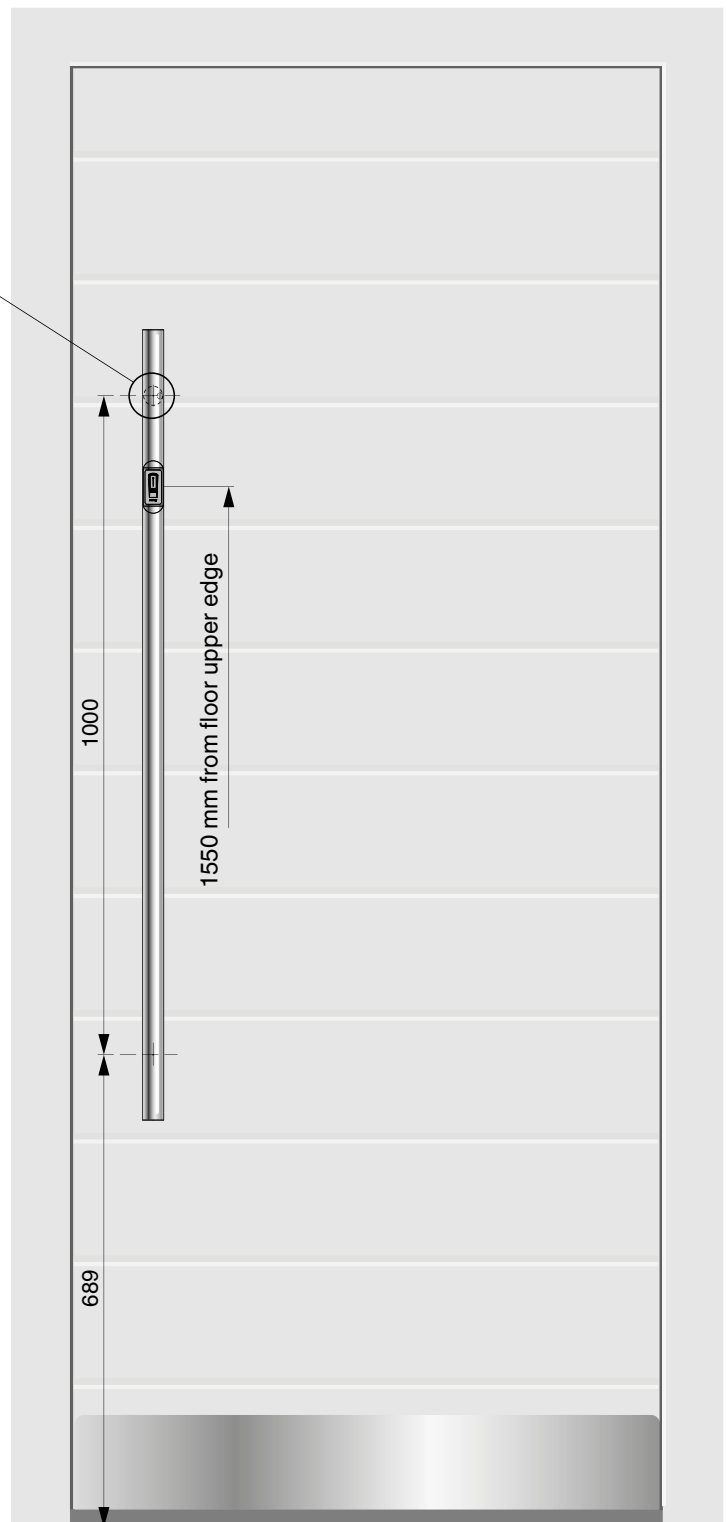

## Assembly of Push Handle on door

Assemble supports on the Push Handle

1.

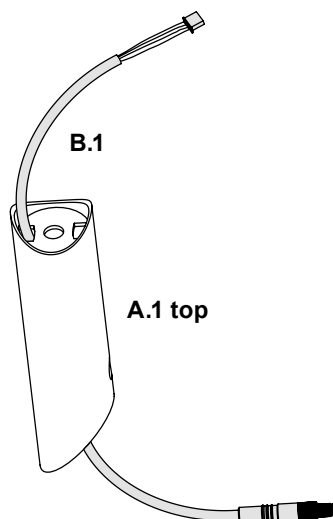

2.

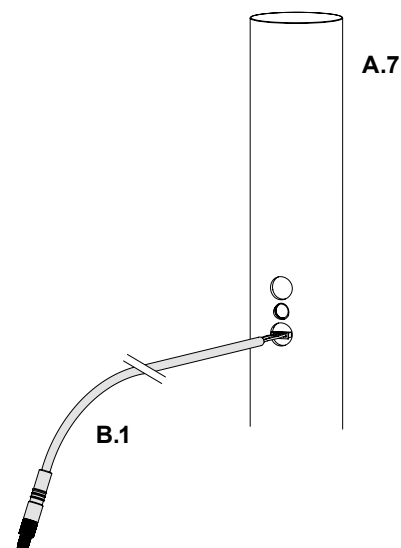

3.

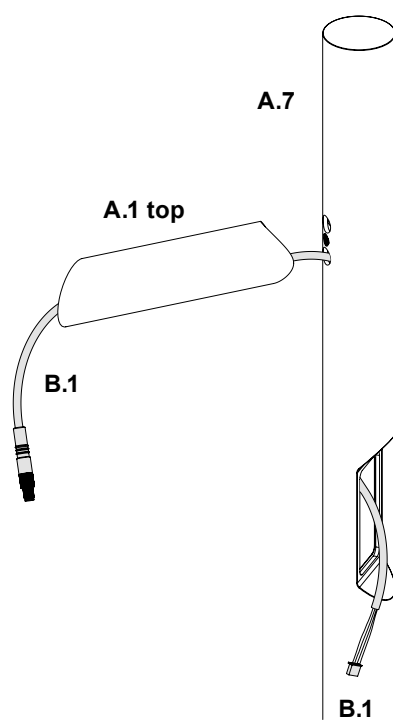

4.

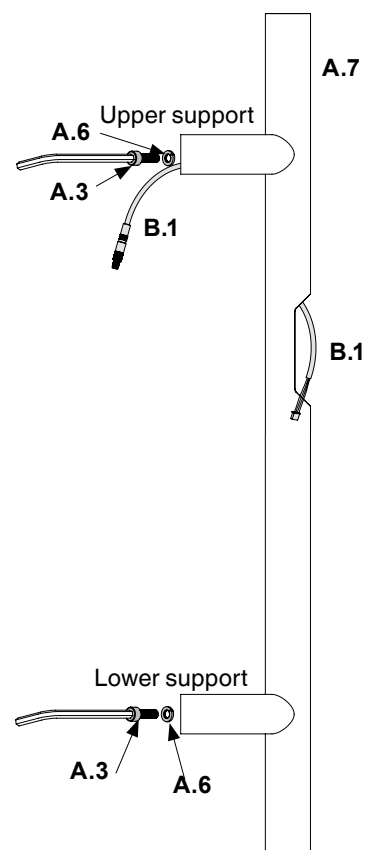



# Assembly of Push Handle on door

Pitched support

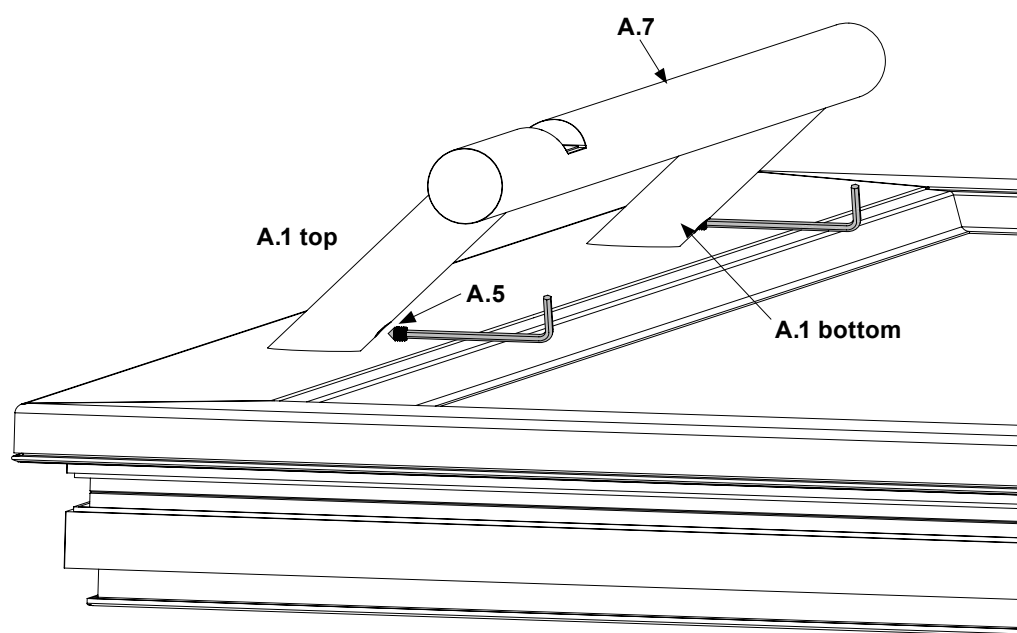
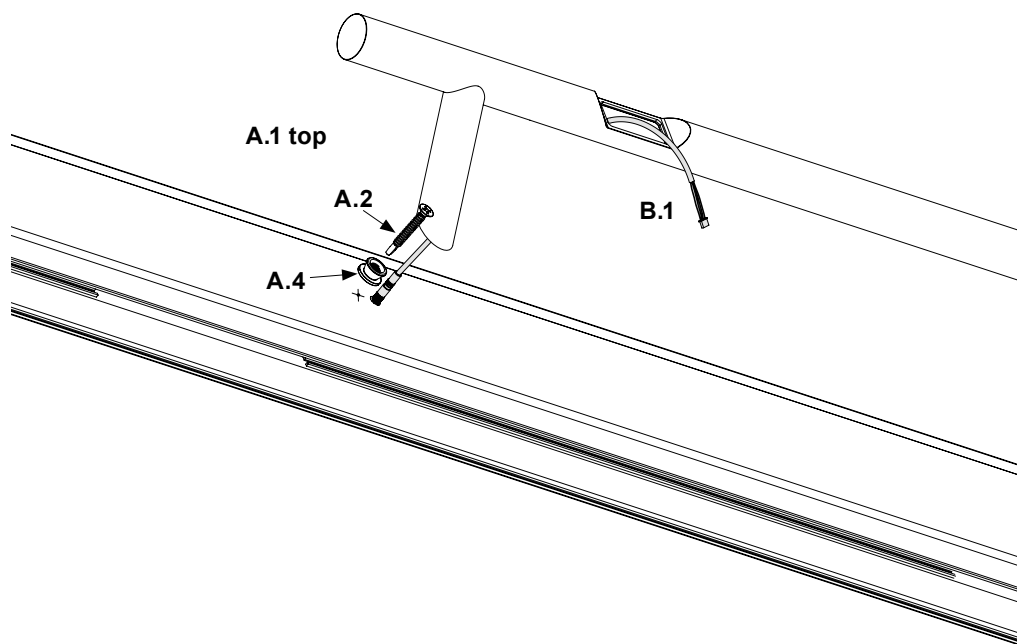

# Assembly of Push Handle on door

Straight support

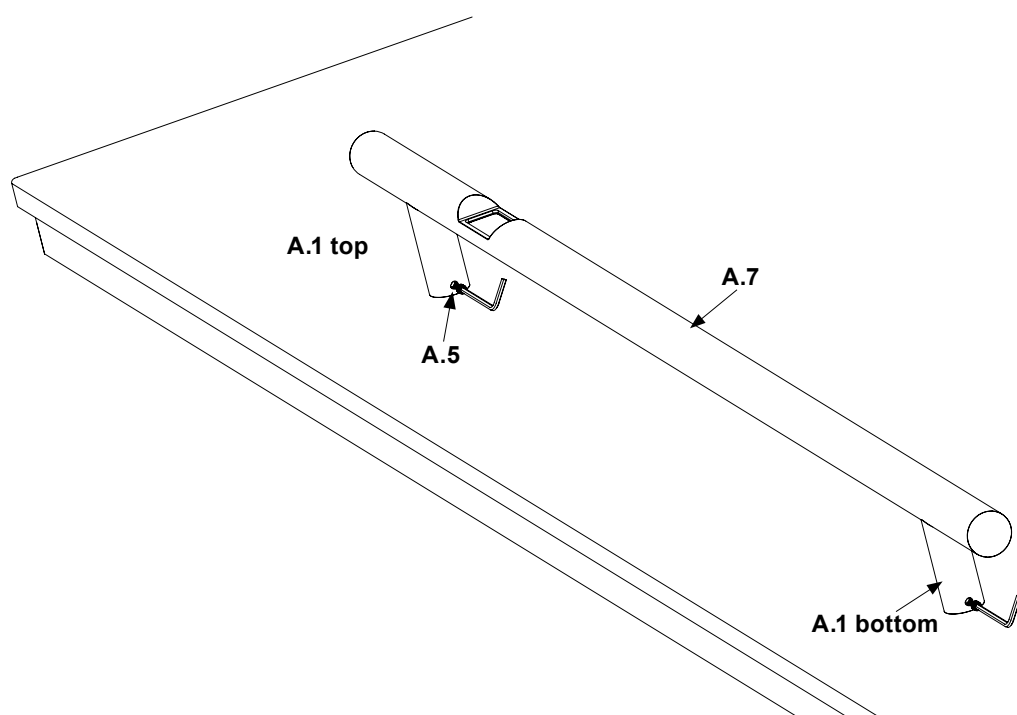
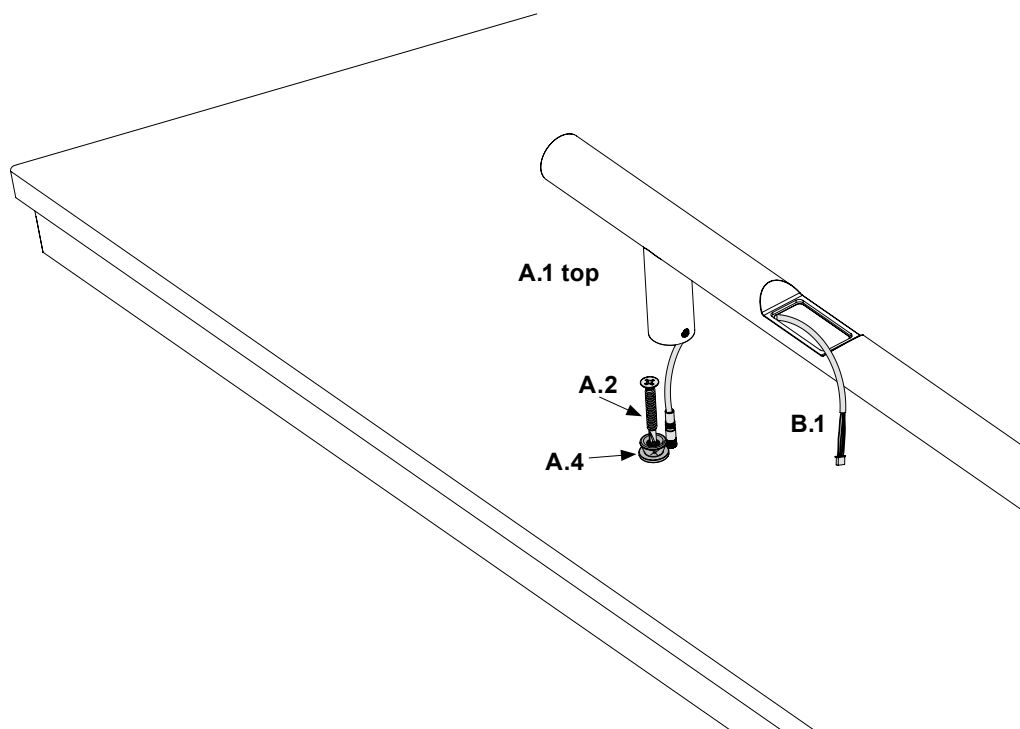

# Cabling

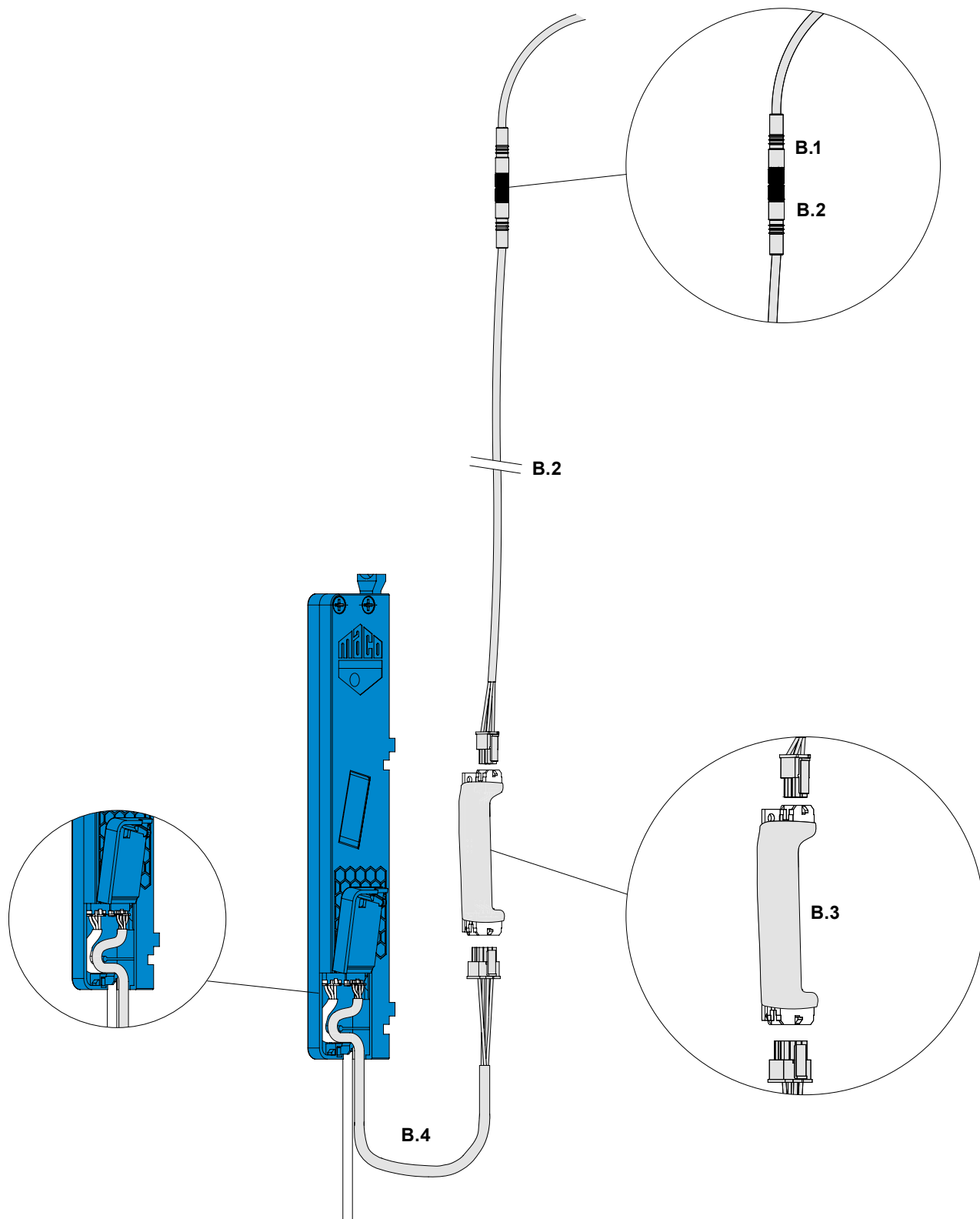

## Cabling

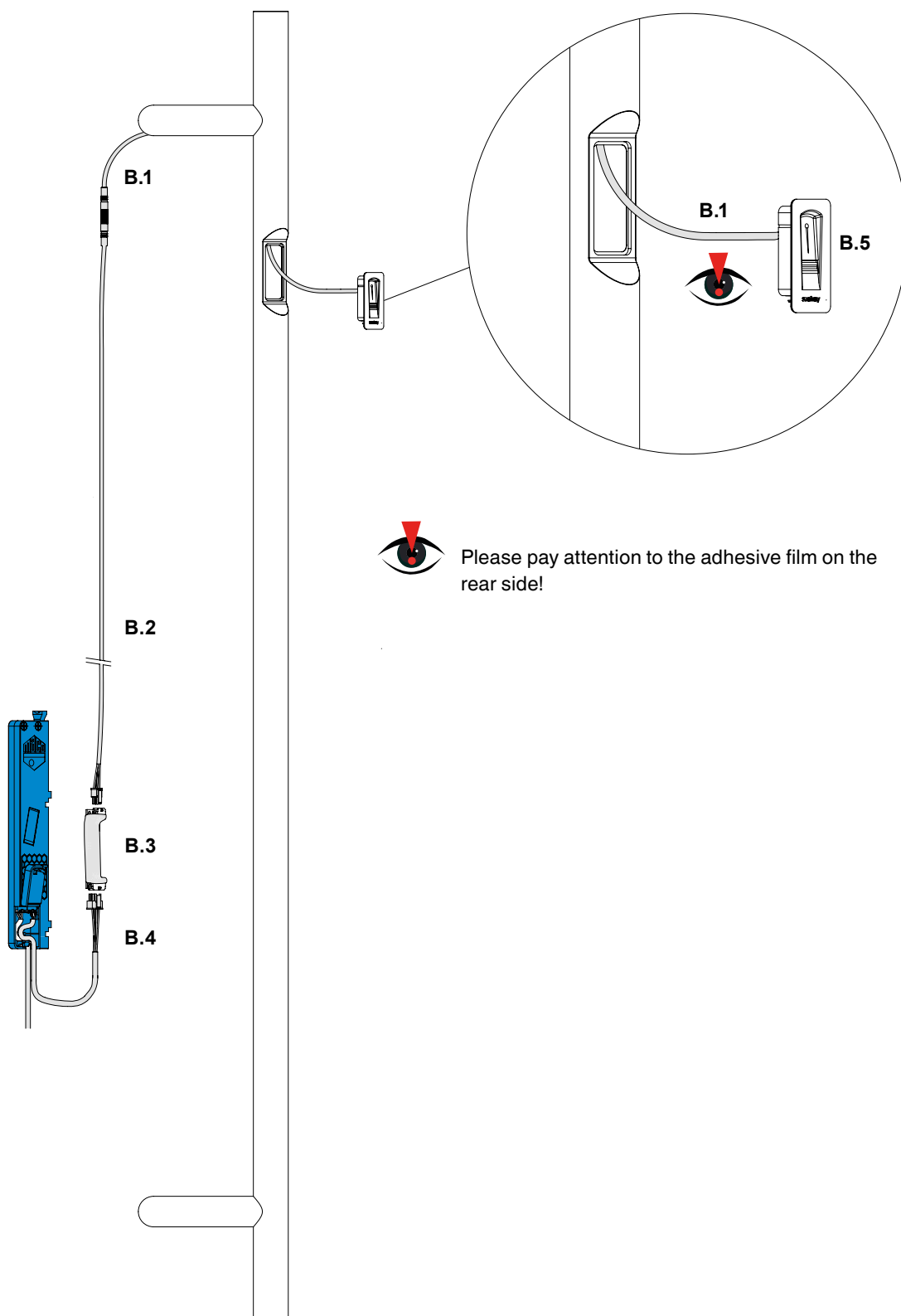

## Cabling

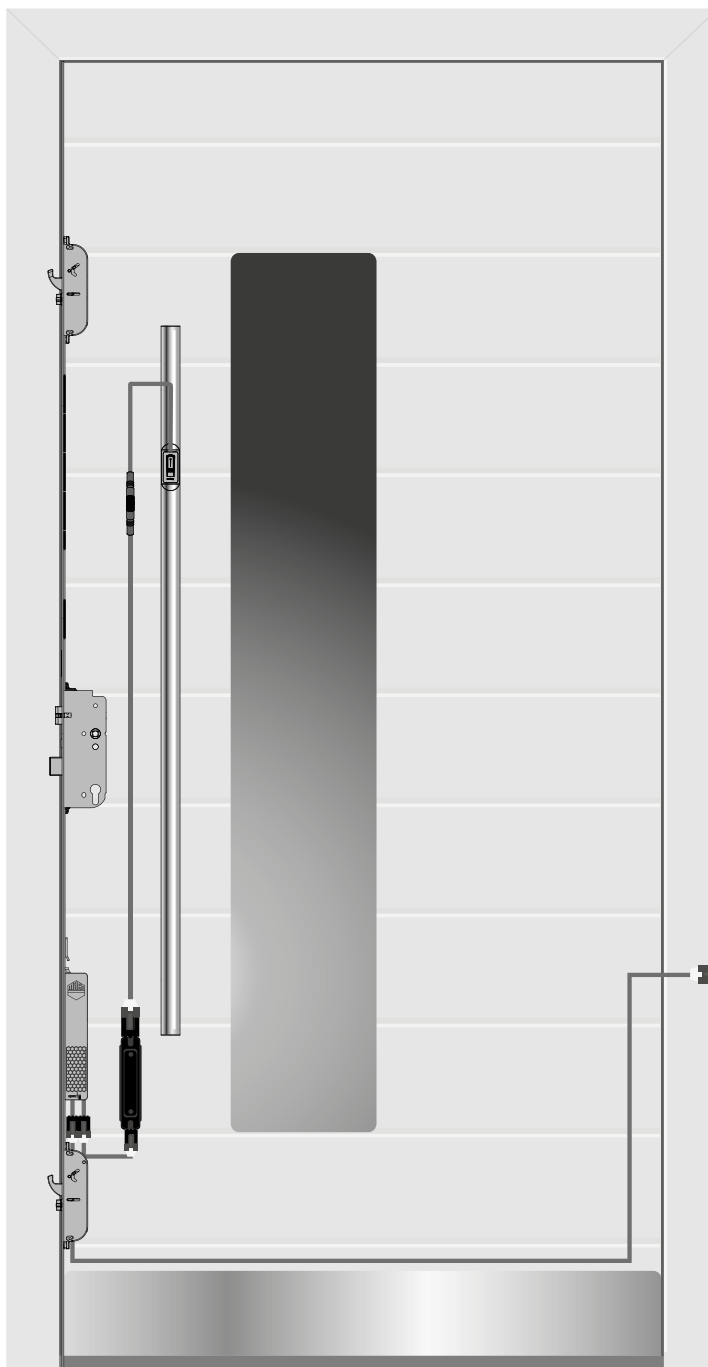

Electrical connections (power supply, connection cable 0.15 m and 10 m) must only be installed by authorised personnel.

# Motor

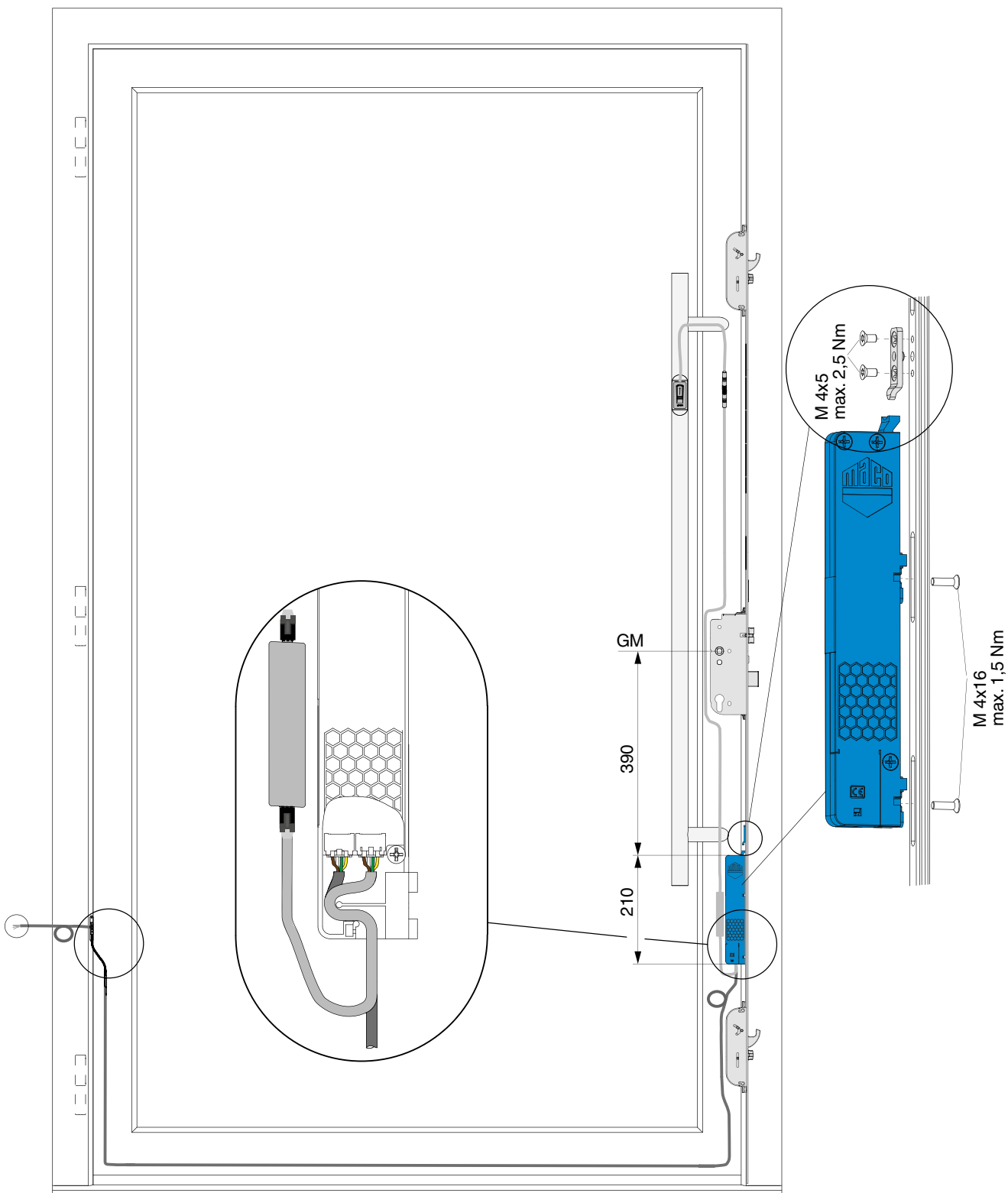



## Notes

A large rectangular area filled with a fine grid pattern, intended for taking notes.

**MACO  
PRO-DOOR**



**MAYER & CO  
BESCHLÄGE GMBH**

Alpenstraße 173  
A-5020 Salzburg

Tel.: +43 662 6196-0  
E-Mail: [maco@maco.eu](mailto:maco@maco.eu)  
[www.maco.eu](http://www.maco.eu)

## **Satisfied?**

We look forward to your  
[feedback@maco.eu](mailto:feedback@maco.eu)

Order no. 757856 – Date: November 2018 - Date of change: July 2019

All rights reserved and subject to change.

Graphic source: MACO

This print document is revised regularly.  
The latest version is available at  
<http://www.maco.eu/sites/assets/MacoDocs/757693/757856.pdf>  
or scan the QR code.

