

ASSEMBLY INSTRUCTIONS

L&S hardware

Substructure profiles

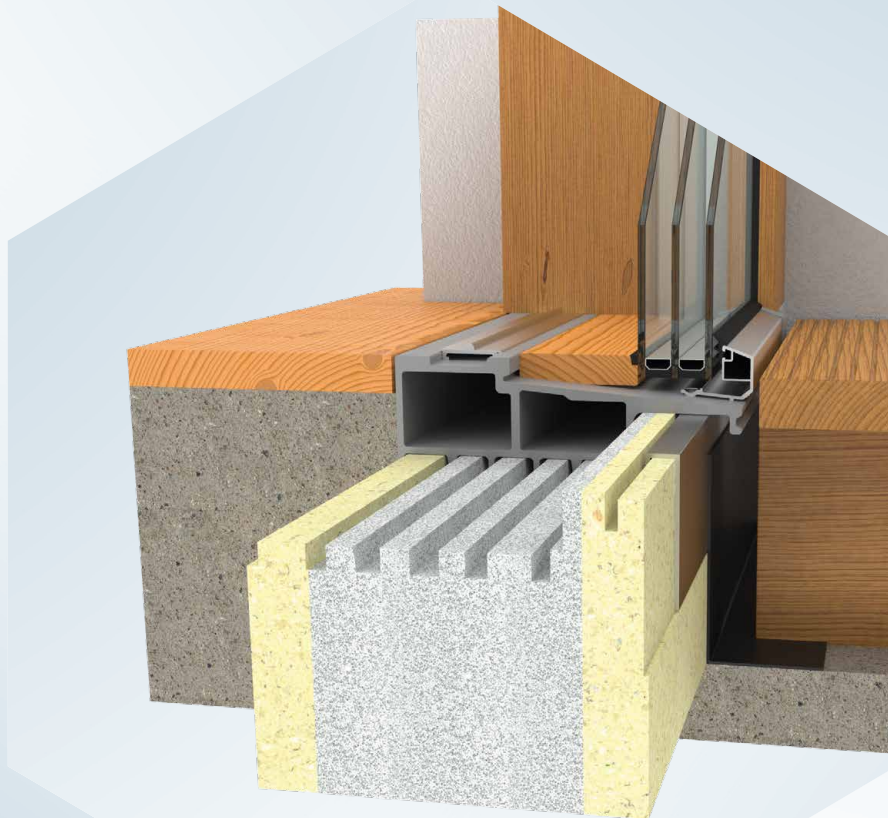

ONLY
FOR USE BY CERTIFIED SPECIALISTS!



Table of contents

Description	Page
Important Information	3
Profile versions	4 - 5
Key	6
1. Adjust substructure profile length	7 - 8
2. Connect substructure profile with GFK threshold	9 - 11
3. Installation in structural opening version 1	12 - 13
4. Installation in structural opening version 2	14



Important Information

Target audience

This documentation is intended exclusively for specialist companies and certified specialists. The work-steps described here in may only be carried out by certified specialists.

Instructions for use

- Mount all hardware parts professionally as described in this manual and observe all safety instructions
- For the substructure of the MACO GFK floor threshold, it is essential to use the MACO substructure and doubling profile. Use of other substructures and doubling profiles invalidates all MACO warranties!

Profile versions

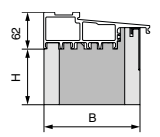
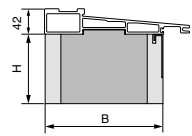
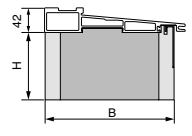
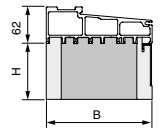
Substructure profiles				
Item designation	MACO Article No.	Dimensions W x H x L	Properties	Illustration
Substructure profile GRP 180	478 098	163 x 50 x 3588	<ul style="list-style-type: none"> • $H \geq 37$ mm • Max. glass weight 600 kg 	
Substructure profile GRP 180	476 604	163 x 95 x 3588		
Substructure profile GRP 240	478 099	195 x 70 x 3588	<ul style="list-style-type: none"> • $H \geq 70$ mm • Max. glass weight 600 kg 	
Substructure profile GRP 240	476 607	195 x 115 x 3588		
Substructure profile GRP 240	478 100	220 x 70 x 3588	<ul style="list-style-type: none"> • $H \geq 70$ mm • Max. glass weight 600 kg • Ideal for Panorama 	
Substructure profile GRP 240	476 609	220 x 115 x 3588		
Substructure profile GRP 180 CH	478 097	177 x 50 x 3588	<ul style="list-style-type: none"> • $H \geq 37$ mm • Max. glass weight 600 kg 	
Substructure profile GRP 180 CH	478 101	180 x 95 x 3588		

Profile versions

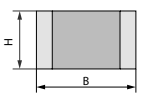
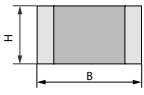
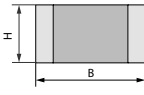
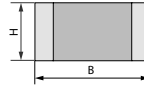
Additional profiles				
Item designation	MACO Article No.	Dimensions W x H x L	Properties	Illustration
Doubling substructure profile GRP 180	476 606	163 x 95 x 3588	<ul style="list-style-type: none"> • Doubling profile for item no. 478 098 	
Doubling substructure profile GRP 180 CH	478 096	180 x 95 x 3588	<ul style="list-style-type: none"> • Doubling profile for item no. 478 097 • no. 478 101 	
Doubling substructure profile GRP 240	476 608	195 x 95 x 3588	<ul style="list-style-type: none"> • Doubling profile for item no. 476 607 • no. 478 099 	
Doubling substructure profile GRP 240	476 610	220 x 95 x 3588	<ul style="list-style-type: none"> • Doubling profile for item no. 476 609 • no. 78 100 	

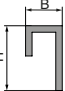
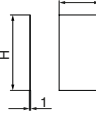
Sealing profile				
Item designation	MACO Article No.	Dimensions W x H x L	Properties	Illustration
Connecting angle substructure profile ALU	476 622	15 x 70 x 3500	<ul style="list-style-type: none"> • Used for all profiles • Enables sealing connection • Material: Alu 	
Connecting angle substructure profile PVC PA6	476 018	17 x 30 x 5000	<ul style="list-style-type: none"> • Used for all profiles • Enables sealing connection • Material: PA6 + GFK 	
Sealing foil	370 855	1 x 100 x 185	<ul style="list-style-type: none"> • Enables sealed connection angle 	

Key



Hoffmann Schwalbe W3 (included with profile delivery)

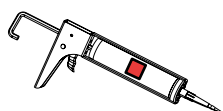

PUR glue Mirapur 9500 Speed or similar

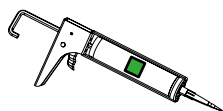

Polymer glue / sealant Teroson MS9360 or similar



Important Information

1. Adjust substructure profile length

a) Measure outer frame width

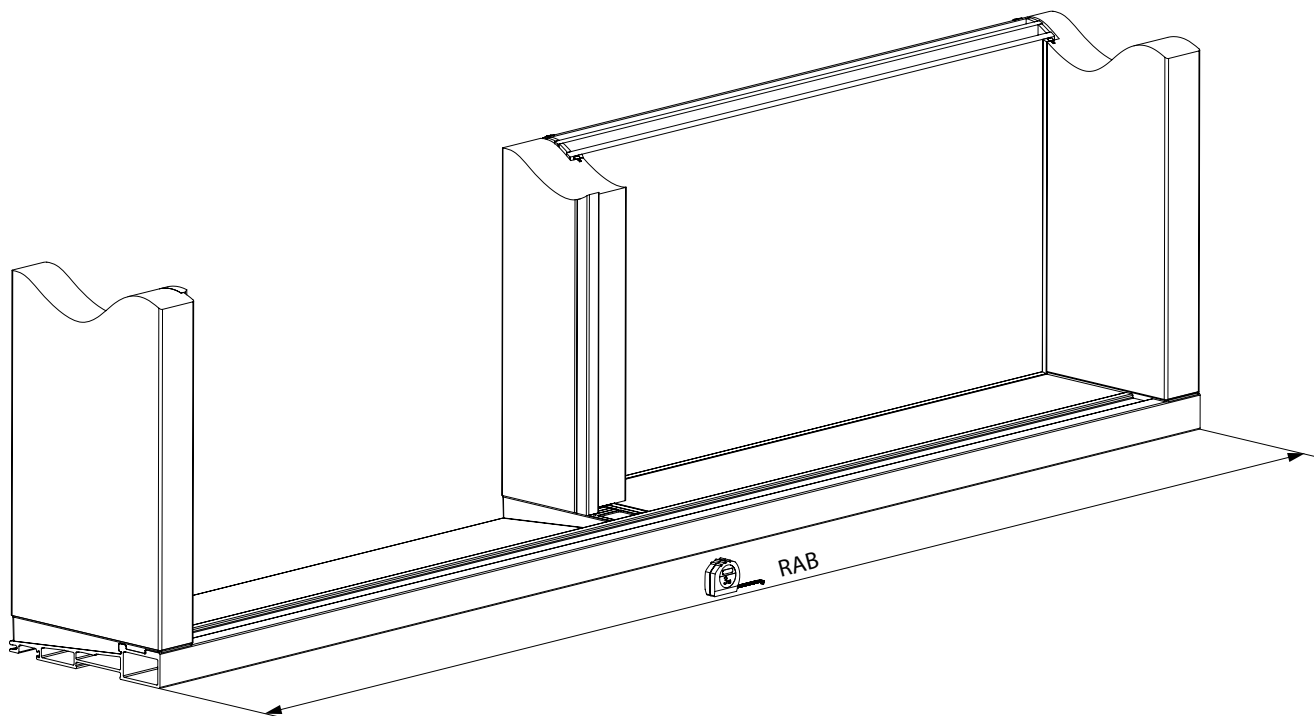

b) Crop / extend substructure profile

RAB < 3588 mm → crop substructure profile

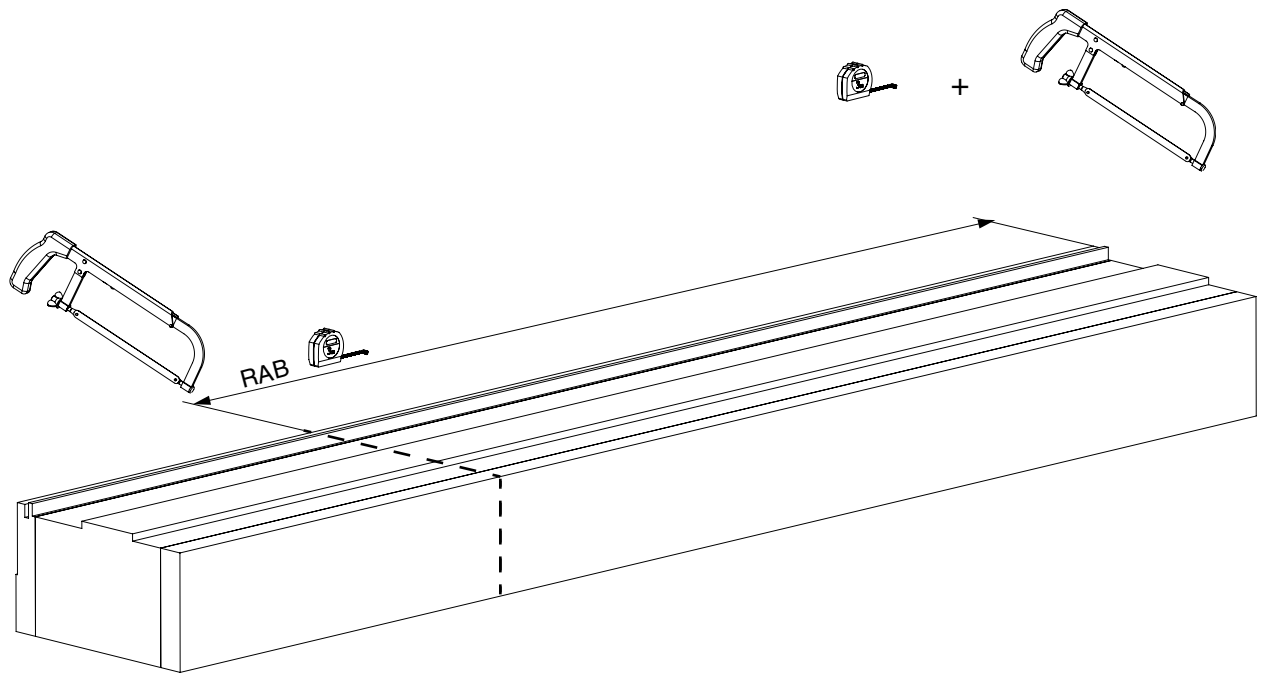

RAB > 3588 mm → extend substructure profile

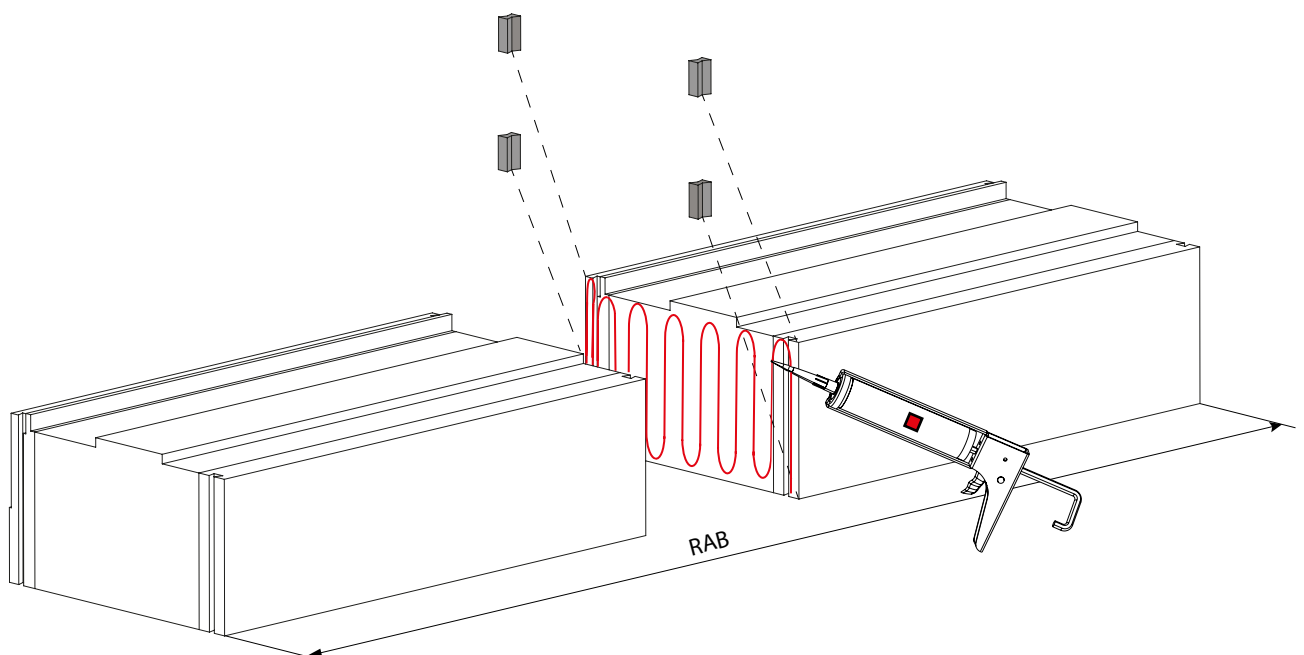

2. Connect substructure profile with GFK threshold

a) Apply connection bracket

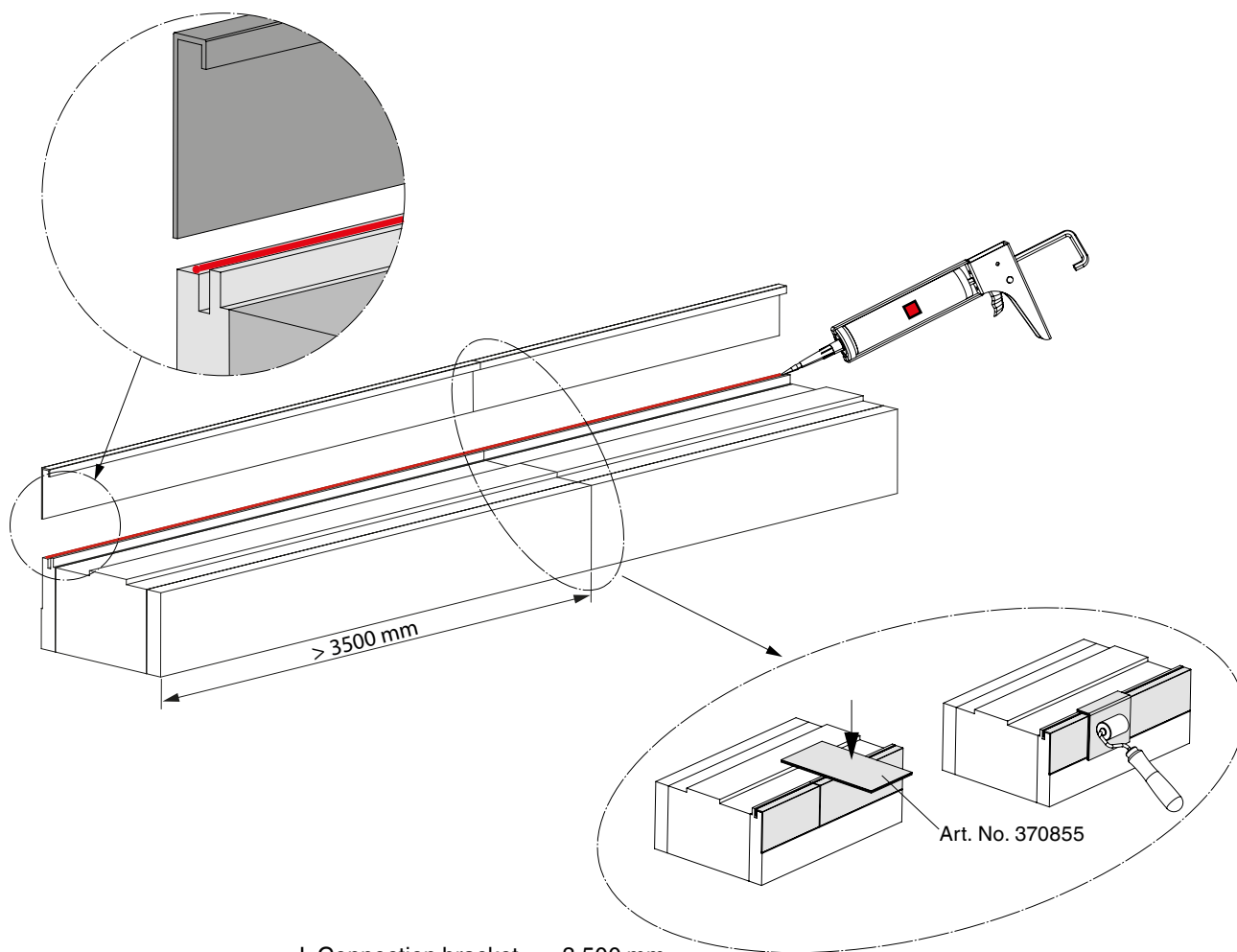

b) Bond substructure

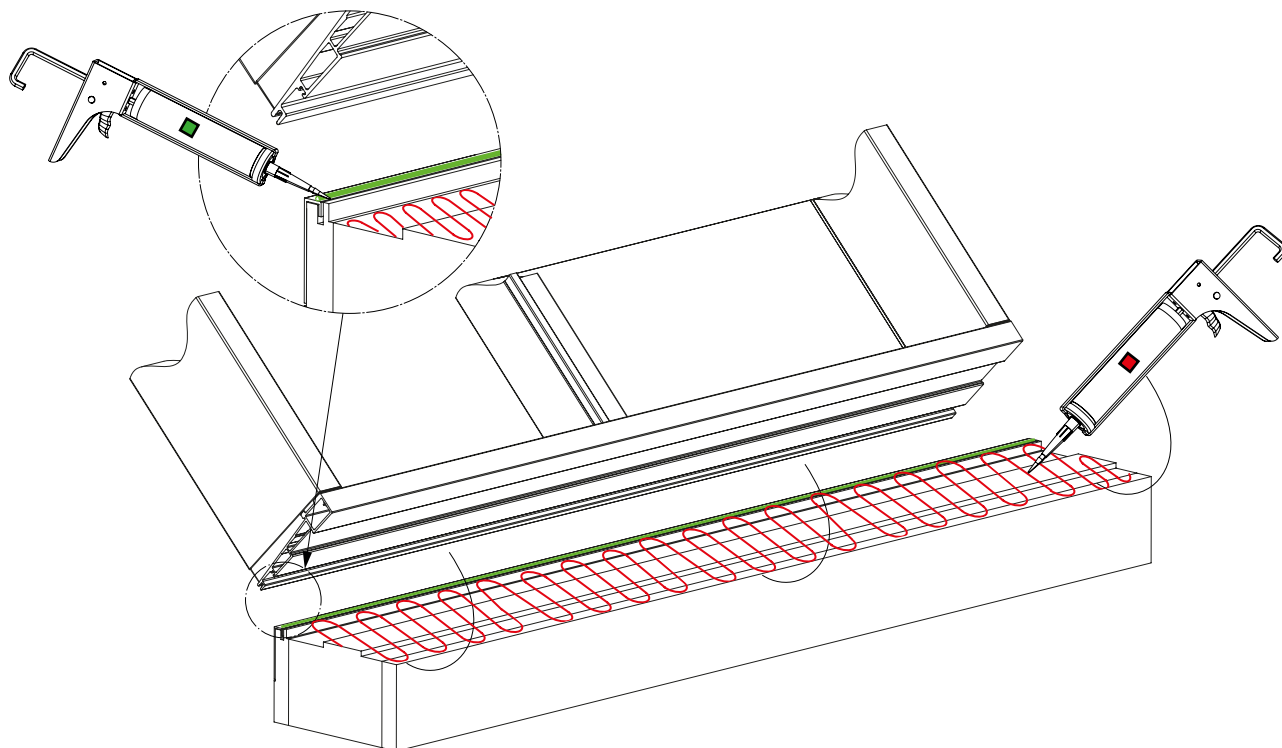

c) Assembly fixing

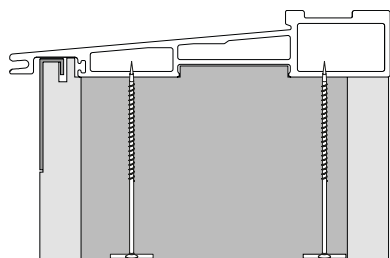

Attention - screw length!

- ① Timber screw with large disc head 6x ...
(construction side)
- ② Shim 440 M8 (construction side)

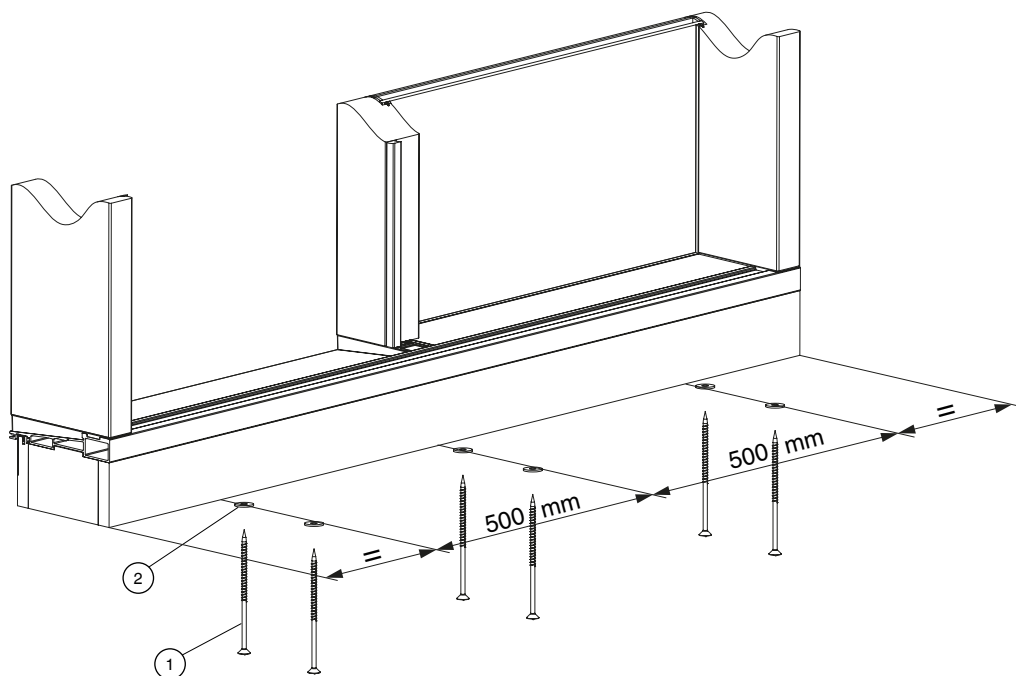

3. Installation in structural opening version 1

a) Even out upper edge of finished floor (OFF) with doubling profile

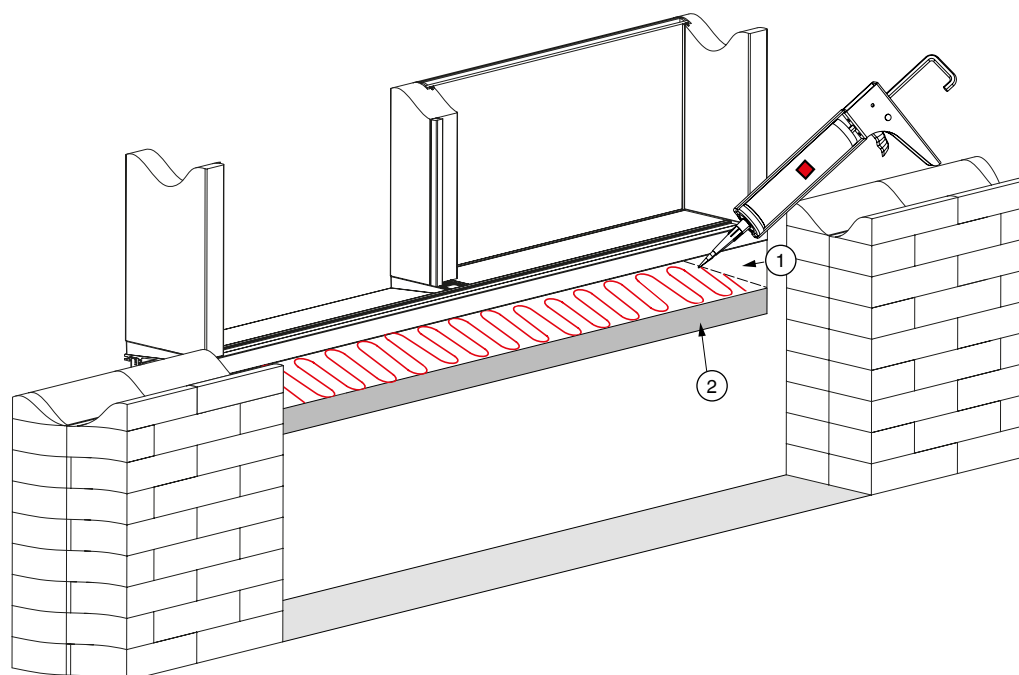
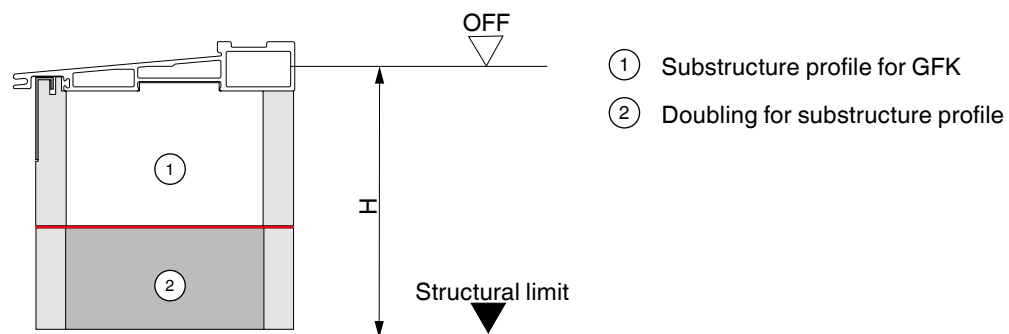

b) Align element horizontally and insert support blocks

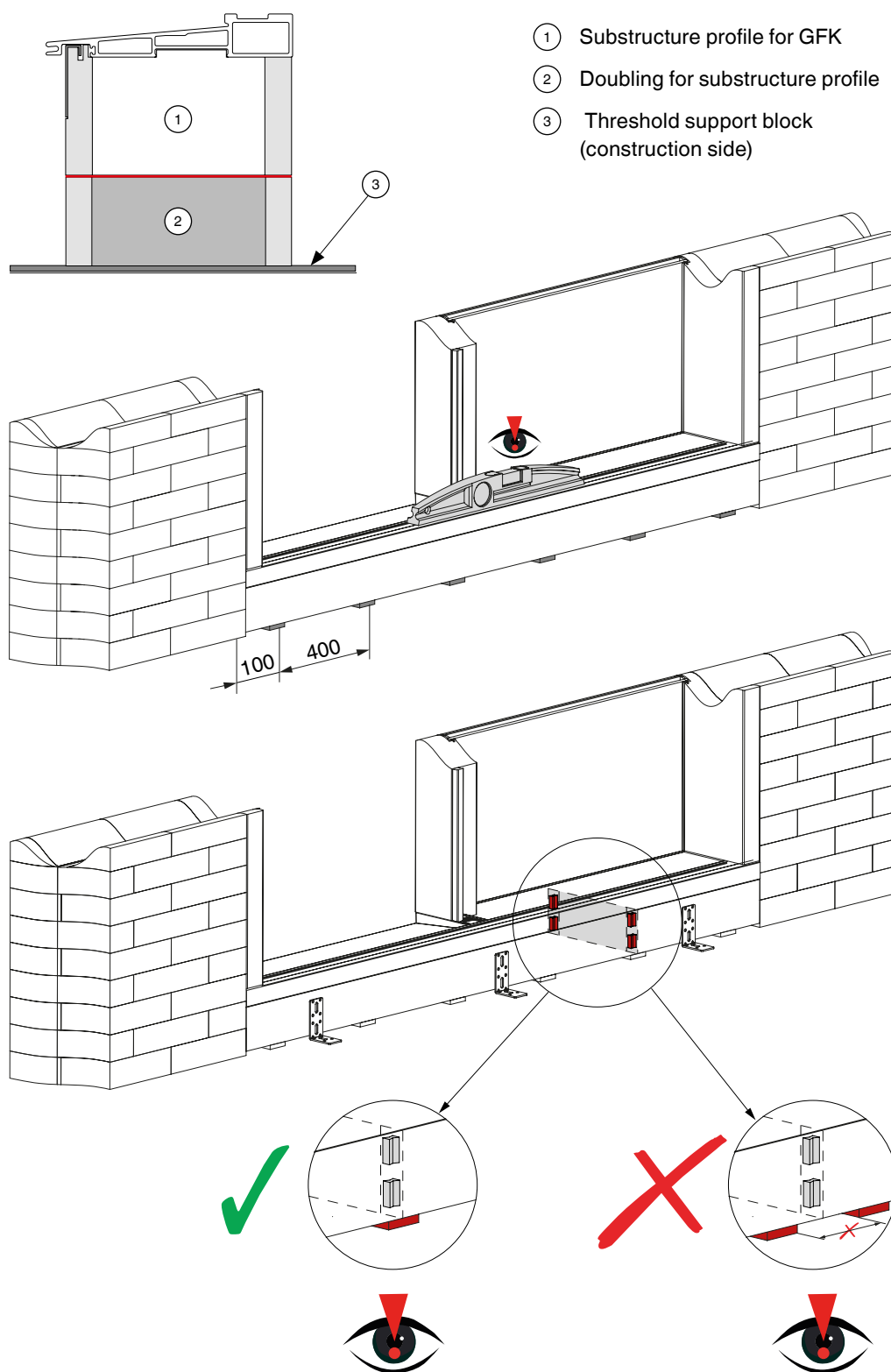

4. Installation in structural opening version 2

a) Place additional profile in structural opening on mortar bed and screw

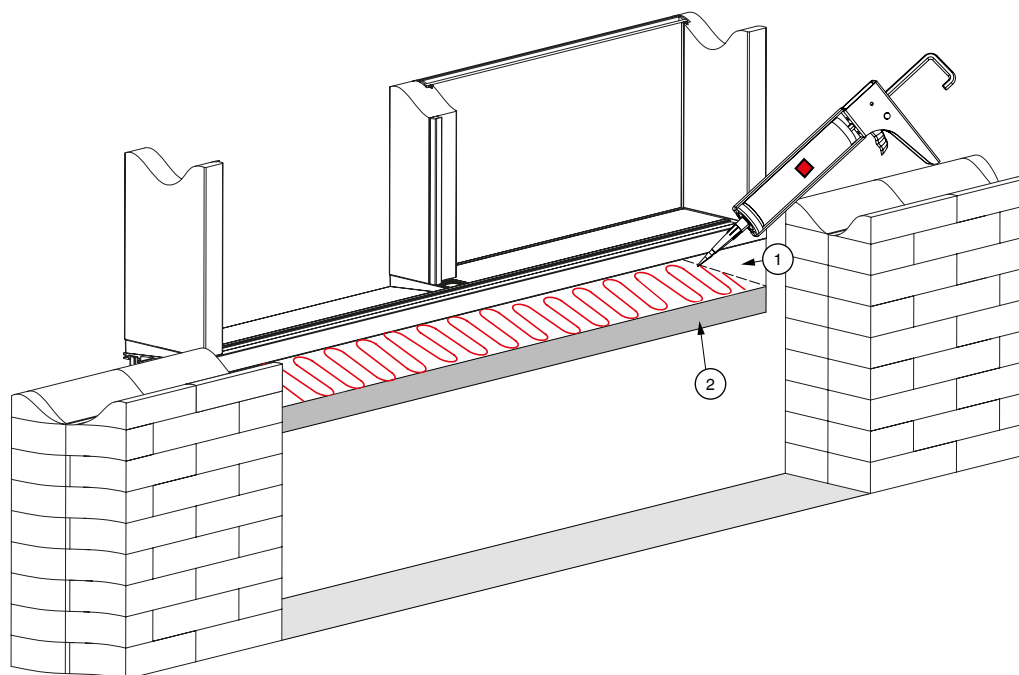
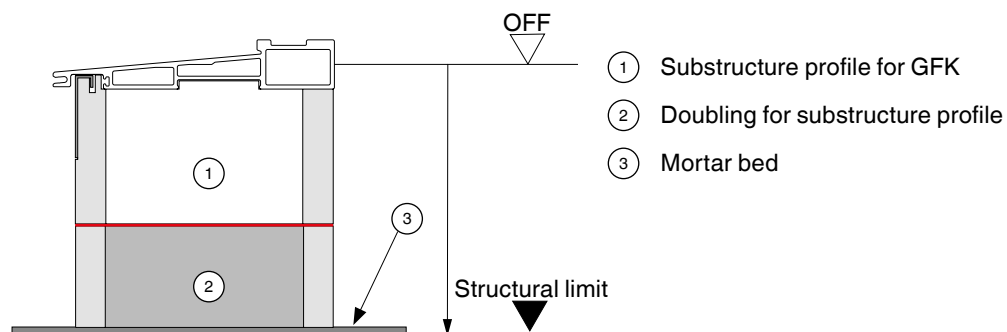

b) Attach element to doubling profile

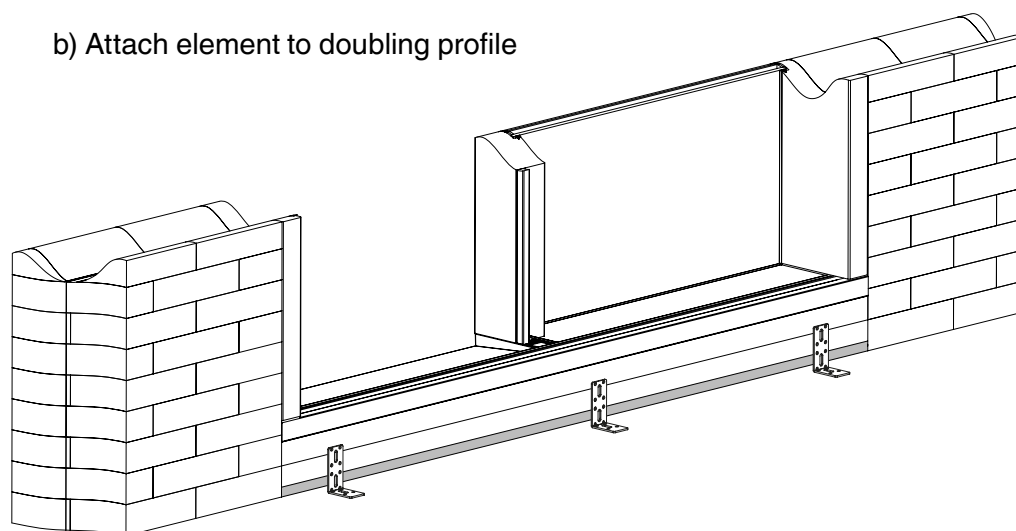



Notes

A large rectangular area filled with a fine grid pattern, intended for taking notes.

**MACO
RAIL-SYSTEMS**



**MAYER & CO
BESCHLÄGE GMBH**

Alpenstraße 173
A-5020 Salzburg

Tel.: +43 662 6196-0
E-Mail: maco@maco.eu
www.maco.eu

Satisfied?

We appreciate your
feedback@maco.eu

Order no. 758546EN - Date: June 2017 - Date of modification: 25.05.2023
All rights reserved and subject to change.

Graphics: MACO

This print document is revised regularly.
The latest version is available at
<http://www.maco.eu/sites/assets/MacoDocs/758546/758546en.pdf>
or scan the QR code.

