

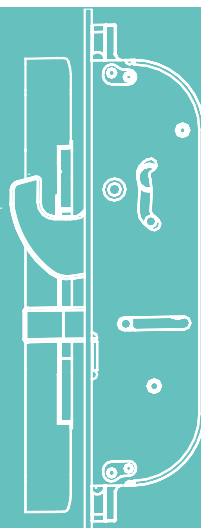

TECHNOLOGY IN MOTION

MACO PROTECT

DOOR LOCKS

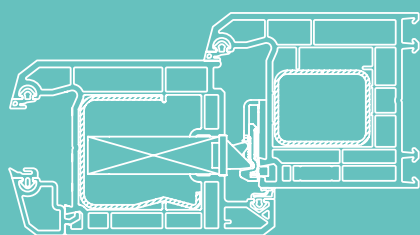

ASSEMBLY INSTRUCTIONS

G-TS MODULE – Handle operated modular door lock PVC

Exclusively for certified specialists!

Table of contents

Important Information	4 - 10
Introduction	4
Informative note, Key	5
Intended use	6
Improper use	6 - 9
Use of transportation protection devices	10
<hr/>	
Maintenance	11
<hr/>	
Latch adjustment	12
<hr/>	
Installation Instructions	13 - 14
Position latch and dead bolt striker plate	13
Position hook-bolt striker plate	14
<hr/>	
Drilling and routing patterns	15 - 17
Millings lock cases	15
Latch and dead bolt striker plate, hook-bolt striker plate	16
PVC series ZA, PVC series U-Profile	17
<hr/>	
Uniform box positions	18
<hr/>	
Positioning of the striker plates	19 - 22
2 hook-bolt combination	19
2 hook-bolt combination + 2 i.S. security roller cam	20
4 hook-bolt combination	21
4 i.S.	22
<hr/>	
Upper variable box position	23



Possibility of lengthening with intermediate faceplate	24
<hr/>	
Faceplate modules variable	25
<hr/>	
Door constructions	26
<hr/>	
Modular door lock system Protect Modul	27

Important Information

Introduction

Read these instructions carefully before starting the A-TS assembly. Mount all hardware parts professionally as described in this manual and observe all safety instructions. Failure to follow these instructions cannot guarantee the proper functioning of the system. In the event of non-compliance, we assume no liability for damage to persons or material.

Match the required fixing material with the building structure and the corresponding load and expand on it if necessary. Any supplied fixing material only meets a part of the requirements.

Target audience for this guide

This documentation is intended exclusively for specialist companies and certified specialists. The work-steps described herein may only be carried out by certified specialists.

Retention of documents / briefing

Retain these assembly instructions for later use and maintenance.

Hand over the user manual (downloadable under maco.eu - Order No. 757585) to the end user and ensure they are briefed.

Installation and operation

Before installation - test doors and safety elements. The integrity and smoothness of the doors must be ensured.

All work (assembly, adjustment, etc.) must be carried out in a powered-down state.

Before installing the drive motor, the current temperature range must be checked for environment suitability.

To fix the hardware, use sufficiently long screws which must extend into the steel reinforcement when using PVC profiles.

Unless otherwise indicated, all measurements are made in millimetres.

All diagrams are only symbolic.

Printing errors, mistakes and changes are reserved.



Important Information

Informative note



This indicates important additional information that is important for the error-free assembly of the product.

Key



Backset DM

FFH Sash rebate height



Distance E

K+ Case dimension top



Handle height GM

K- Case dimension bottom



Profile Front Edge

ZA Zamac alloy

MF Multi-function latch



Important note

EV End piece

Important Information

Intended use

- › The G-TS is intended to be installed in vertical front doors, apartment doors and side doors made of PVC, timber, aluminium or steel and combinations thereof.
- › Mount all hardware parts professionally as described in this manual and observe all safety instructions.
- › When screwing in, make sure that the cables are not damaged by the fastening screws!
- › Before installation, ensure that all components are in perfect condition - damaged or faulty components must not be used under any circumstances. Use G-TS only in a perfect condition.

Improper use

- › The G-TS must NOT be used for escape or panic doors according to EN 179 or EN 1125.
- › The hardware parts described in this guide are made of stainless steel or galvanised passivated steel and sealed in accordance with DIN EN 12329. They must not be used in environments with aggressive, corrosive air content.
- › Do not use acid-curing sealants, as these can lead to corrosion of the hardware parts.

Improper assembly, misuse or unusual use, the use of system accessories not expressly approved by MACO, or modifications or repair work not expressly approved by MACO may lead to malfunctions and must be avoided. Any measures not expressly permitted by MACO shall result in the loss of all liability, warranty and, if necessary, separately agreed warranty claims.

Important Information

Improper use

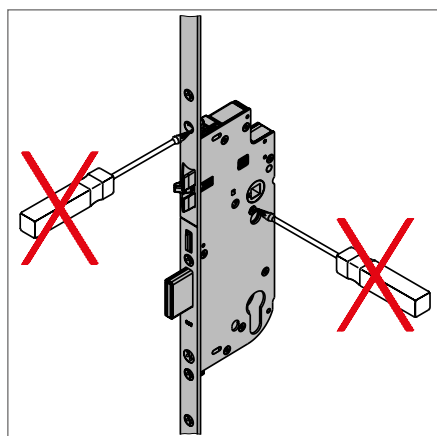

Never open the lock case!

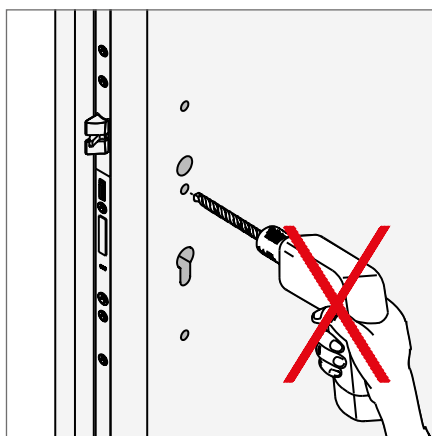

Drill all holes before installation of the lock.

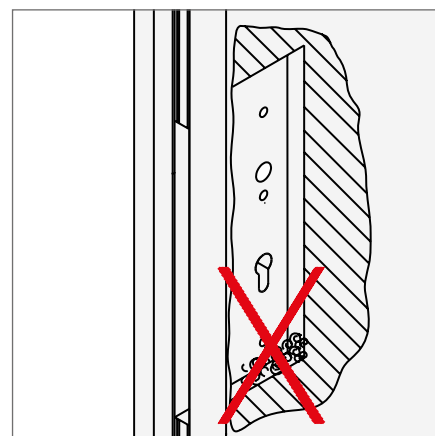

Remove swarf from the routing pockets!

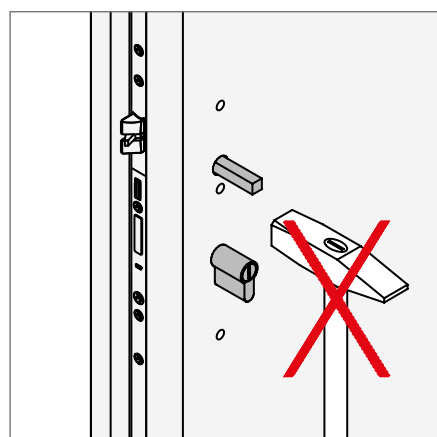

Do not force the handle pin through the lock nut!

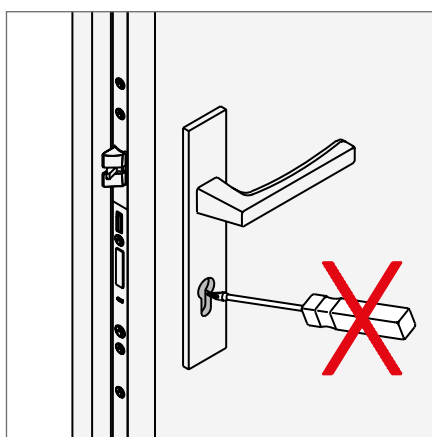

Only close the lock with the corresponding operating key!

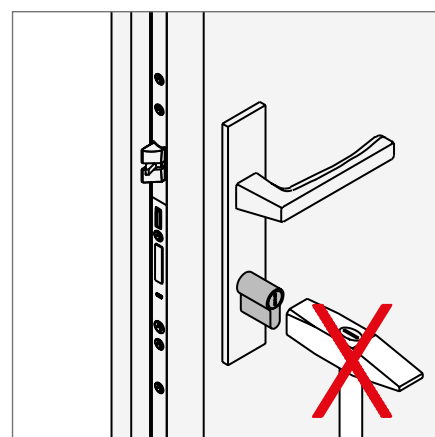

Do not use force during the cylinder assembly!

Important Information

Improper use

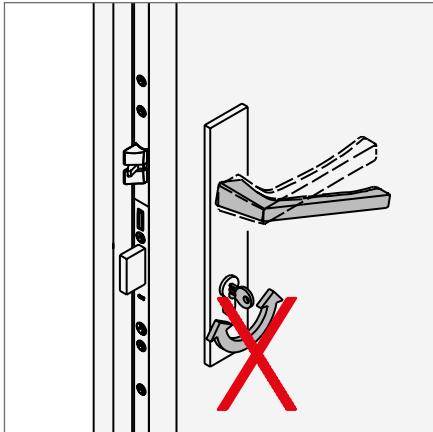

Do not simultaneously press the handle and turn the key!



Do not turn the key using force!
The latch of the main lock must not rub against the striker plate – this also applies to multi-point locks without door acceleration, and all latches of the side locks. For this, use the adjustment option on the striker plates and door hinges. Adjustment of the holes in the striker plates is not permitted.

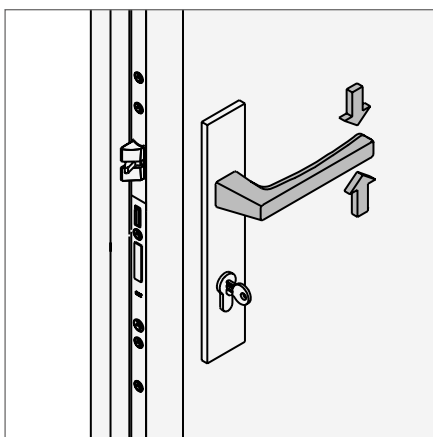

Only apply load to the handle in the normal direction! Apply a maximum force of 15 kg in the direction of actuation (on the handle).

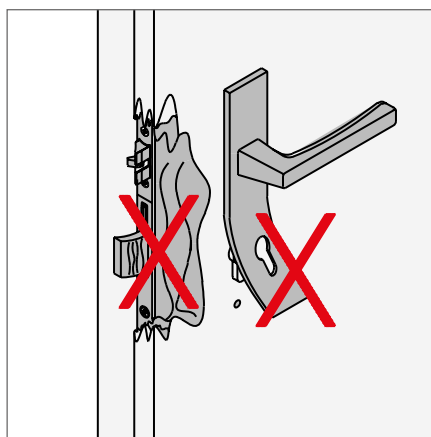

The multi-point lock must be replaced as soon as traces of use of force are visible!

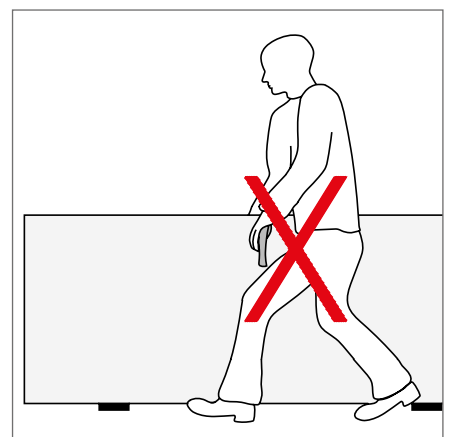

Do not carry the door leaf with the handle!

Important Information

Improper use

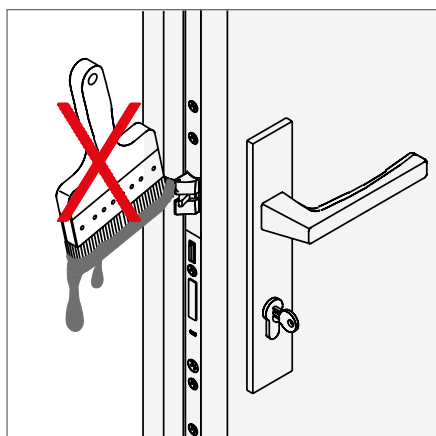

Do not paint or varnish over the padlock bolt or latch!

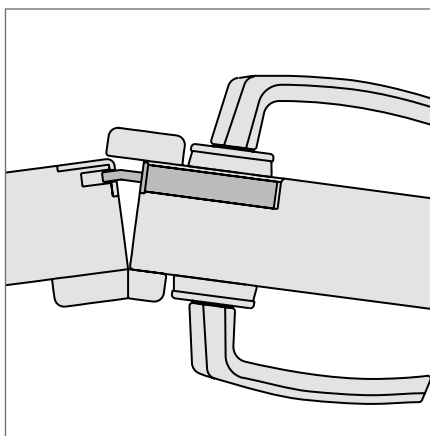

Double-sash doors must not be forced over the inactive leaf!

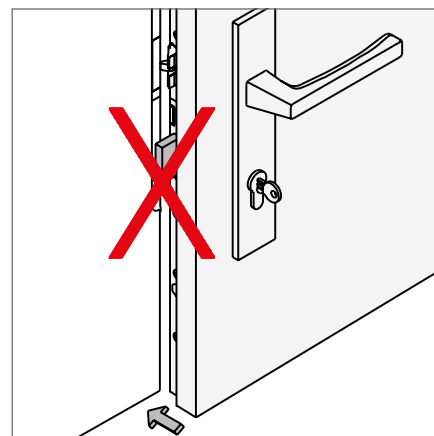

Do not lock the locking bar when the door is open!

Important Information

Use of transportation protection devices

Simple transport protection devices, wedges or blocks ensure a safe transport of the entire door element. Remove only after installation.

Ⓐ Transport protection device position

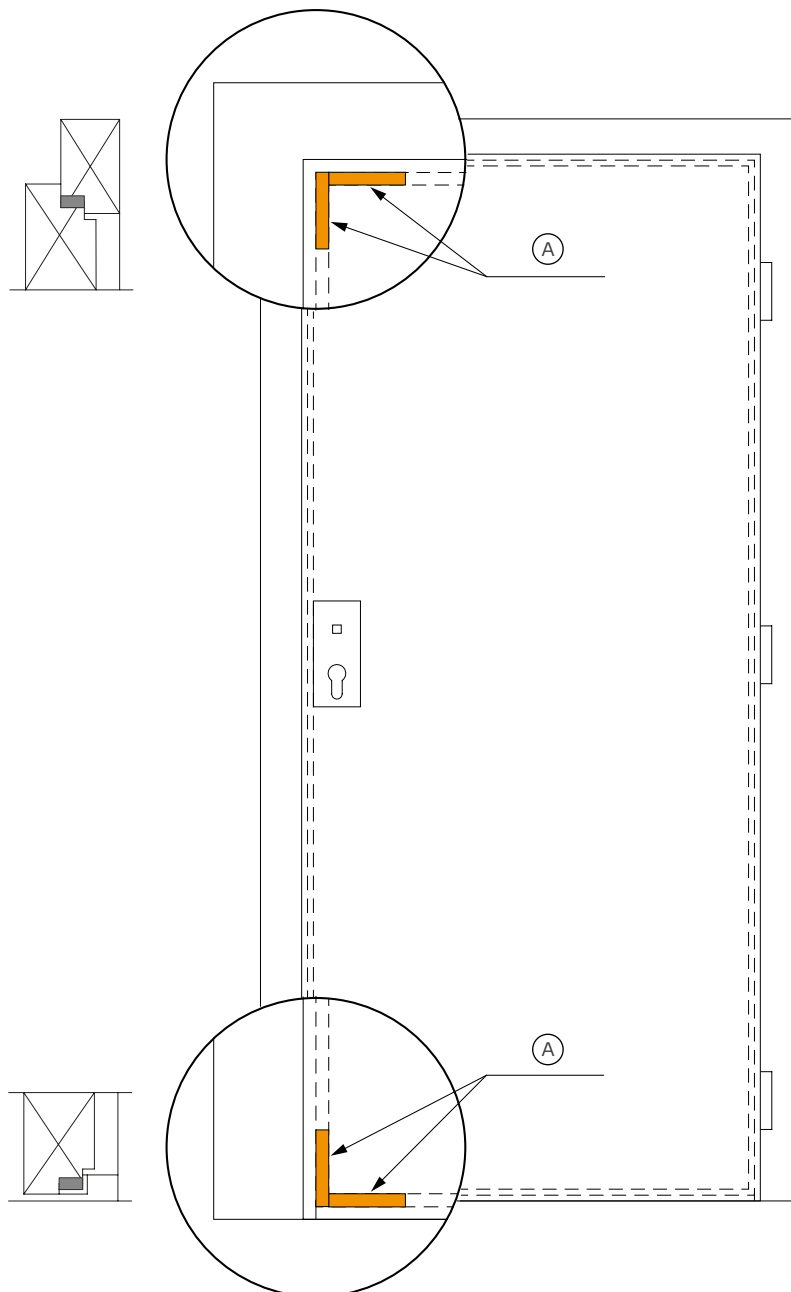

Maintenance

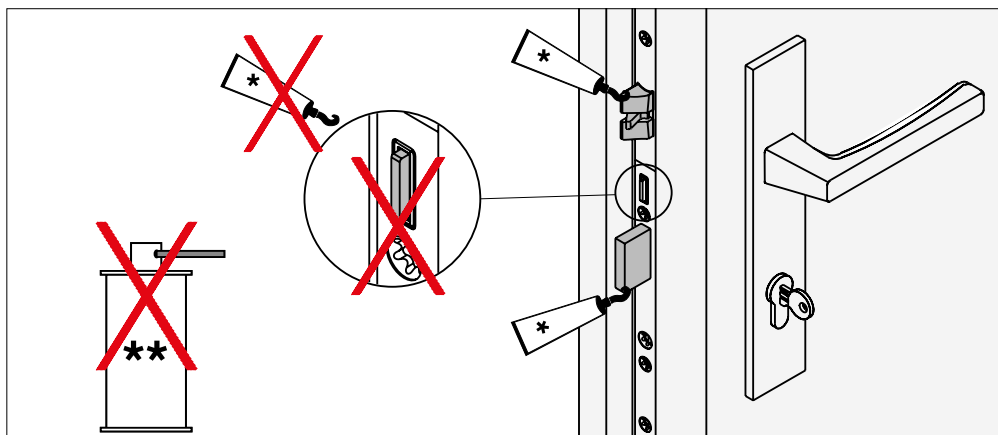

The door lock (lock case) is delivered with an intensive lubrication of high performance greases and must **NOT** be re-lubricated! Lubricate the latch and locking bolt 1x annually!

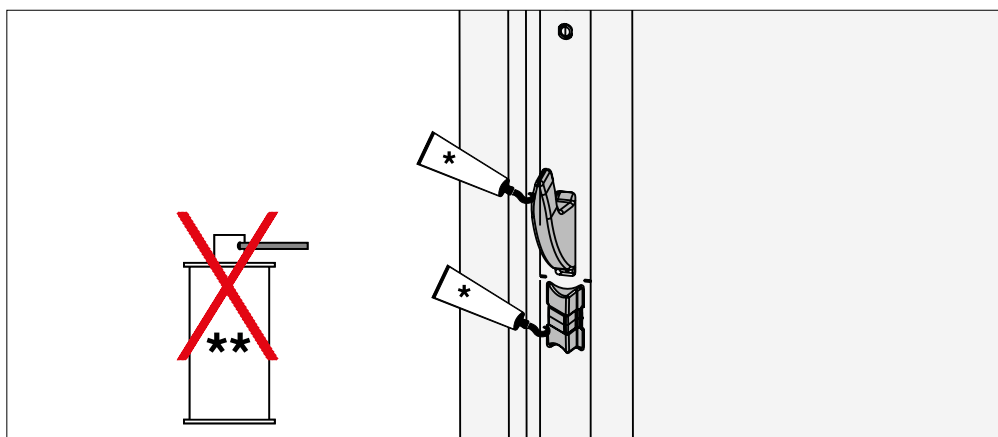

Lubricate the MF-HO locking element 1x annually!



**Do not use any lubricating oils, rust remover, silicone sprays etc!
Lubricate only with grease or technical petroleum jelly!**

* Spray grease (455341), ** Rust remover

Latch adjustment

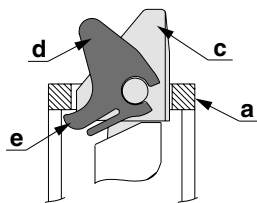
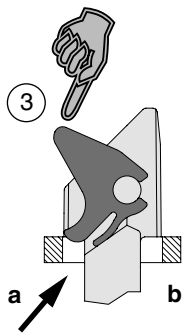

- a** = Faceplate
- b** = Faceplate recess
- c** = Latch
- d** = Latch insert
- e** = insert leg of latch insert

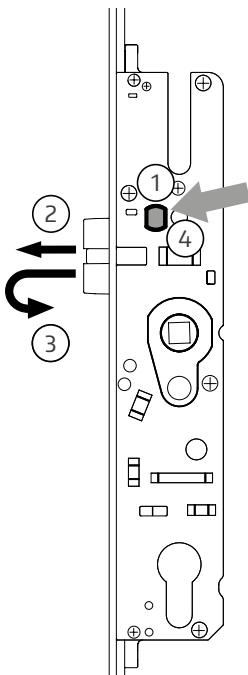

- ① Press in the button and keep it pressed
- ② Remove the latch!
- ③ Turn the latch over and place it on the faceplate (a), so that you can press the insert leg (e) of the latch insert under the faceplate recess (b).
Only then press the latch in completely!
- ④ Release button.



Perform functional check!

Installation Instructions

Position latch and dead bolt striker plate

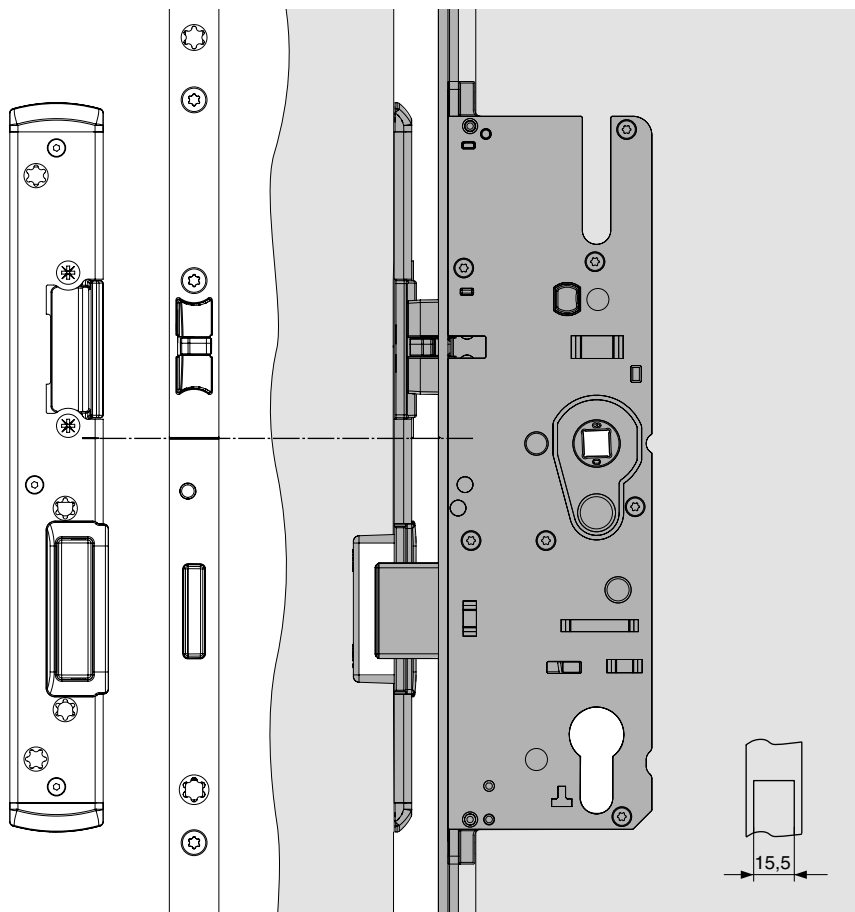

Gasket compression adjustment:

+/- 1 mm with latch and dead bolt striker

Positioning of notch faceplate = notch strike plate

Installation Instructions

Position hook-bolt striker plate

Ⓐ PVC series ZA

Ⓤ PVC series Profile

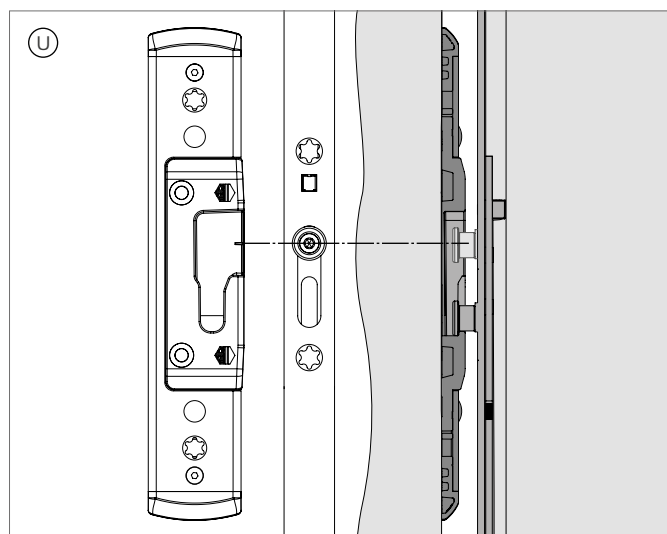
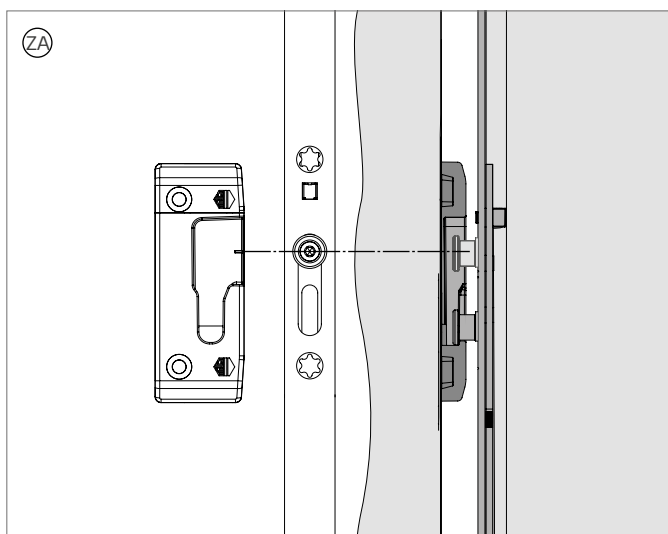
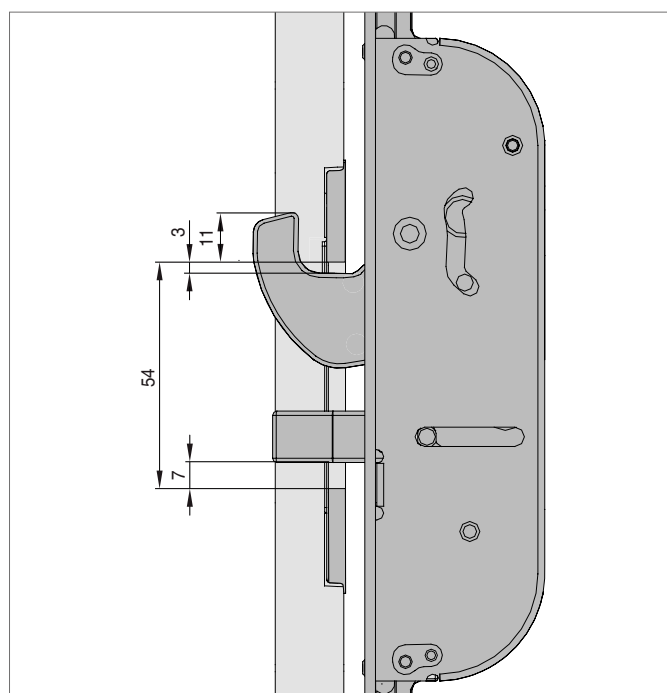
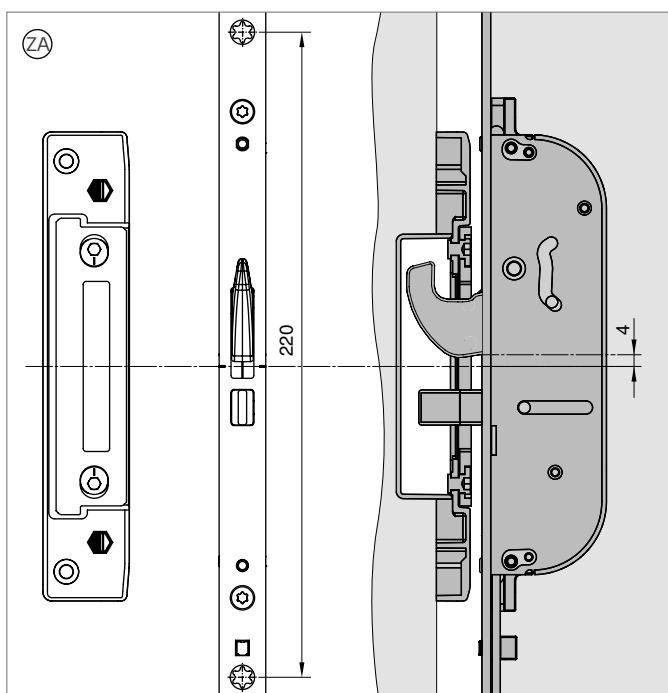

Gasket compression adjustment:

+/- 1 mm with MF-HO striker plate

Positioning of notch faceplate = notch strike plate

Drilling and routing patterns

Millings lock cases

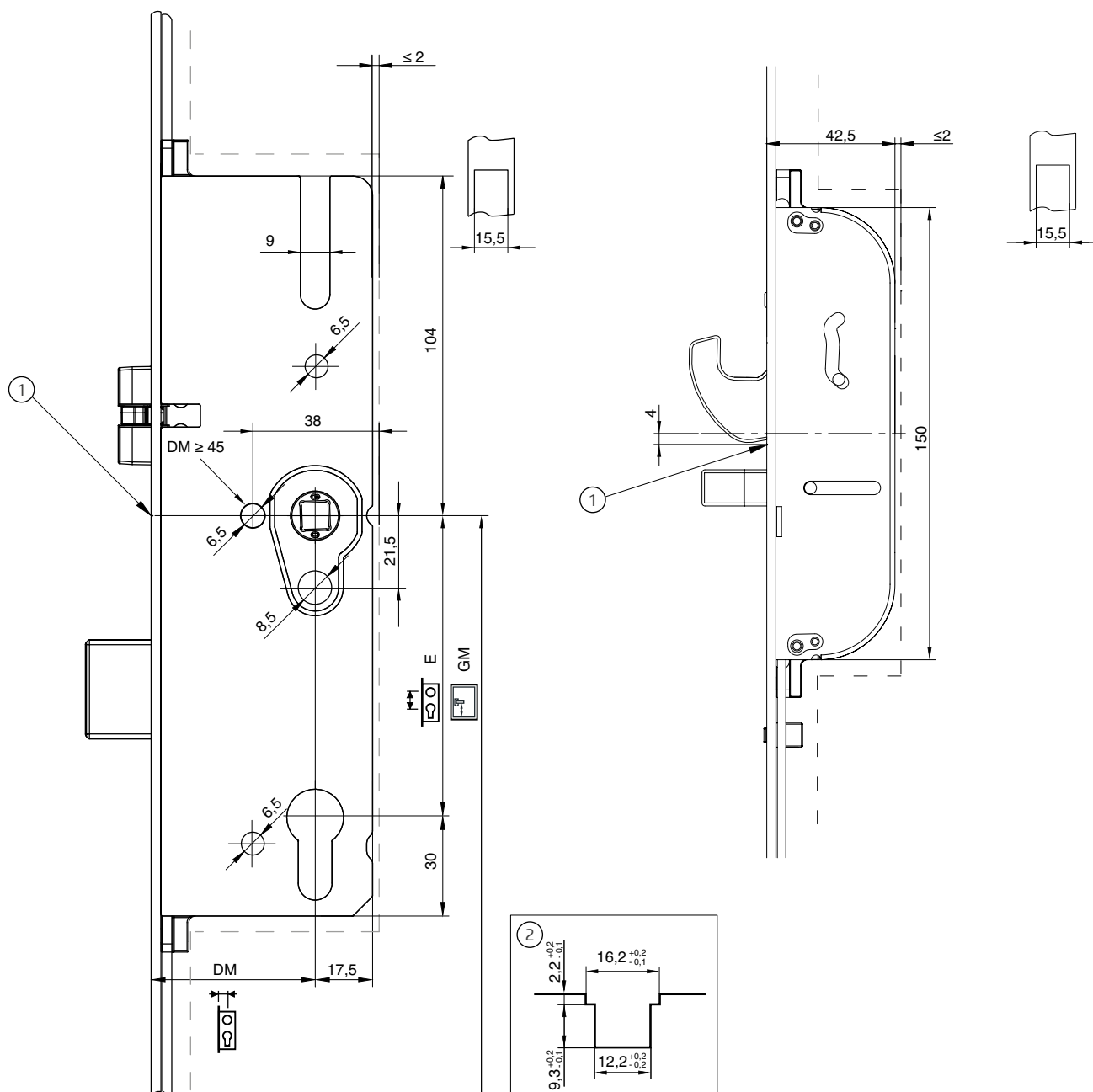

- ① Notch faceplate
- ② Hardware groove

Drilling and routing patterns

Latch and dead bolt striker plate

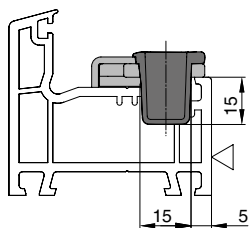

Hook-bolt striker plate

	X	
	2 HO-BO	4 HO-BO
↑	+726	+726
		+371
□	0	0
		-409
↓	-764	-764

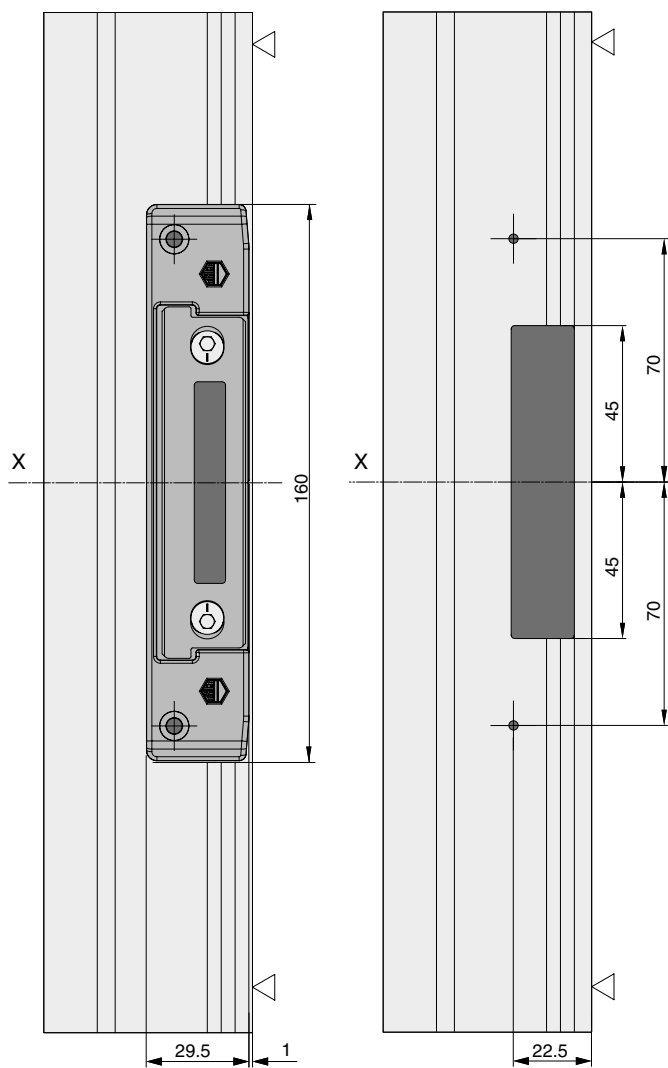
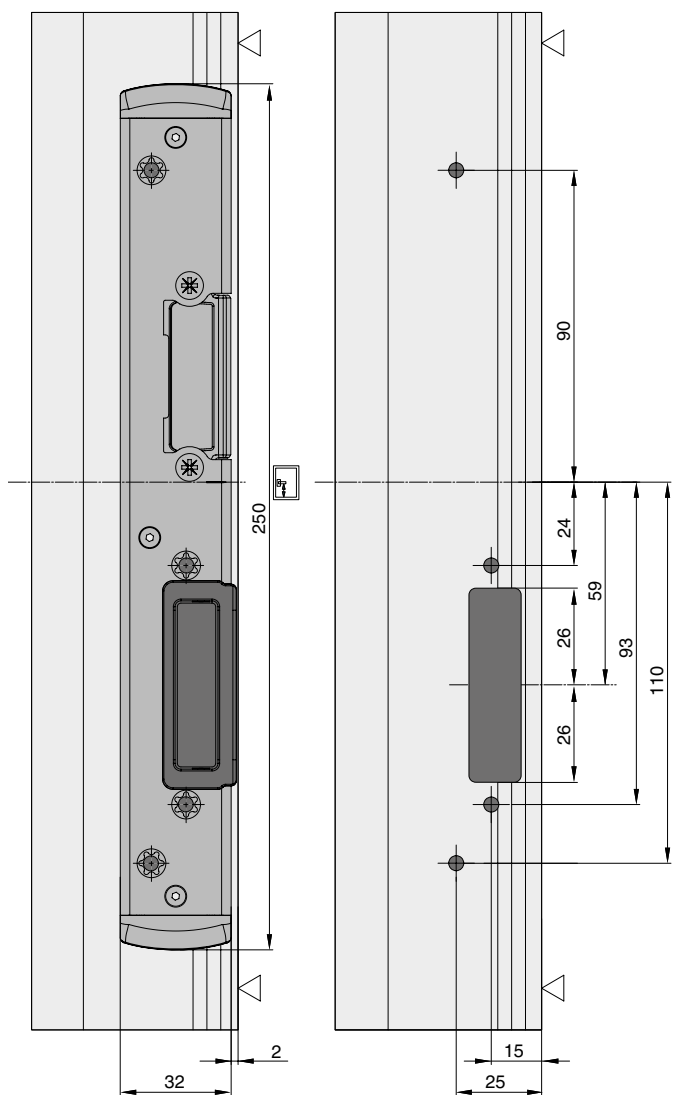
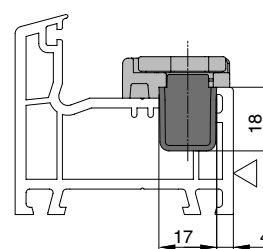

Drilling and routing patterns

PVC series ZA

	X
↑	+795
	+375
□	0
	-495
↓	-840

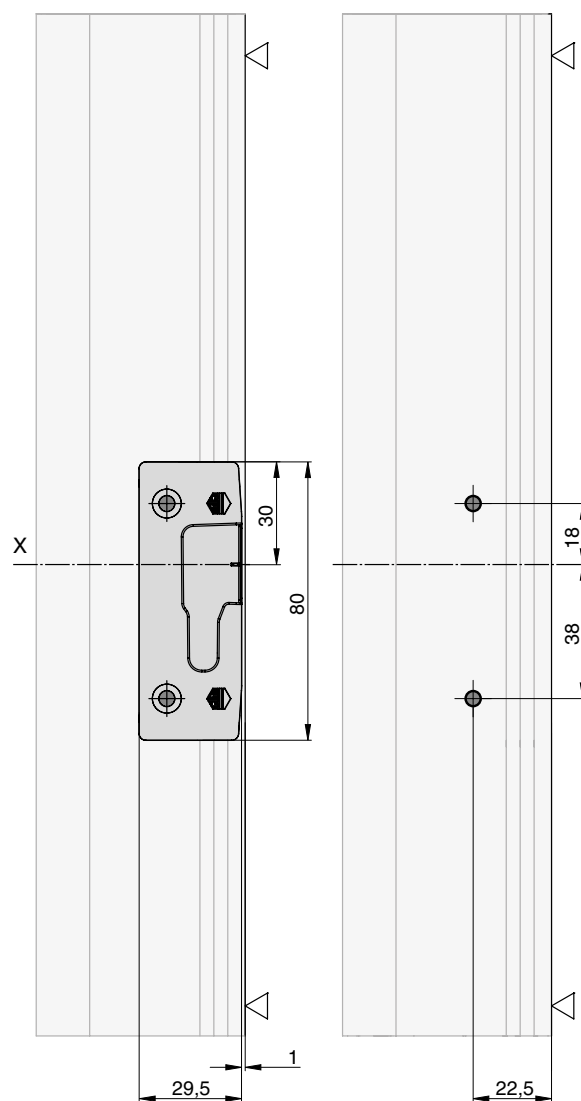
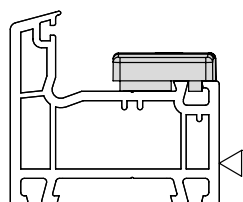

PVC series U-Profile

	X
↑	+795
	+375
□	0
	-495
↓	-840

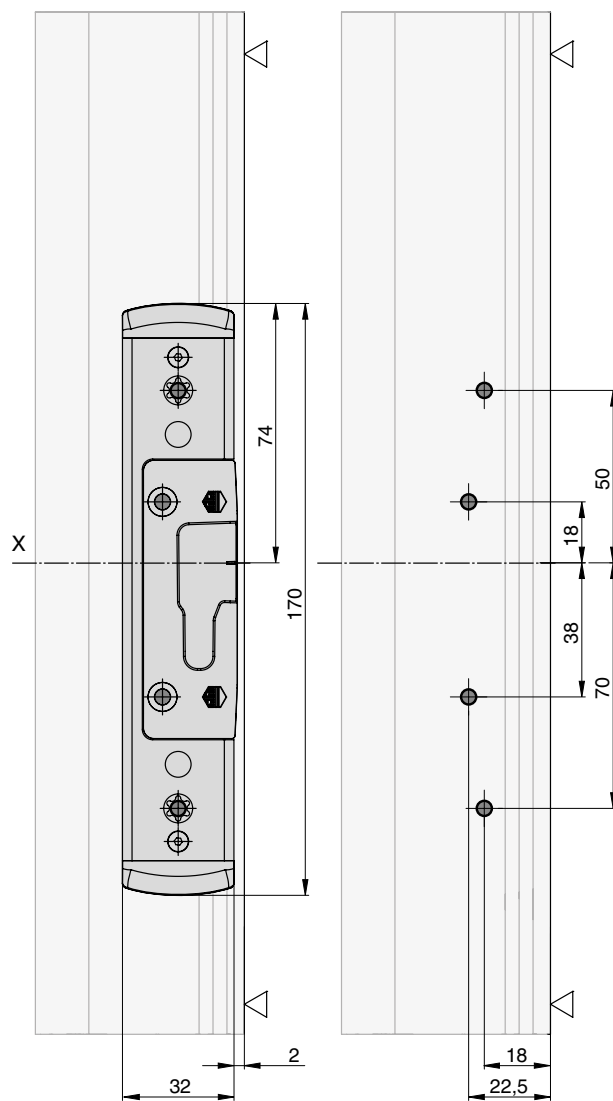
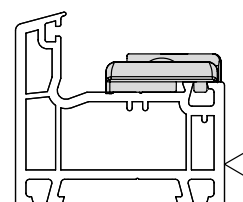

Einheitliche Kastenpositionen

- ① 2 Hook-bolt-combinations, 2 hooks, 2 bolts
- ② 4 Hook-bolt-combinations, 4 hooks, 4 bolts
- ③ 2 Hook-bolt-combinations + additional lock,
2 Hooks + additional lock, 2 bolts + additional lock

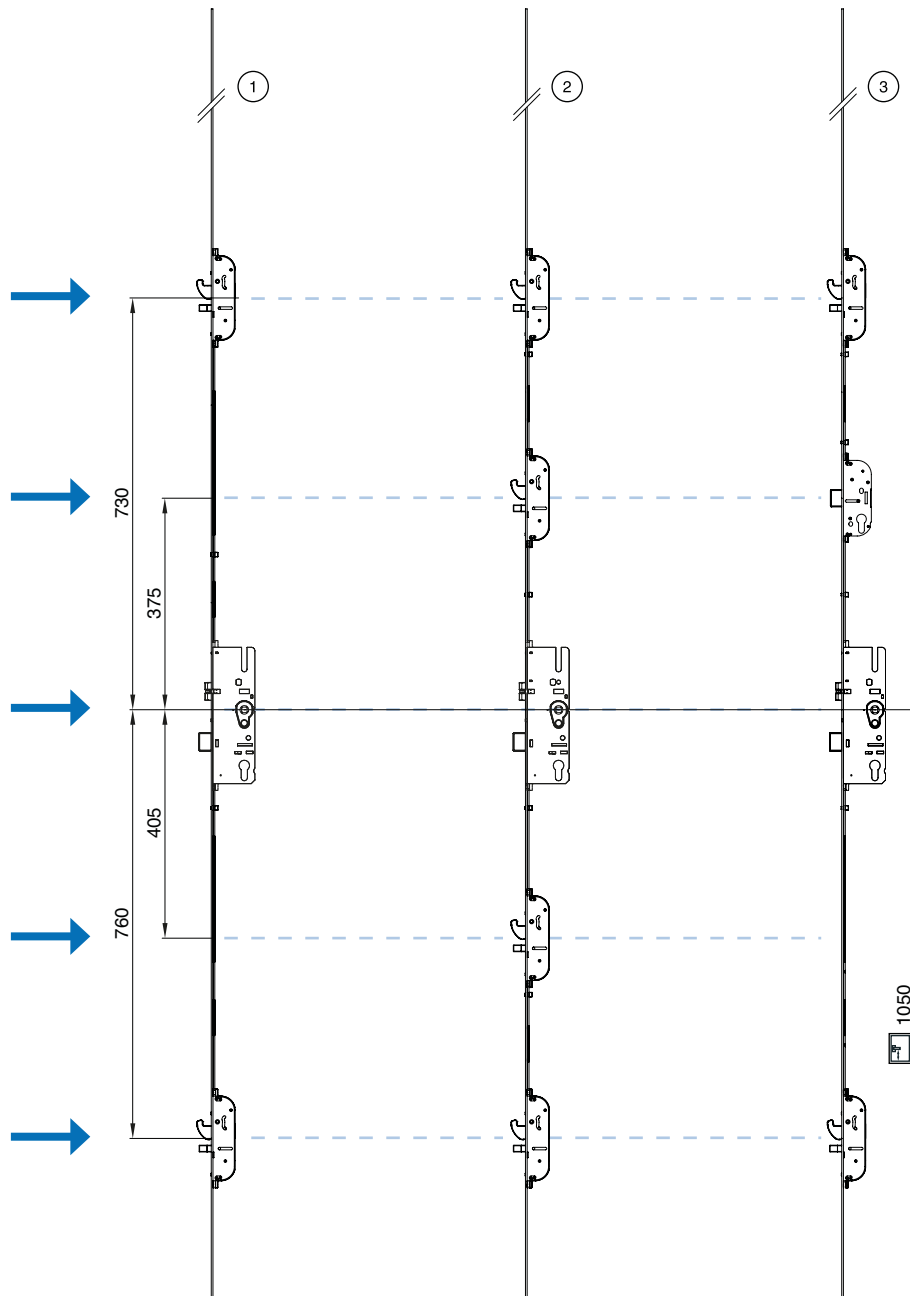

Positioning of the striker plates

2 Hook-bolt-combinations
2 hooks, 2 bolts

Ⓐ PVC series ZA

Ⓒ Single piece door striker

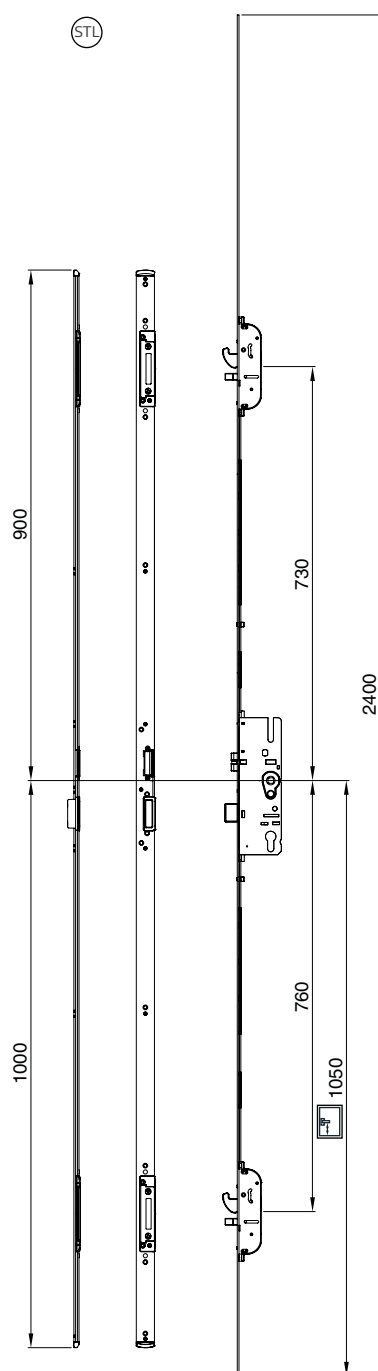
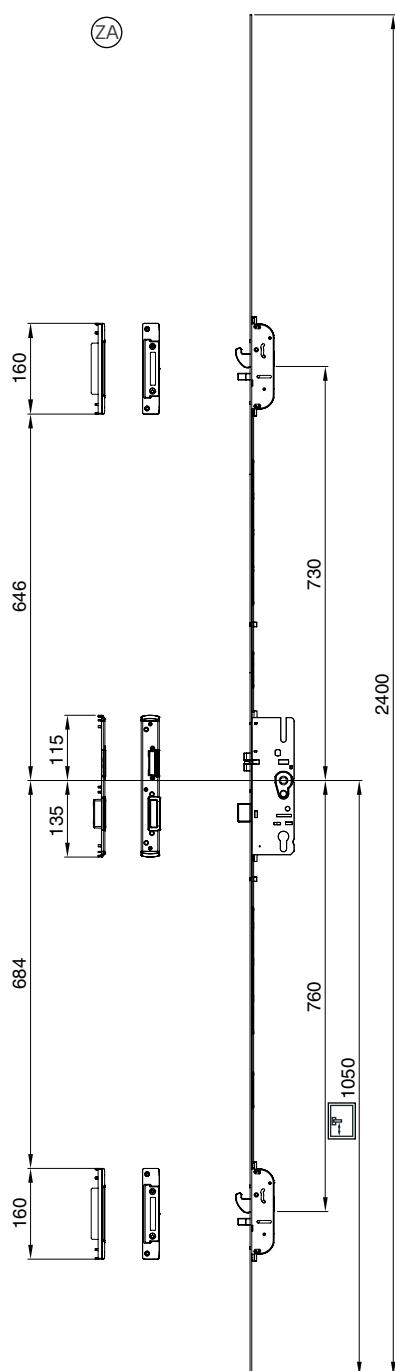

Positioning of the striker plates

2 Hook-bolt-combinations + 2 i.S. security roller cams
 2 hooks + 2 i.S. security roller cams, 2 bolts + 2 i.S. security roller cams

Ⓢ PVC series ZA

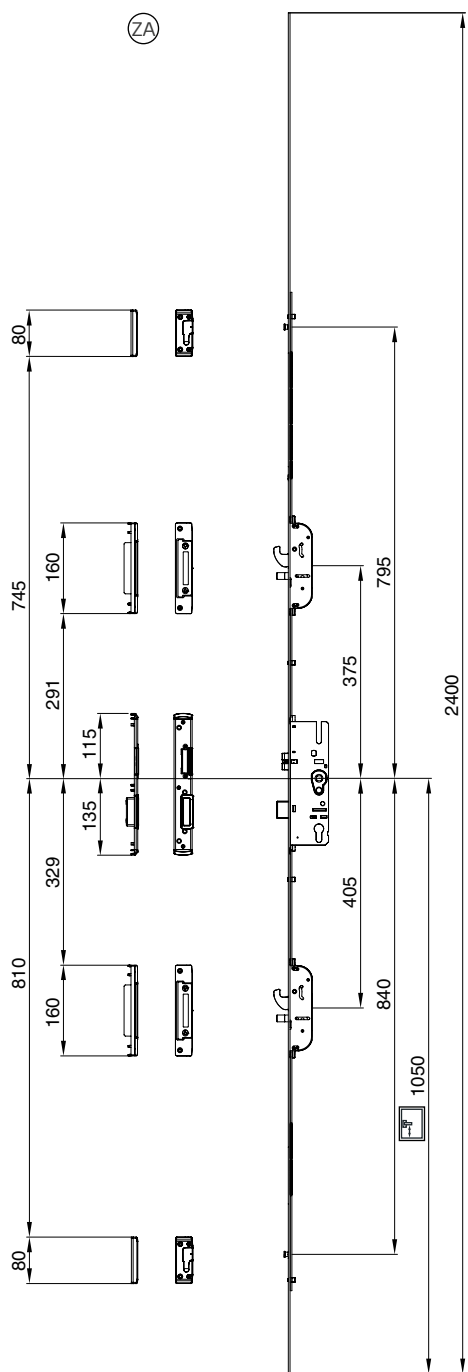

Positioning of the striker plates

4 Hook-bolt-combinations,
4 hooks, 4 bolts

Ⓒ PVC series ZA

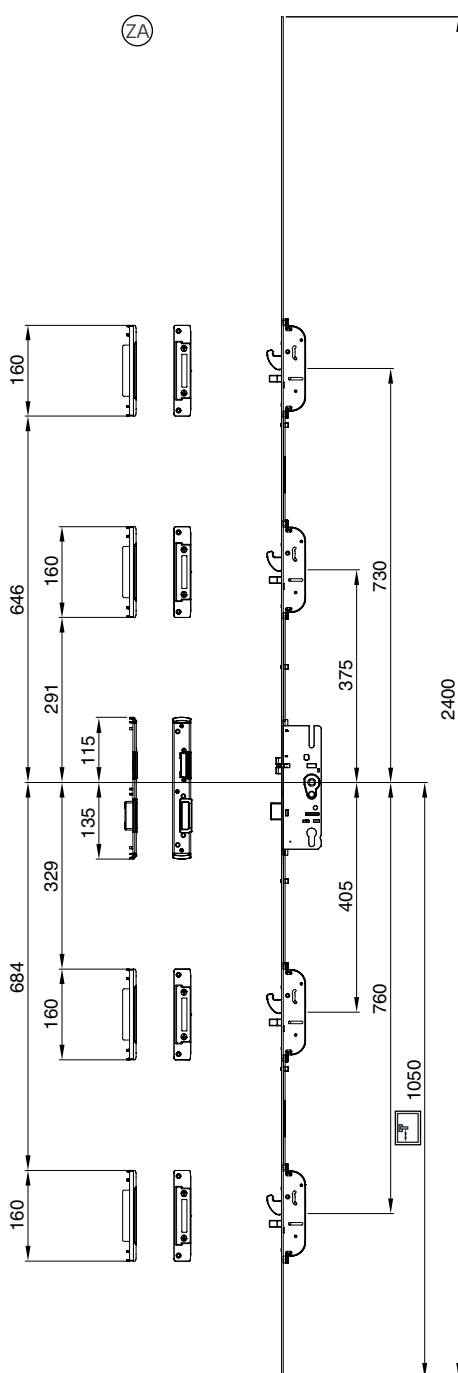

Positioning of the striker plates

4 i.S.

Ⓢ PVC series U-Profile

Ⓩ PVC series ZA

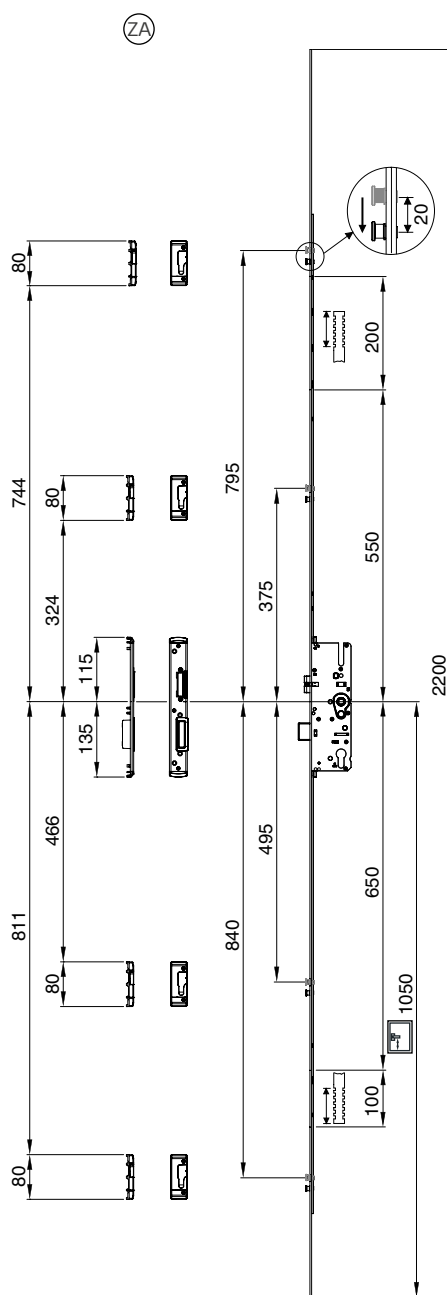
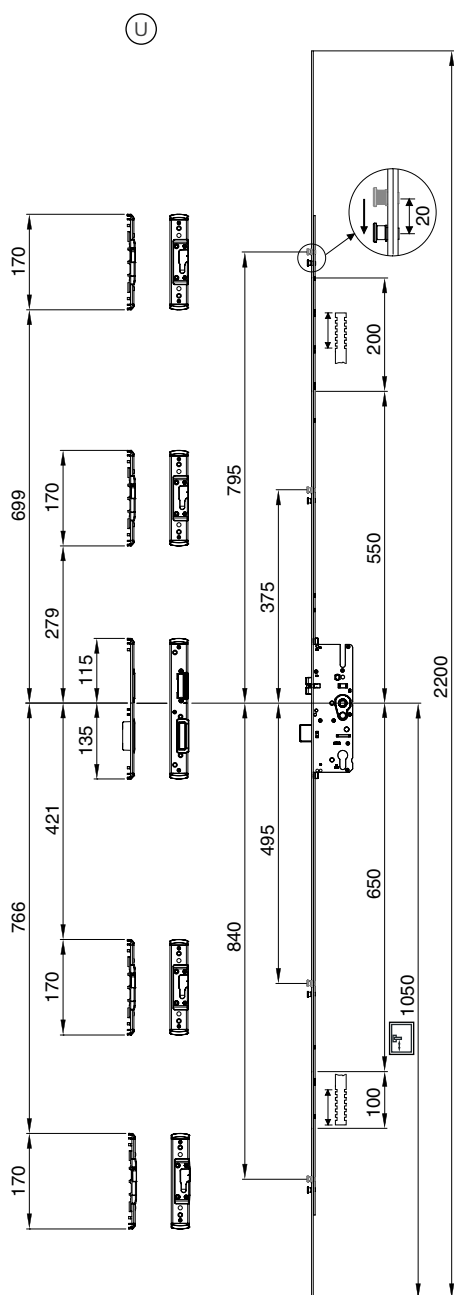

Top lock case position variable

Hook-bolt-combinations

- ① Standard lock
- ② Shortening faceplate
- ③ Lengthening faceplate

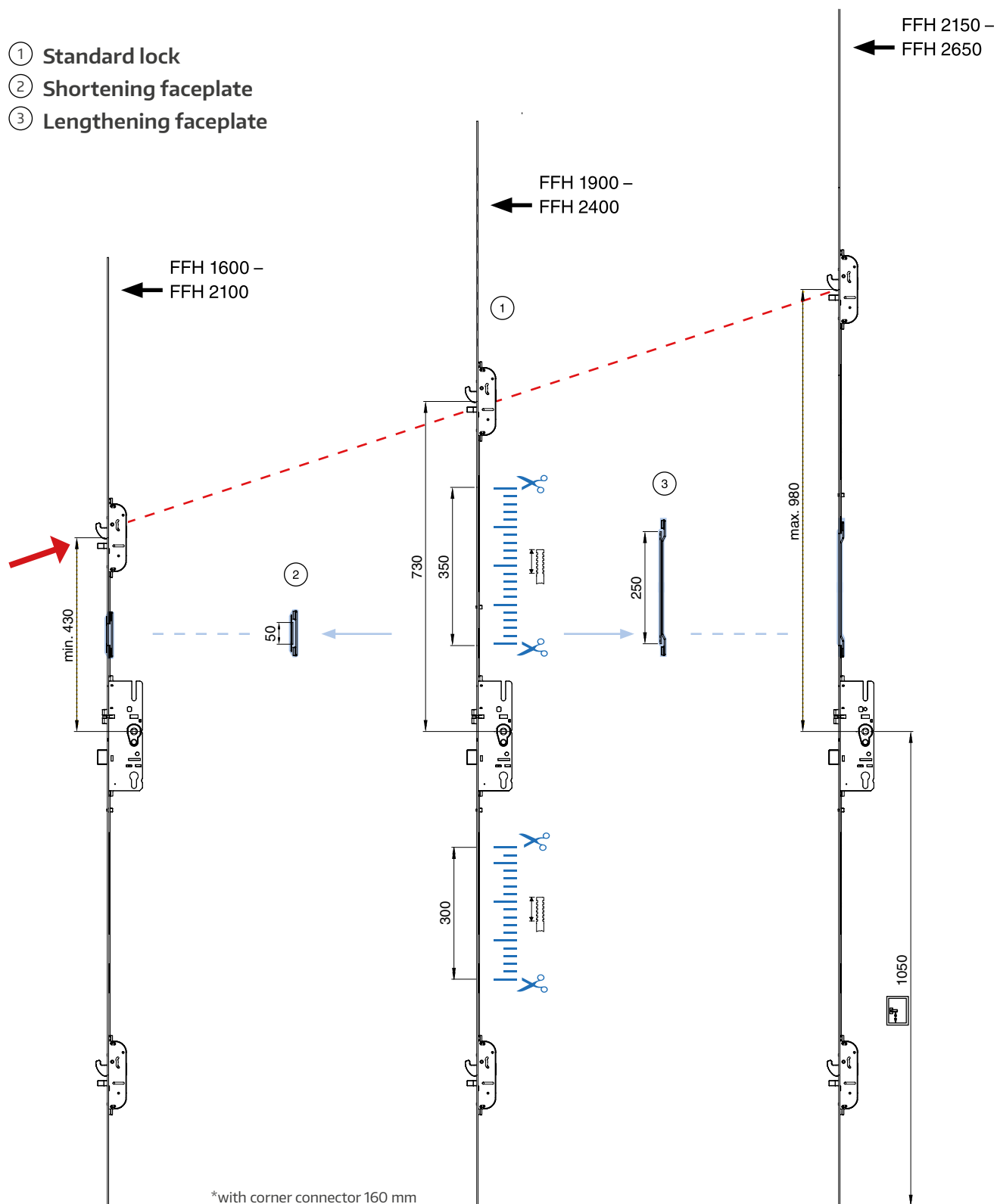

Possibility of lengthening with intermediate faceplate

- ① Standard lock
- ② Intermediate faceplate

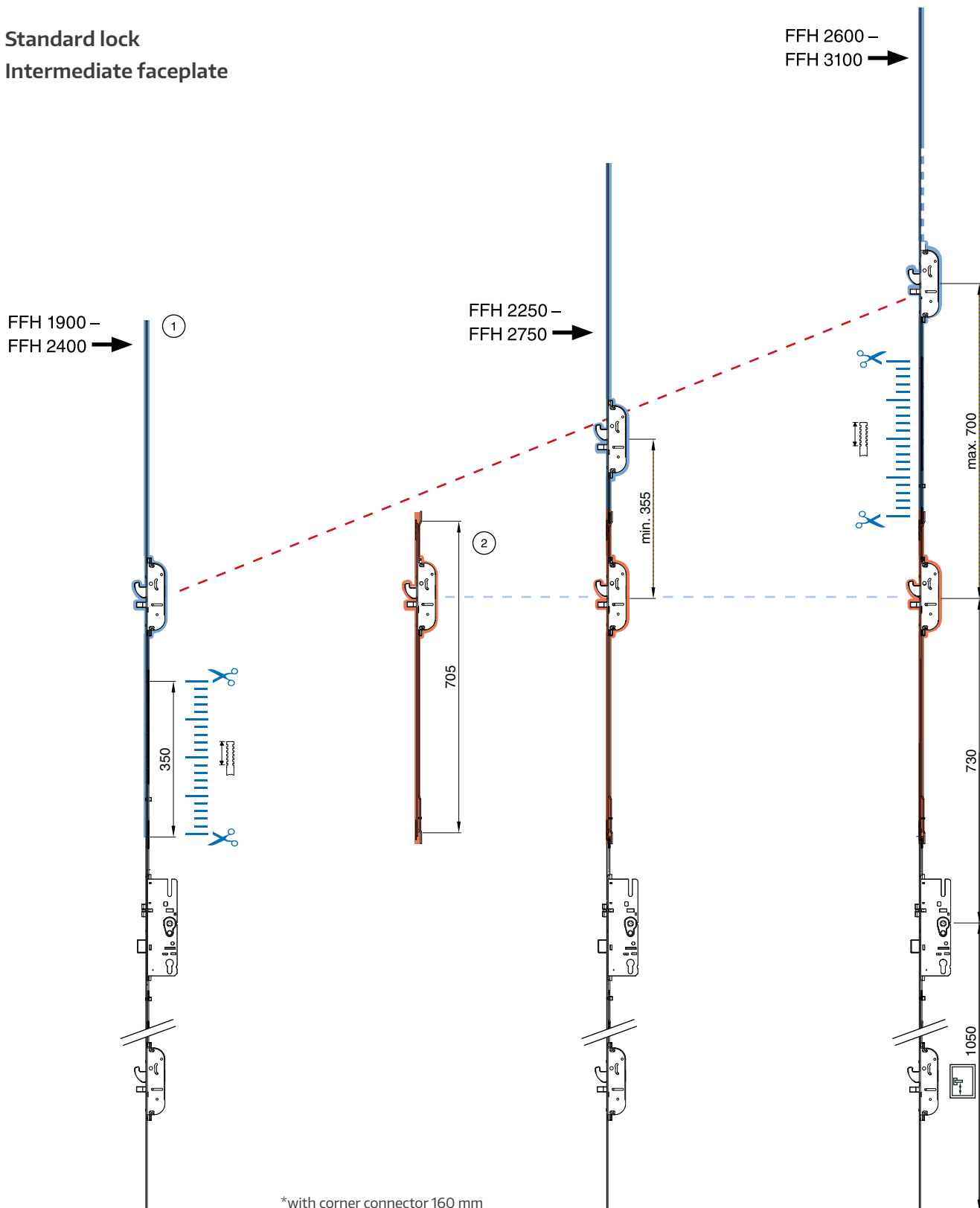

Faceplate modules variable

- ① Standard lock
- ② Faceplate module ZS
- ③ Faceplate module hook-bolt-combination
- ④ Faceplate module magnetic cam
- ⑤ Faceplate module door restrictor

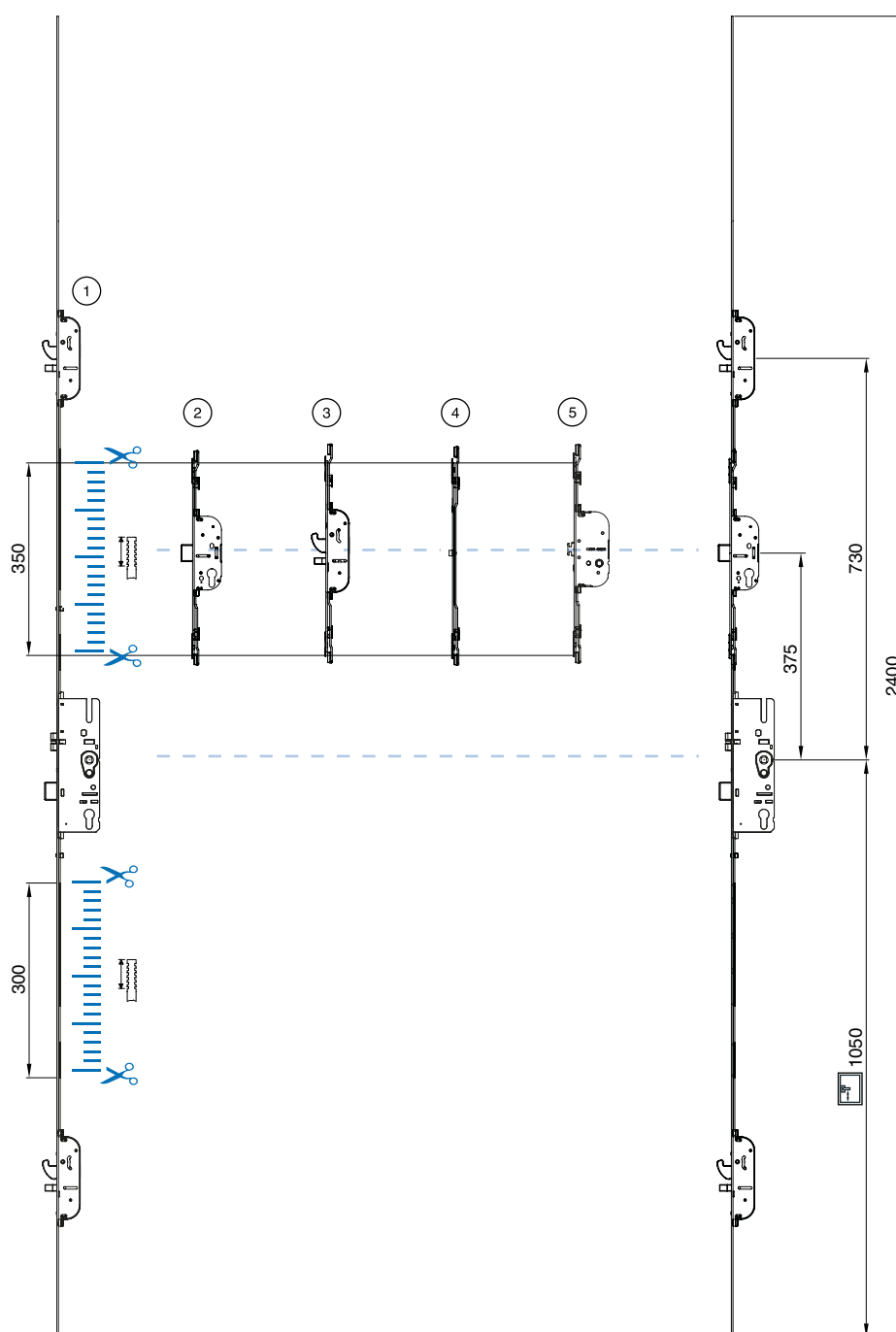

Door constructions

Single sash

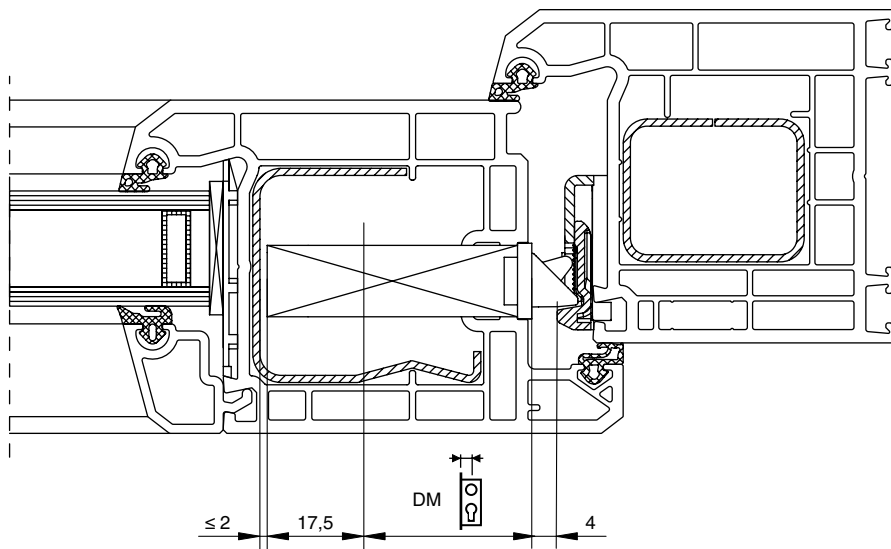

Double sash

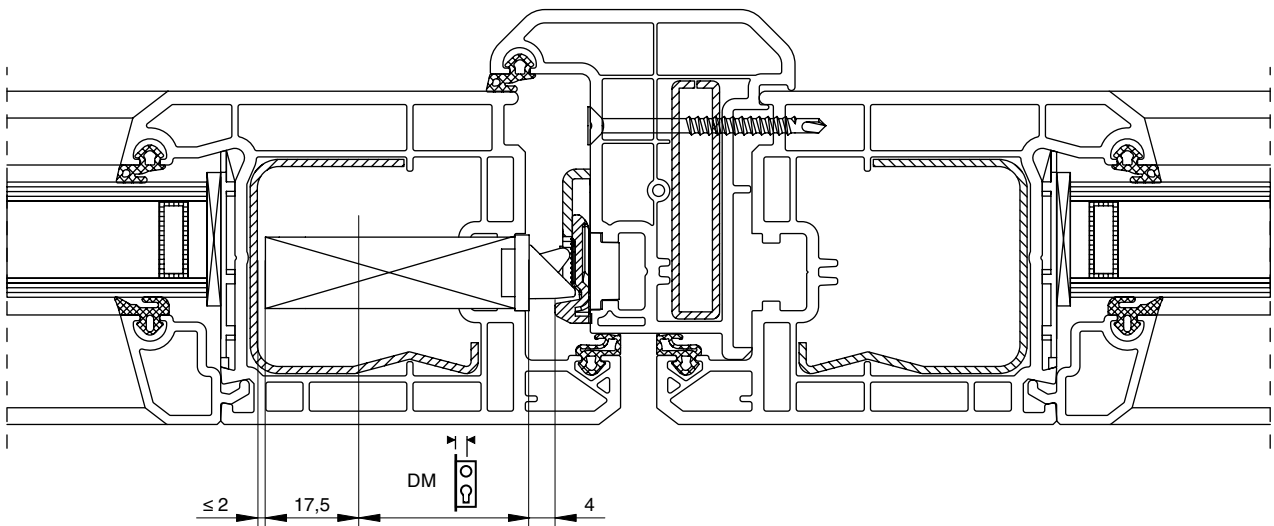

The modular door lock system Protect Modul

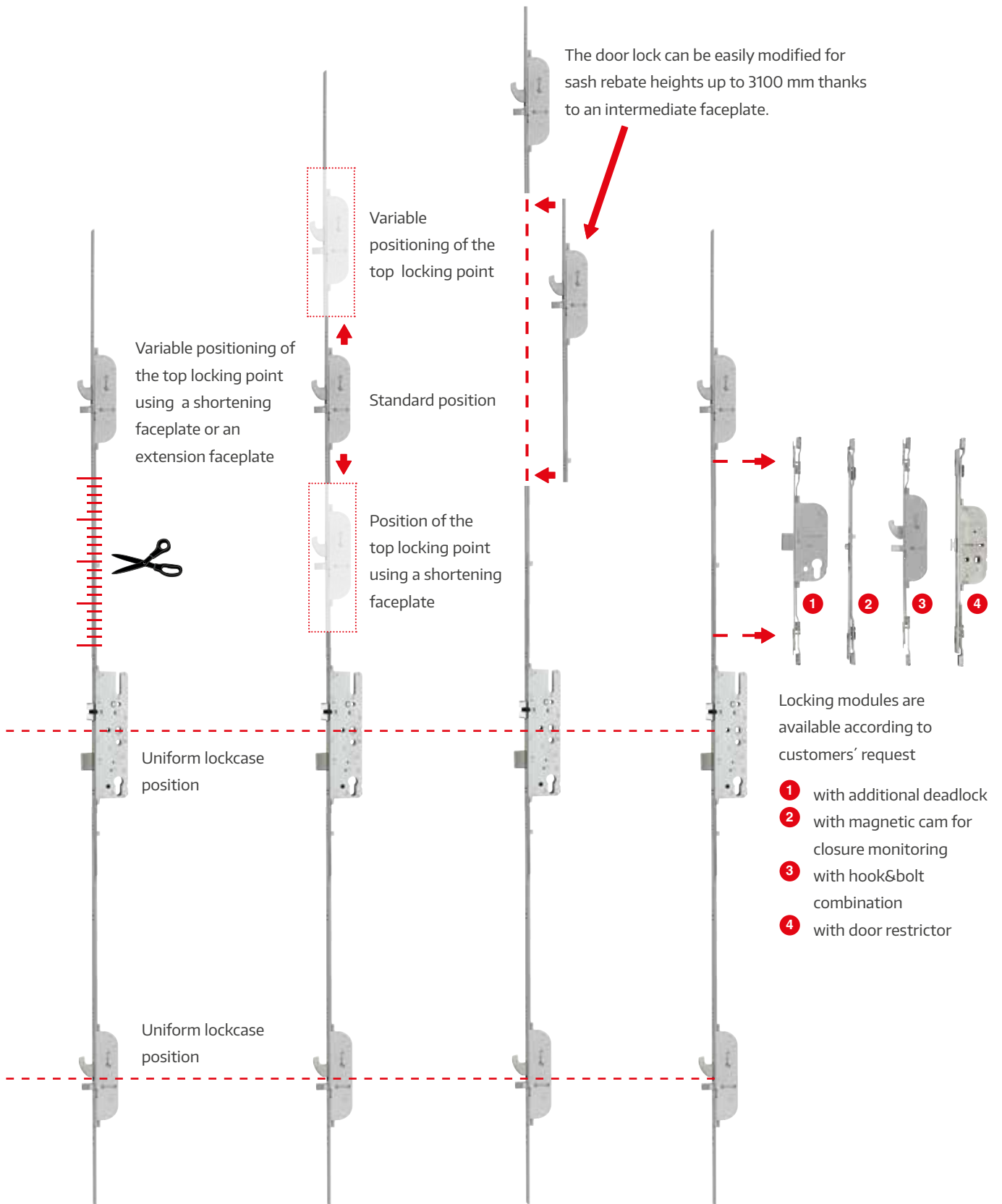

You want everything from a single source?

We provide you with complete solutions for sliding doors, windows and doors – for timber, PVC and aluminium. Experience our versatile system offer, comprehensive service included. Discover more of this on our website www.maco.eu or contact your MACO representative.

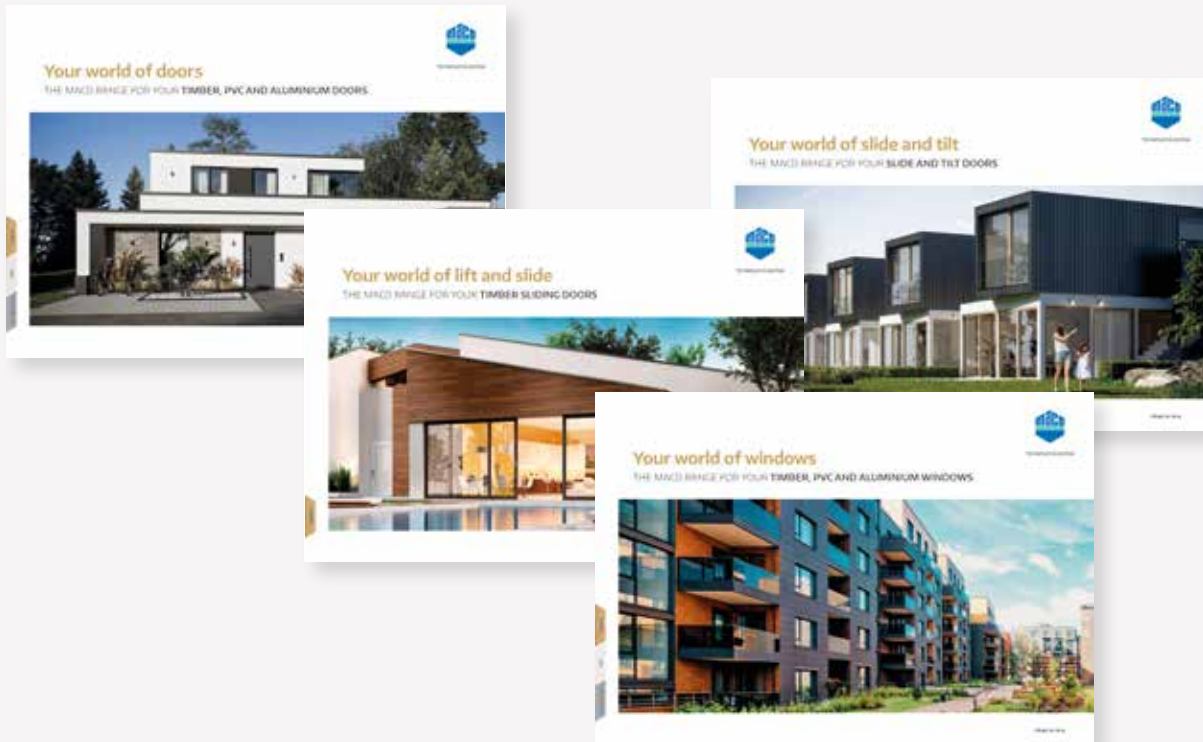

MACO near you:
www.maco.eu/contact



TECHNOLOGY IN MOTION



We regularly revise this document.
The latest version is available on <https://www.maco.eu/assets/759608>
or by scanning the QR code.

Created: 05/2012 - Created: 02.06.2022
Order No. 759608
All rights and amendments reserved.