

Move HS Comfort Drive

LIFT AND SLIDE FITTINGS/WINDOW AUTOMATION

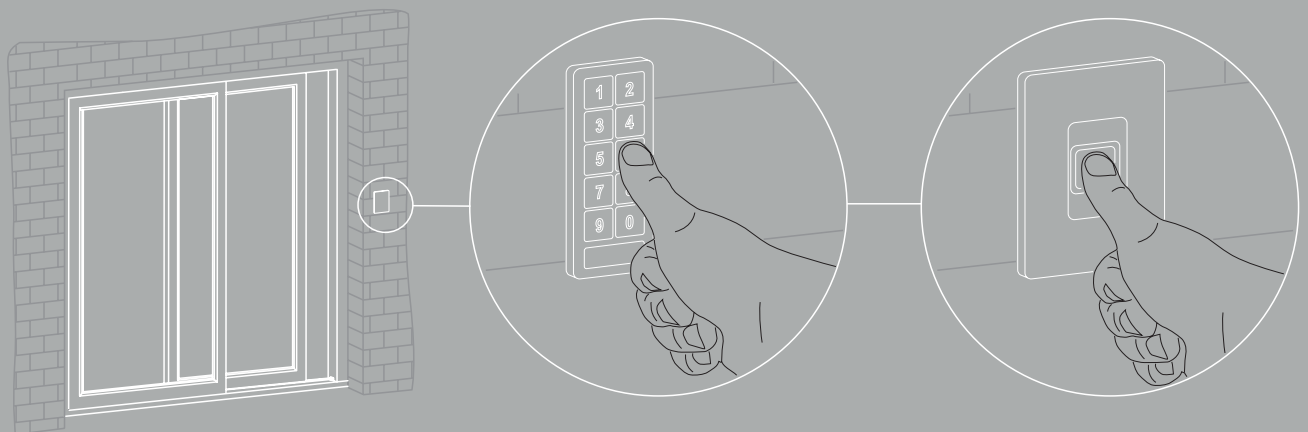

INSTALLATION INSTRUCTIONS

Outdoor operation with code keypad/fingerprint sensor,
Move HS Comfort Drive, 24 V DC
wood/wood-aluminium/PVC,
Scheme C

Used exclusively for specialist companies.

Copy of the original instructions

Contents

Important safety instructions	3
Warranty	3
Disposal	3
Other applicable documents	4
Intended use	4
Features	4
Device overview	4
Installing the code keypad/fingerprint sensor	5
Circuit diagram	6
Operation	7
Technical specifications	7



Important safety instructions

It is important to observe the following instructions to ensure safety for everyone. Incorrect installation can cause **serious injuries**.

Manufacturer's declaration/technical standard

The accessories contained in this document have been tested and manufactured in line with the applicable European directives. The applicable declaration of incorporation for the Move HS Comfort Drive is available for inspection. You may only operate the devices if there is a declaration of conformity for the overall system. The actuator meets the latest technical standards and only qualified technical staff may install, service and carry out any other tasks.

Personnel

Only a **qualified electrician** (certified to DIN VDE 1000-10, for example) may connect the system to the mains. The actuator must be installed by personnel trained to current standards and based on the recognised code of practice.

Also observe the important safety instructions in the manual for the Move HS Comfort Drive.

Warranty

HAUTAU's General Terms and Conditions of Business apply to the accessories (online: www.hautau.de/en/).

Disposal



The crossed-out wheeled bin symbol indicates that you must not dispose of this electrical appliance or electronic device in the household waste at the end of its service life.

You can return it to free collection points for old electrical appliances in your area or to other centres where they accept old appliances for recycling.

Contact your local council for addresses of collection points and centres. If the electrical appliance or electronic device contains personal data, you yourself are responsible for erasing data before you return it.

You will find more information online at www.weeeologic.com or other websites on the WEEE Directive.

Other applicable documents

This document comprises additional instructions for the following manuals:

- Installation instructions for Move HS Comfort Drive, 24 V DC, wood/wood-aluminium, concealed, Scheme A
- Installation instructions for Move HS Comfort Drive, 24 V DC, wood/wood-aluminium, concealed, Scheme C
- Installation instructions for Move HS Comfort Drive, 24 V DC, wood/wood-aluminium/PVC, surface-mounted, Scheme A
- Installation instructions for Move HS Comfort Drive, 24 V DC, wood/wood-aluminium/PVC, surface-mounted, Scheme C

The aforementioned documents apply to this manual. Excluded are the instructions that are not applicable due to the use of the code keypad/fingerprint sensor or that result in modifications to the system due to additional optional accessories. Ensure you consult the product documentation for the code keypad or fingerprint sensor being used in all cases.

Intended use

The code keypad or fingerprint sensor must be fitted by a professional to the wall on the outer side of the (lift and) slide system and as near to the circuit board as possible (in the case of Scheme C: the fixed sash circuit board). It must be connected to the circuit board for the Move HS Comfort Drive concerned as per the circuit diagram. Manual operation using fingers is only permitted to open/close the sliding sash(es).

Features

You will find the product features for the control keypad in the relevant product documentation.

Device overview

Example images; the device's appearance and functions may vary.

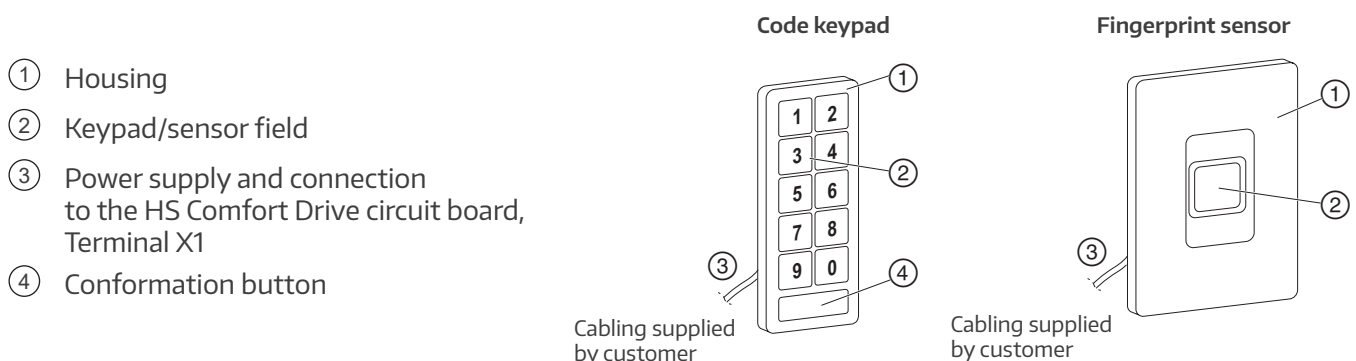

Installing the code keypad/fingerprint sensor

Image gives rough example of installation: installation should be adapted to the actual conditions on site. You will find specific installation information in the corresponding product documentation.

Where necessary, the customer must provide a recess to fit the control keypad and space to feed the cabling to the Move HS Comfort Drive circuit board.

The installation location must be dry and easy to access. The connecting cable should be routed through an empty conduit.

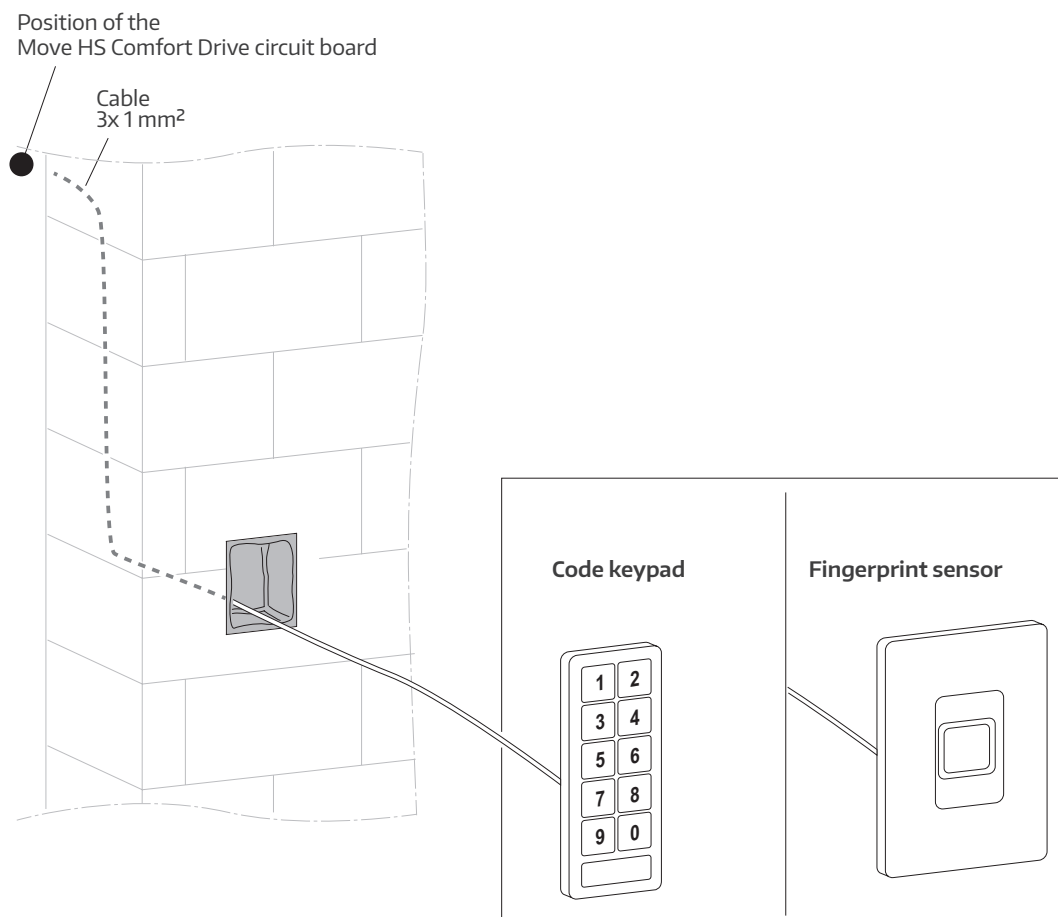

Circuit diagram



WARNING
Disconnect the power supply to the actuator while carrying out connection work.
If you do not, this poses a life-threatening hazard due to electric shock.

In the case of Scheme C, the control keypad is connected to the fixed sash circuit board.

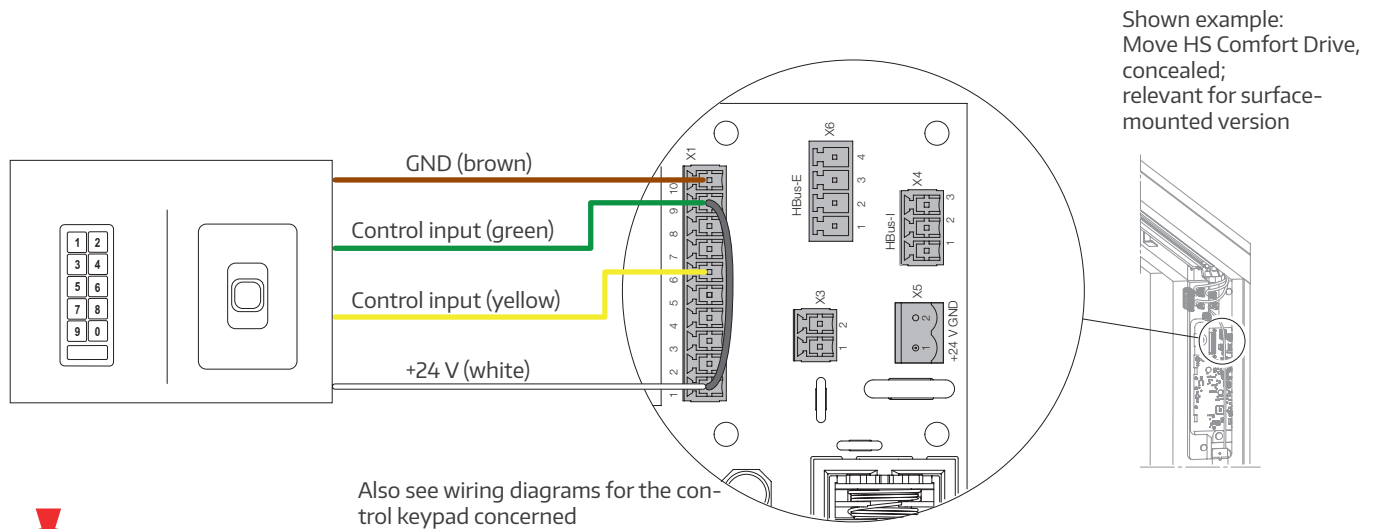

IMPORTANT NOTE:
In the case of potential-free control keypads, the jumper must be removed as specified in the corresponding documentation; otherwise, the required function is not guaranteed.

Example:

Jumper setting and connection for fingerprint sensor **dLine fingerprint** (450007) by ekey

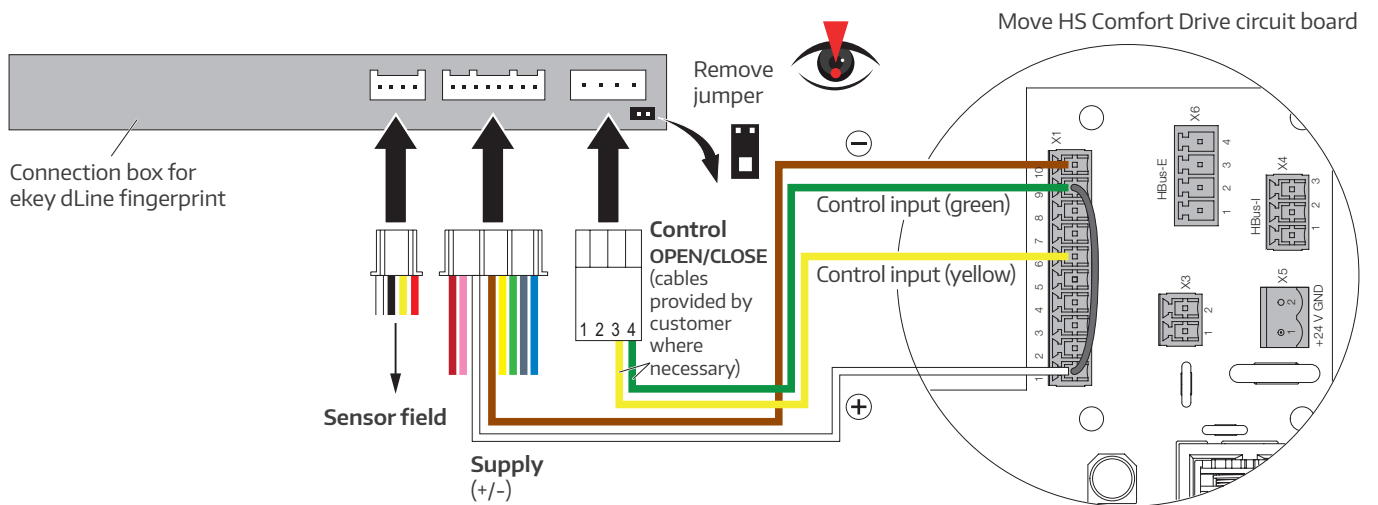

You will find more information in the relevant product documentation.

Operation

Operation using the fingerprint sensor is only possible after the sensor field has been calibrated (see relevant product documentation).

The control keypad remembers the sash's last movement. Randomly activating the control keypad in quick succession will mean the commands are ignored to protect the actuator system.

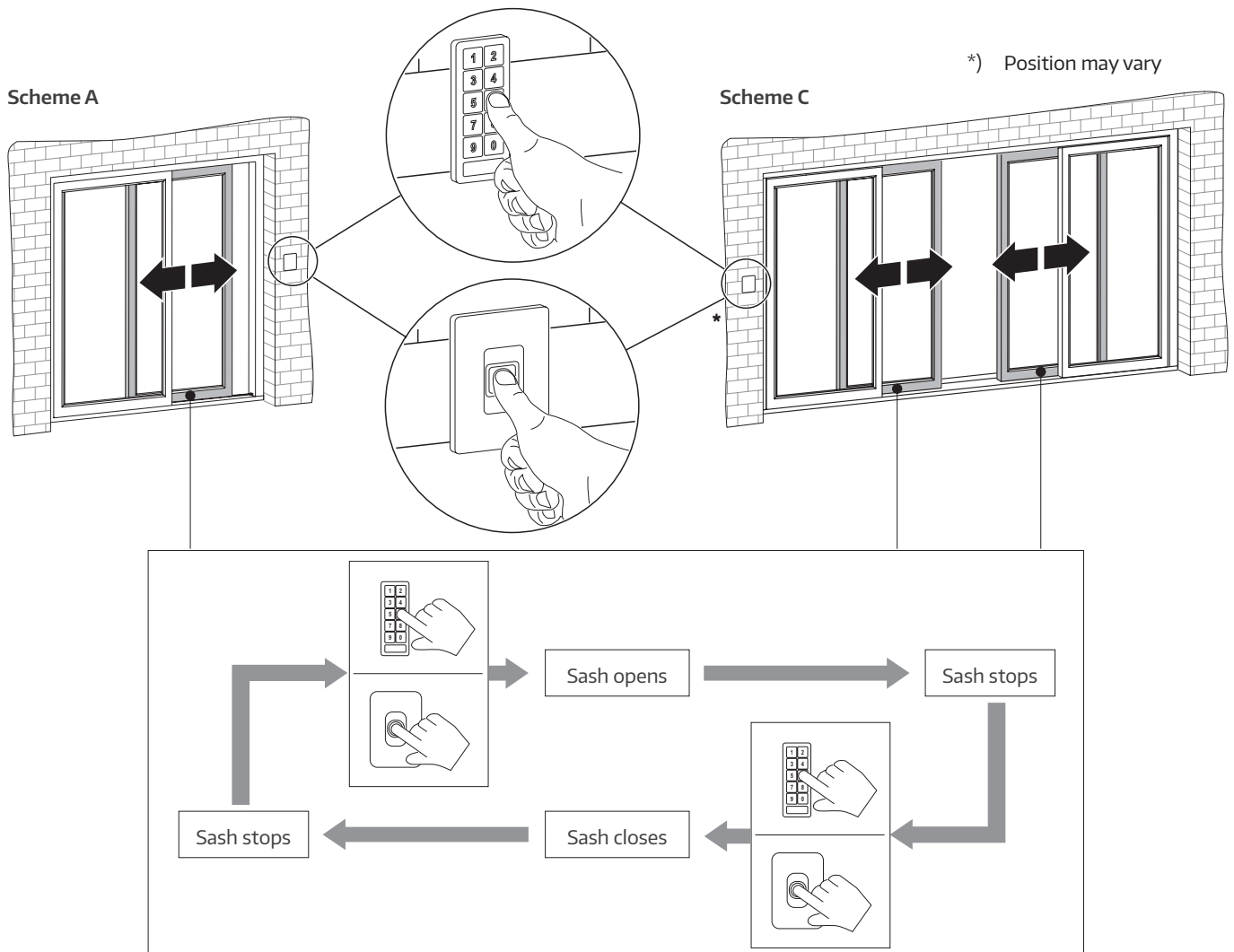

IMPORTANT NOTE:

A factory reset and software reset of the Move HS Comfort Drive are **not** possible with a code keypad/fingerprint sensor. A reset can **only** be performed with the standard control keypad or a control button/button box.

Technical specifications

You will find the technical data for the control keypad in the relevant product documentation.

HAUTAU GmbH

Wilhelm-Hautau-Strasse 2

31691 Helpsen

Germany

Tel.: +49 5724 3930

Email: info@hautau.de

www.hautau.de/en/



This printed document is continually updated.
You will find the latest version at <https://www.maco.eu/assets/759971>
or scan the QR code.

Created: 08/2023 – amended: 01/2025
Order no. 759971A
All rights reserved. Subject to change.