

Move HS Comfort Drive

LIFT AND SLIDE FITTINGS/WINDOW AUTOMATION

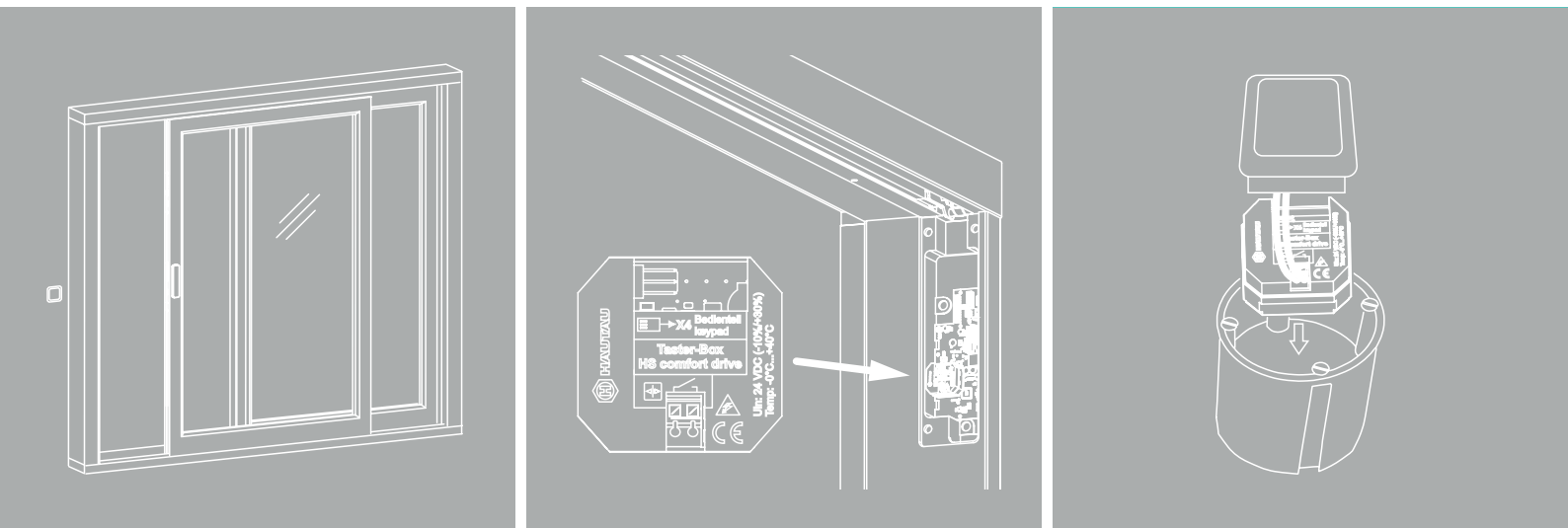

INSTALLATION INSTRUCTIONS

Indoor operation with control button,
Move HS Comfort Drive, 24 V DC
wood/wood-aluminium/PVC,
Scheme A/C

Used exclusively for specialist companies.

Copy of the original instructions

Contents

Important safety instructions	3
Warranty	3
Disposal	3
Other applicable documents	4
Explanation of terms	4
Intended use	4
Features	4
Device overview	5
Installing the button box	5
Circuit diagram	6
Operation	7
In the case of initial operation with control button (Full Init = factory reset)	8
Normal mode	9
Calibration run (Home Init = software reset)	10
Activating Full Init and Home Init	11
Feedback signals	11
Technical specifications	12



Important safety instructions

It is important to observe the following instructions to ensure safety for everyone. Incorrect installation can cause **serious injuries**.

Manufacturer's declaration/technical standard

The accessories contained in this document have been tested and manufactured in line with the applicable European directives. The applicable declaration of incorporation for the Move HS Comfort Drive is available for inspection. You may only operate the devices if there is a declaration of conformity for the overall system. The actuator meets the latest technical standards and only qualified technical staff may install, service and carry out any other tasks.

Personnel

Only a **qualified electrician** (certified to DIN VDE 1000-10, for example) may connect the system to the mains. The actuator must be installed by personnel trained to current standards and based on the recognised code of practice.

Also observe the important safety instructions in the manual for the Move HS Comfort Drive.

Warranty

HAUTAU's General Terms and Conditions of Business apply to the accessories (online: www.hautau.de/en/).

Disposal



The crossed-out wheeled bin symbol indicates that you must not dispose of this electrical appliance or electronic device in the household waste at the end of its service life.

You can return it to free collection points for old electrical appliances in your area or to other centres where they accept old appliances for recycling.

Contact your local council for addresses of collection points and centres. If the electrical appliance or electronic device contains personal data, you yourself are responsible for erasing data before you return it.

You will find more information online at www.weeeologic.com or other websites on the WEEE Directive.

Other applicable documents

This document comprises additional instructions for the following manuals:

- Installation instructions for Move HS Comfort Drive, 24 V DC, wood/wood-aluminium, concealed, Scheme A
- Installation instructions for Move HS Comfort Drive, 24 V DC, wood/wood-aluminium, concealed, Scheme C
- Installation instructions for Move HS Comfort Drive, 24 V DC, wood/wood-aluminium/PVC, surface-mounted, Scheme A
- Installation instructions for Move HS Comfort Drive, 24 V DC, wood/wood-aluminium/PVC, surface-mounted, Scheme C

The aforementioned documents apply to this manual. Excluded are the instructions that apply to the control keypad. These are replaced by the procedures described in the present manual regarding the control button.

Explanation of terms

This manual describes a left-hand version (a sash opening to the right) as an example. Any specifications for a right-hand configuration (a sash opening to the left) and for Schema C must be adapted accordingly.

Measurements in mm. Diagrams without a scale are **not** necessarily to scale.



IMPORTANT NOTE:
No hole must be drilled into the control keypad if no control keypad is needed.

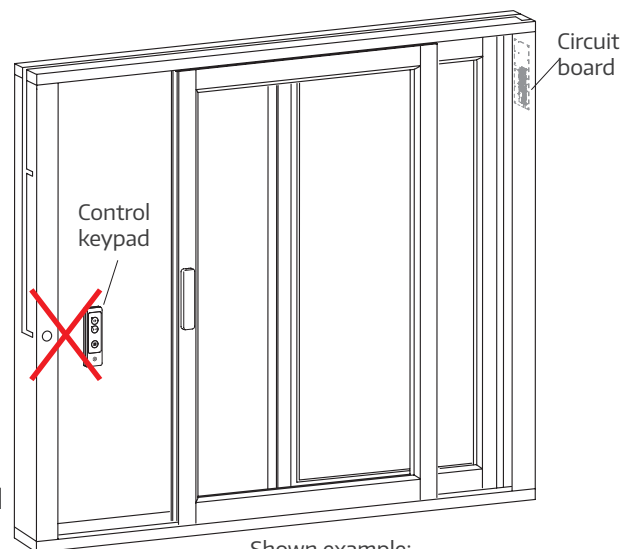

Shown example:
Move HS Comfort Drive, concealed;
relevant for surface-mounted version

Intended use

If you wish to use a single control button, the button box must be connected to the circuit board for the Move HS Comfort Drive (lift and) slide system concerned as per the circuit diagram. It is not permitted to use it in any other way.

Features

- › For installation in a deep flush box or next to the circuit board on the Move HS Comfort Drive
- › The Move HS Comfort Drive control electronics automatically detect whether a 3-button keypad or a button box with a control button is connected
- › Power is supplied via the HAUTAU bus
- › For operation using just one button for OPEN, STOP and CLOSE
- › A buzzer on the circuit board is used to signal errors and statuses

Device overview

- ① Power supply and connection to the HS Comfort Drive circuit board, Terminal X4
- ② Connection for buttons
- ③ Buzzer for feedback signals (in the housing)
- ④ Connection cable (length: 10 m)

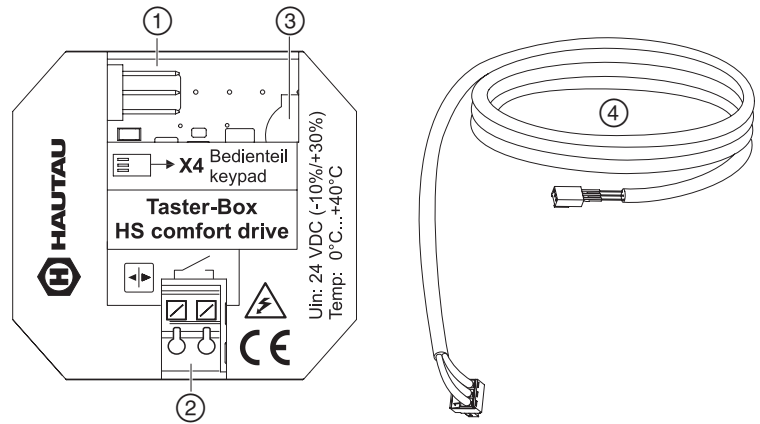

Installing the button box



WARNING
 Disconnect the power supply to the actuator while carrying out connection work. Failure to do so could result in loss of life due to electric shock.

The button box is designed for installation in a deep flush-mounted box provided by the customer. The installation location must be dry and easy to access. It is recommended to fit an inspection flap or similar. There is no need to fasten the button box in the flush-mounted box. A flush-mounted electronics box is recommended for an extended terminal box.

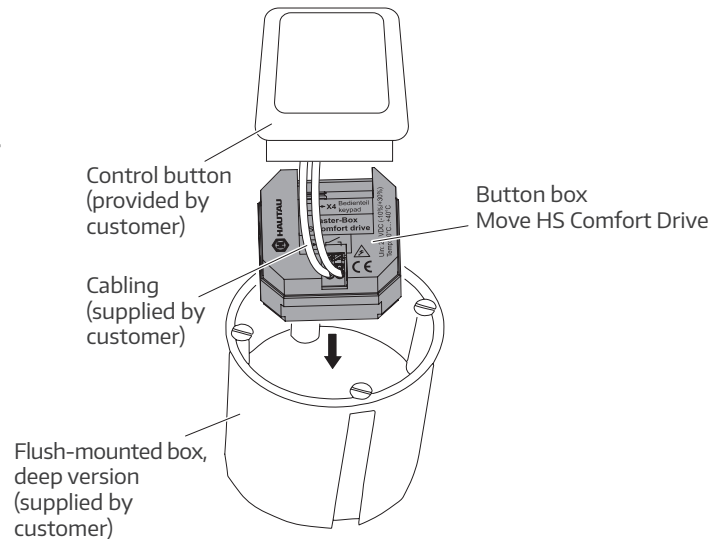

Alternative:

Installation in the frame next to the circuit board on the Move HS Comfort Drive

Shown example:
 Move HS Comfort Drive, concealed;
 relevant for surface-mounted version

Move HS Comfort Drive button box in the lower section of the circuit board cut-out

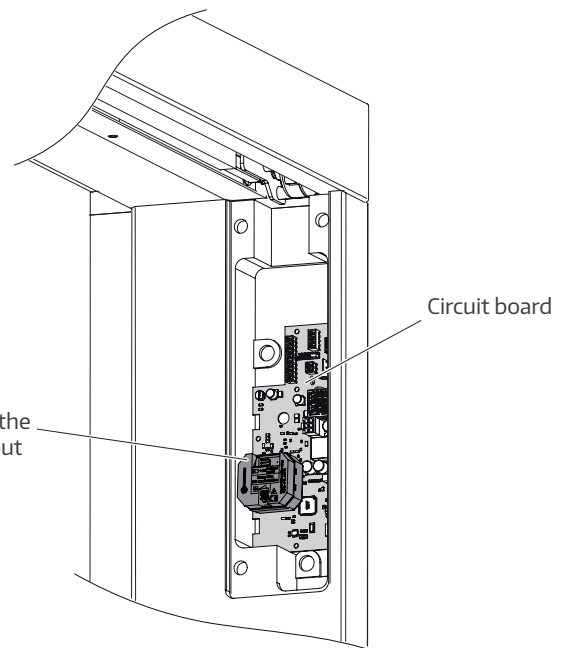

There is no need for a new calibration run (Home Init) after installation.

Circuit diagram

Scheme A

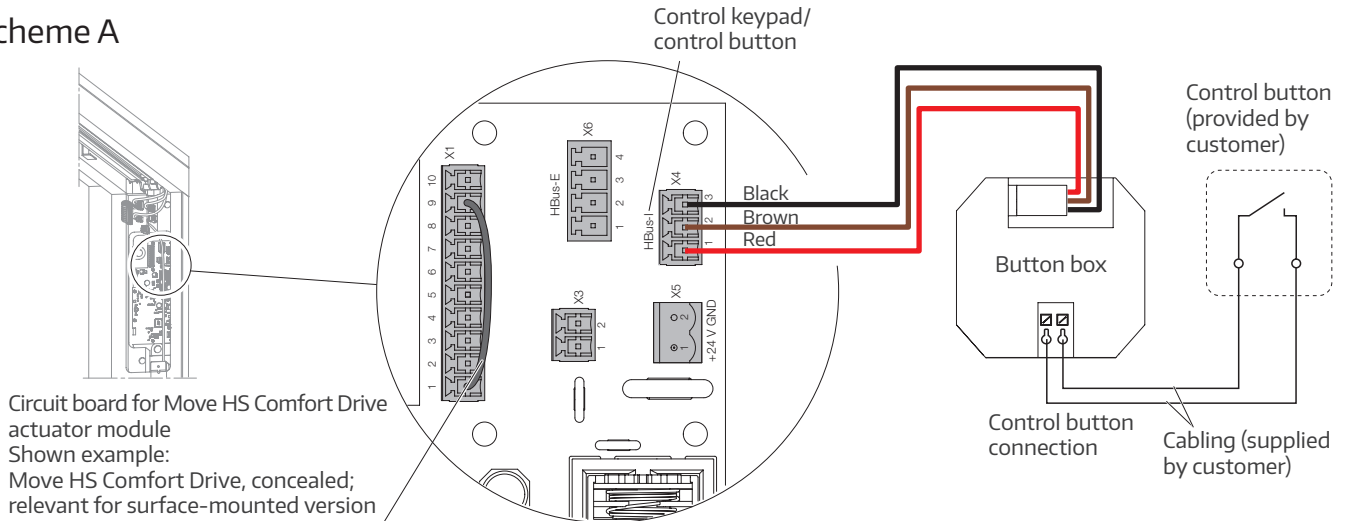

In certain cases, Bridge 1-9 must be removed
(see manual for Scheme A).

Scheme C

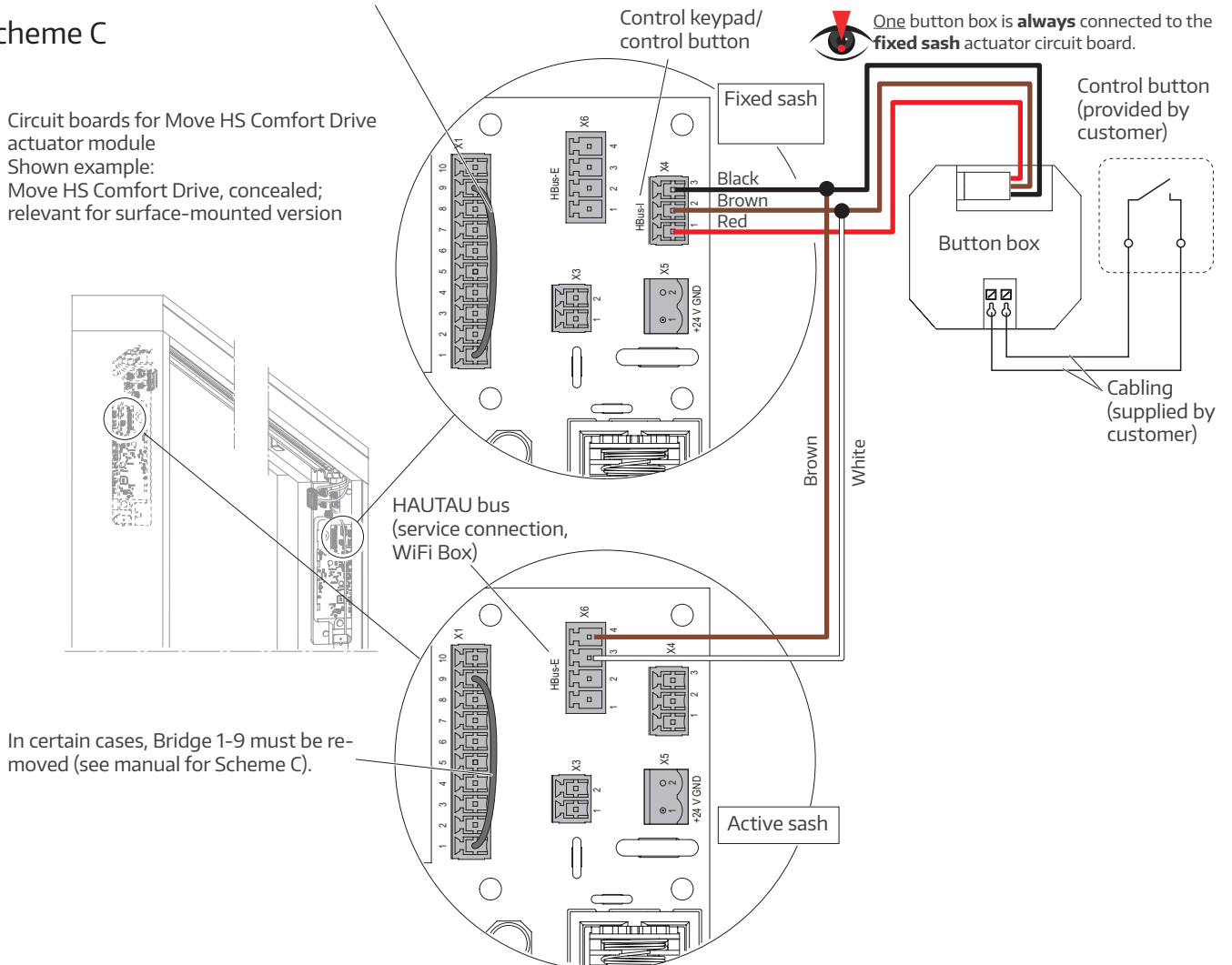

In certain cases, Bridge 1-9 must be re-
moved (see manual for Scheme C).

Operation

The control keypad remembers the sash's last movement. Randomly pressing the button in quick succession will mean the commands are ignored to protect the actuator system.

HS/S Comfort Drive in automatic mode: pressing the button continuously for about 20 seconds will reset the software (Home Init) while pressing the button continuously for about 30 seconds will reset to factory settings (Full Init).

HS/S Comfort Drive in dead man mode: a double-click is required here to enter the special mode. Only then will pressing the button continuously for about 20 seconds reset the software (Home Init) while pressing the button continuously for 30 seconds will reset to factory settings (Full Init). To exit the special mode, the operator must press the control button twice again or wait for about 1 minute.

An audible signal will confirm the software reset and the factory reset.

Access after initial operation
(Full Init) or calibration run (Home Init)

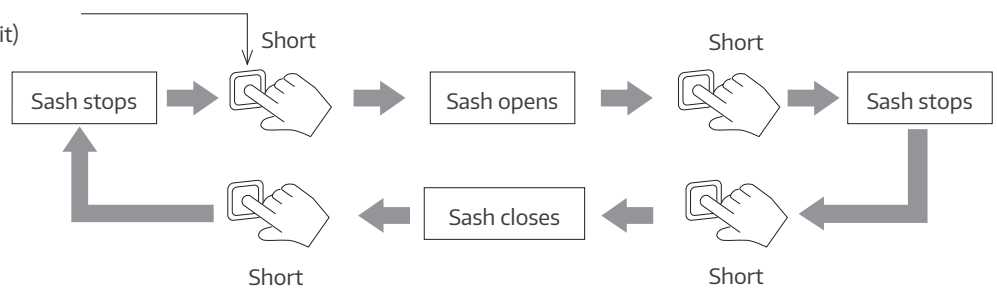

In the case of initial operation with control button (Full Init = factory reset)

Complete, automatic initialisation*

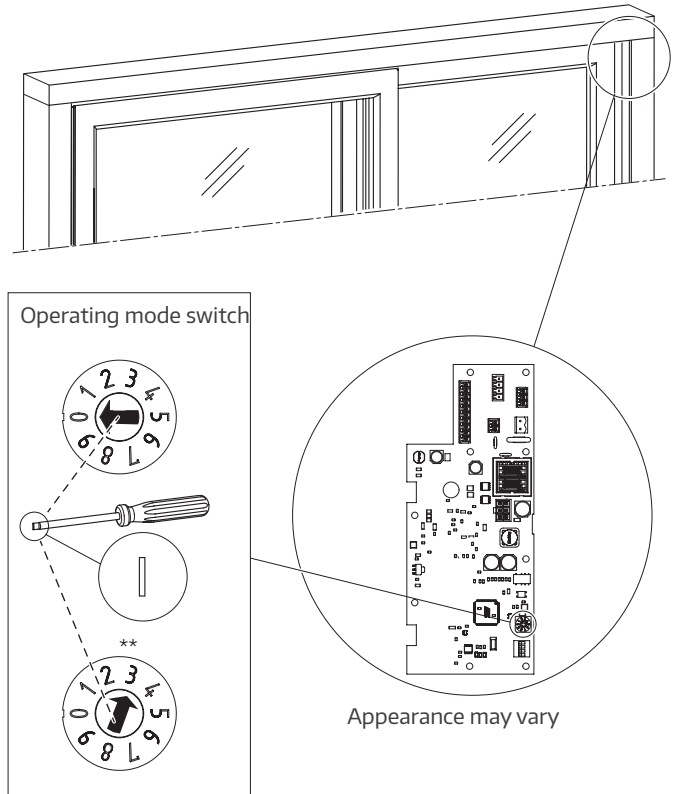
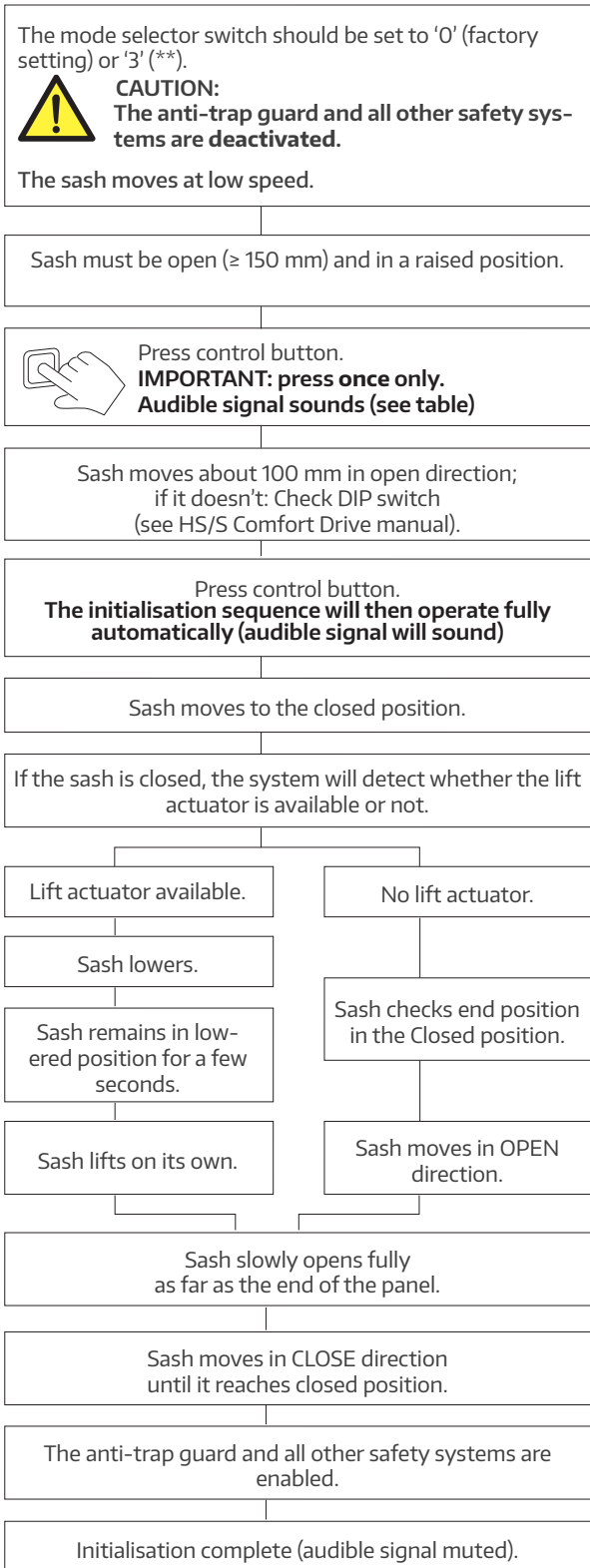

*) You can use the control button to interrupt the process at any time

***) Reduced stop range of 10 mm instead of 130 mm before mech. end position

Normal mode



NOTE:
In automatic mode, the sash will stop about 120 mm* before the mechanical end position when opening.

*) Default setting for operating mode switch on delivery ('0')

In the HAUTAU/MACO version:
If the operating mode switch is set to '3', the sash stops about 10 mm before the mechanical end position.



WARNING:
This setting poses a risk of fingers being crushed in the central stile section. The operator must implement measures to prevent this.

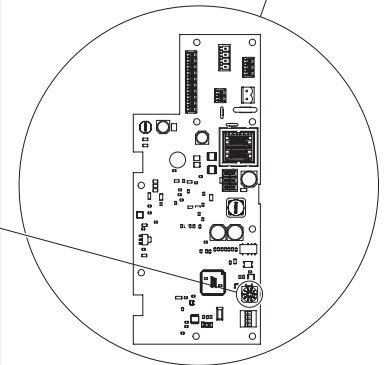
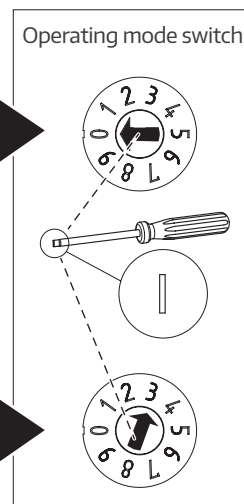
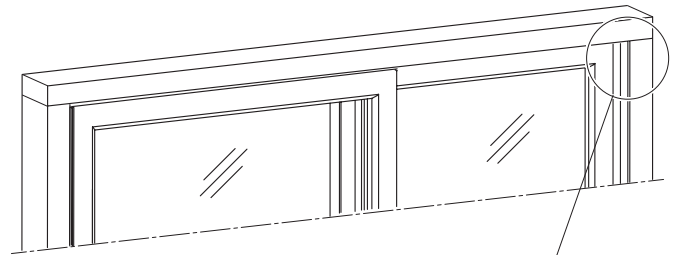

Appearance may vary

Partial initialisation, e.g. after a power failure



NOTE:
The anti-trap guard and all other safety systems are enabled.

The sash moves at a normal speed.

Panel is ready for operation.

Power failure
-> see Home Init



Press control button.

Sash closes at 'normal' speed.

Sash closed.

With lift actuator: Sash lowers and locks.

Sash is ready for operation.

A factory reset (Full Init) with complete initialisation must be performed after adjusting the operating mode switch.

Calibration run (Home Init = software reset)

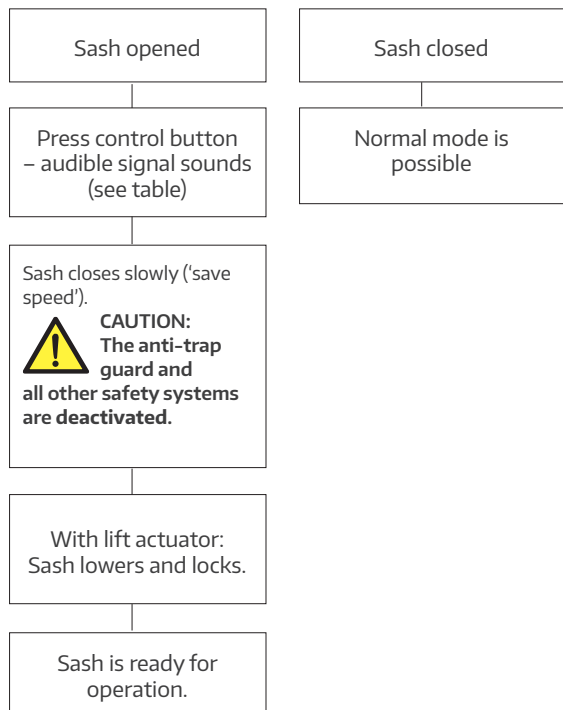







Activating Full Init and Home Init

Mode	Type of initialisation	Action	Feedback signal
Automatic mode (DIP switch 4 at ON)	Software reset (Home Init)	Press button for about 20 sec.	Audible signal (see below)
	Factory reset (Full Init)	Press button for about 30 sec.	
Dead man mode (DIP switch 4 to OFF)	Software reset (Home Init)	Double-click + press button for about 20 sec.	
	Factory reset (Full Init)	Double-click + press button for about 30 sec.	
	End initialisation	Wait about 1 min. or double-click again	-

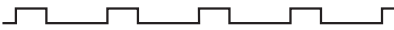
Feedback signals

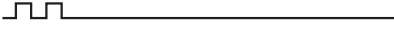
The buzzer signalling errors and statuses cannot be switched off. As a result, it is only activated when absolutely necessary to alert the actuator system user/operator.
 The buzzer is not intended to indicate different causes of error, which only service personnel can eliminate. The buzzer is meant to assist the user/operator.

Event	Audible signal sequence	Activation and duration
For all errors which cause a safety stop for the HS/S Comfort Drive		Only if button is pressed
During opening/closing in the course of initialisation  CAUTION: All safety systems are deactivated during initialisation.		Until initialisation is complete
Audible confirmation signal for software reset (Home Init) after about 20 seconds. The control button must be pressed for at least 20 seconds for a software reset.		One-time
Audible confirmation signal for factory reset (Full Init) after about 30 seconds. The control button must be pressed for at least 30 seconds for a factory reset.		One-time
After double-click on control button (triggering a reset in DEAD MAN mode).		1 minute or until a button is next pressed

Technical specifications

Operational power supply	
Supply voltage	24 V DC (–10%/+30%)
Ripple	≤ 20% in relation to the nominal voltage
Current draw	max. about 14 mA Standby about 4 mA
Wattage	max. about 0.4 W Standby about 100 mW
Material and mechanical properties	
Dimensions: w x h x d (mm)	50 x 47 x 28
Plastic housing	
Colour	Grey
Halogen-free	Yes
Silicone-free	Yes
RoHS-compliant	Yes
Audible feedback signal	
for errors and statuses	Yes, audible signal sequences
HAUTAU bus	
Cable length	Max. 10 m
Cable cross-section	≥ 0.8 mm ²
Cable type	not shielded
Number of actuators	1 per button box
Installation and environmental conditions	
Nominal temperature	20 °C
Ambient temperature range	0 °C to +40 °C
Installation conditions	Dry
Suitable for outdoor installation	No
Protection rating	IP20 (as per EN 60529)
Approvals and certificates	
CE-compliant	Yes, with EMC Directive 2004/108/EC and Low Voltage Directive 2006/95/EC
RoHS-compliant	Yes, with Directive 2011/65/EC
Protection class	Class III
Connection option	Any 1-pole button with normally open contact for flush/surface mount on wall
Use for Move HS Comfort Drive	software version 5.0 and higher for the main actuator circuit board

HAUTAU GmbH

Wilhelm-Hautau-Strasse 2

31691 Helpsen

Germany

Tel.: +49 5724 3930

Email: info@hautau.de

www.hautau.de/en/



This printed document is continually updated.
You will find the latest version at <https://www.maco.eu/assets/759973>
or scan the QR code.

Created: 08/2023 – amended: 01/2025
Order no. 759973A
All rights reserved. Subject to change.